

SHIMANO

1987 REPAIR MANUAL

Shimano American Corporation, One Shimano Dr.
Irvine, CA 92718

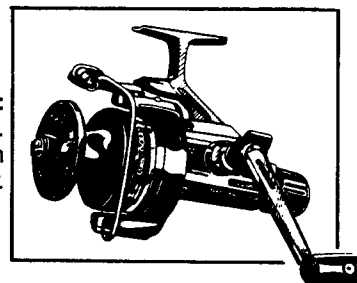
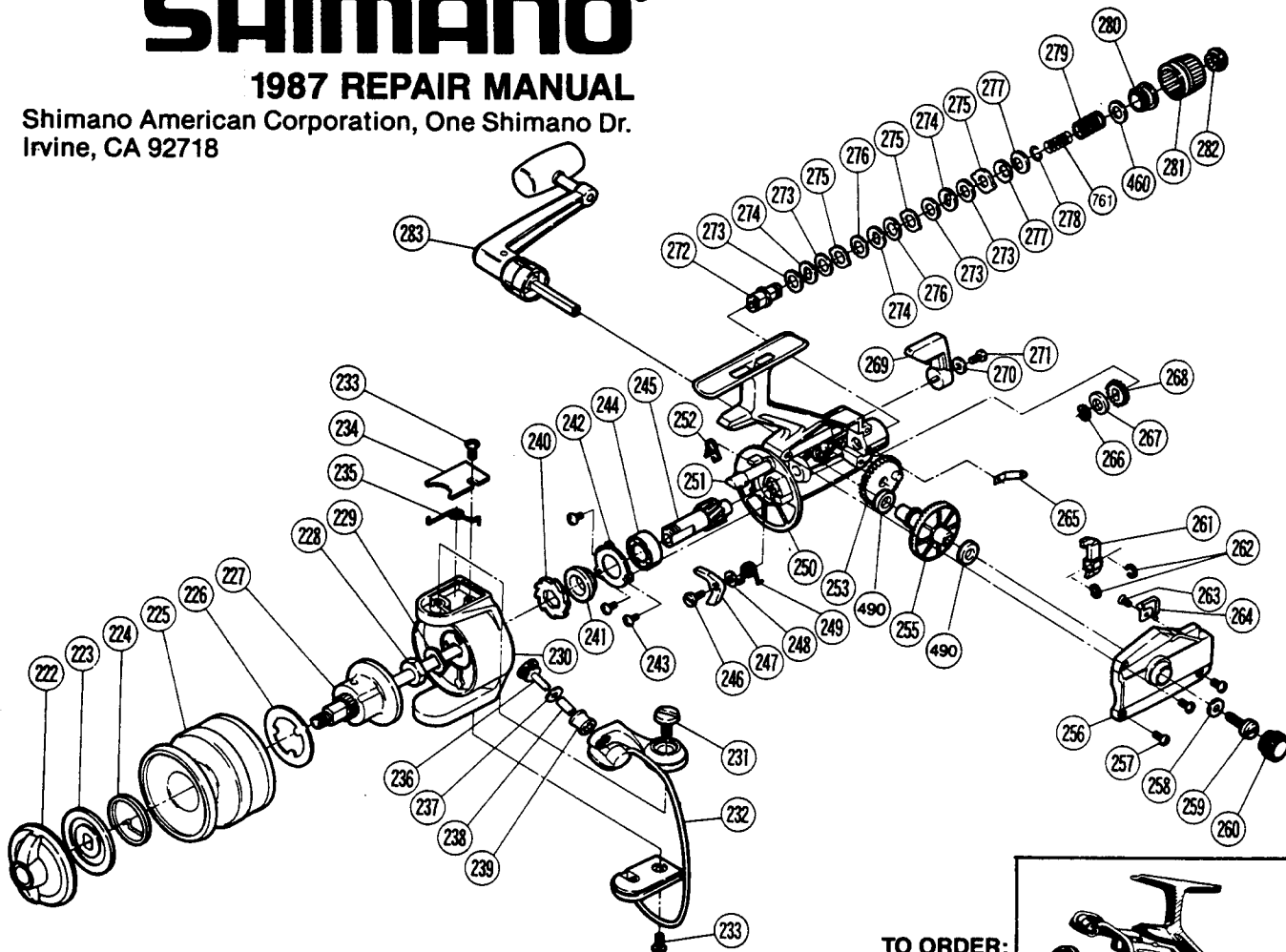

TO ORDER:

This reel belongs to the "Rear Drag" series.
Please order parts using the abbreviation
"RD" and the part number.

EXPLODED PARTS VIEW CUSTOM 6000

PARTS LIST

PART# DESCRIPTION

- 222. Spool Drag Knob
- 223. Spool Drag Disc
- 224. Click Spring
- 225. Spool
- 226. Base Drag Washer
- 227. Spool Shaft
- 228. Rotor Nut
- 229. Rotor Lock
- 230. Rotor
- 231. Bail Mount Screw
- 232. Bail Wire
- 233. Multi Purpose Screw
- 234. Bail Spring Cover
- 235. Bail Spring
- 236. Line Guide Screw
- 237. Line Guide Cover
- 238. Line Guide Bushing
- 239. Roller Line Guide
- 240. Anti Reverse Ratchet
- 241. Ratchet Spacer
- 242. Bearing Lock
- 243. Bearing Lock Screw

PART# DESCRIPTION

- 244. Ball Bearing
- 245. Pinion Gear
- 246. Anti Reverse Dog Screw
- 247. Anti Reverse Dog
- 248. Anti Reverse Dog Spacer
- 249. Anti Reverse Dog Spring
- 250. Housing
- 251. Anti Reverse Shaft
- 252. Anti Reverse Shaft Spring
- 253. Oscillation Gear
- 255. Drive Gear
- 256. Side Plate
- 257. Side Plate Screw
- 258. Handle Screw Lock Washer
- 259. Handle Screw
- 260. Dust Cap
- 261. Oscillation Guide
- 262. "C" Lock
- 263. Click Spring Screw
- 264. Click Spring
- 265. Detent Spring
- 266. Drag "C" Lock

PART# DESCRIPTION

- 267. Spacer
- 268. Drag Ratchet Wheel
- 269. Anti Reverse Lever
- 270. Lever Screw Lock Washer
- 271. Anti Reverse Lever Screw
- 272. Stern Drag Shaft
- 273. Drag "C" Washer
- 274. "D" Washer
- 275. Keyed Washer
- 276. Drag Washer D
- 277. Coned Disc Spring
- 278. Drag "C" Lock
- 279. Stern Drag Spring
- 280. Spring Housing
- 281. Stern Drag Knob
- 282. Drag Knob Screw
- 283. Handle
- 460. "E" Washer
- 490. Drive Gear Bushing
- 761. Lock Spring (orig. 459A)