

Numbers shown on this
 and parts list are available to
 To order a part contact the
Fishing Reel Service Dept.
 telephone number shown.
 If you require a part that does
 not have an item number or part
 number assigned to it, please send
 the reel to the address listed.

Address:
Fishing Reel Service Dept.
 18th Street
 Spirit Lake, Iowa 51360
 Phone: 508-3474

Available on the web:
purefishing.com

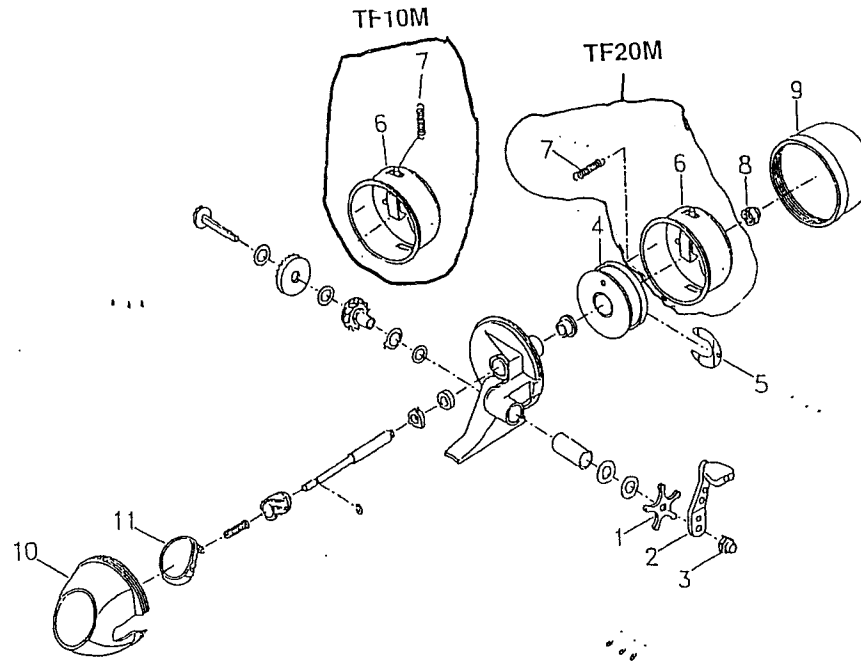

JOHNSON

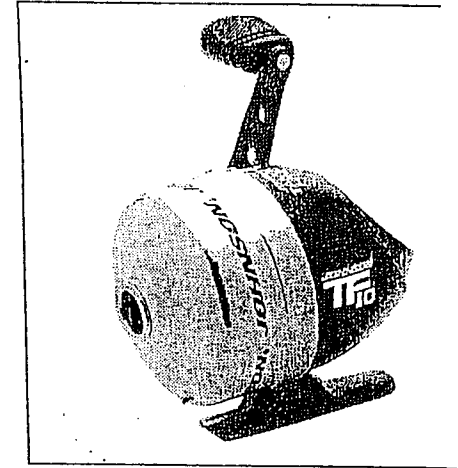

**JOHNSON
 TANGLE
 FREE**

Warranty:
 Johnson warrants to the original purchaser that its
 fishing reels are free from defects in materials or
 workmanship for a period of one year from the date of
 purchase. The reel must be returned postage prepaid
 with proof of purchase to: Pure Fishing Reel
 Service Department, 1900 18th Street, Spirit Lake,
 Iowa 51360. If inspection reveals defective material or
 workmanship, we shall at our option either repair or
 replace it without charge. We are not responsible for
 normal wear or tear or for defects caused by accident,
 misuse, alterations, misuse or improper care. Warranty
 does not apply to reels used commercially. THERE
 ARE NO OTHER EXPRESS WARRANTIES BEYOND
 THE TERMS OF THIS LIMITED WARRANTY. IN NO
 EVENT SHALL ANY IMPLIED WARRANTIES, INCLUDING
 MERCHANTABILITY AND FITNESS FOR A PARTICULAR
 PURPOSE, EXTEND BEYOND THE DURATION OF THE
 EXPRESS WARRANTY CONTAINED HEREIN. IN NO
 EVENT SHALL PURE FISHING BE LIABLE FOR
 INCIDENTAL OR CONSEQUENTIAL DAMAGES. Some
 states do not allow limitations on how long an
 implied warranty lasts or the exclusion or limitation
 of incidental or consequential damages, so the
 above limitations or exclusions may not apply to you.

| No. | Part Name | TF10M | TF20M |
|-----|-----------------------|---------|---------|
| 1 | Star Drag | 1066550 | 1066550 |
| 2 | Crank Arm Ass'y | 1066475 | 1066474 |
| 3 | Crank Nut | 1066551 | 1066551 |
| 4 | Spool | 1066552 | 1066477 |
| 5 | Spool Clip | 1066553 | 1066479 |
| 6 | Pick-Up Housing Ass'y | 1066498 | 1066497 |
| 7 | Pick-Up Spring | 1066516 | 1066515 |
| 8 | Pick-Up Housing Nut | 1066519 | 1066518 |
| 9 | Front Cover | 1071001 | 1071003 |
| 10 | Rear Cover | 1066527 | 1066526 |
| 11 | Thumb Button | 1066530 | 1066529 |

| Model | TF10M | TF20M |
|-------------|---------------|---------------|
| Bearings | 1 | 1 |
| Gear Ratio | 3.4:1 | 3.4:1 |
| Line Cap. | 10 lb./65 yd. | 15 lb./85 yd. |
| | 0.24mm/75 M | 0.30mm/100 |
| Reel Weight | 7.7 Oz. | 10.8 Oz. |
| | 220 Grams | 310 Grams |