

# SHIMANO

## 1987 REPAIR MANUAL

Shimano American Corporation, One Shimano Dr.  
Irvine, CA 92718

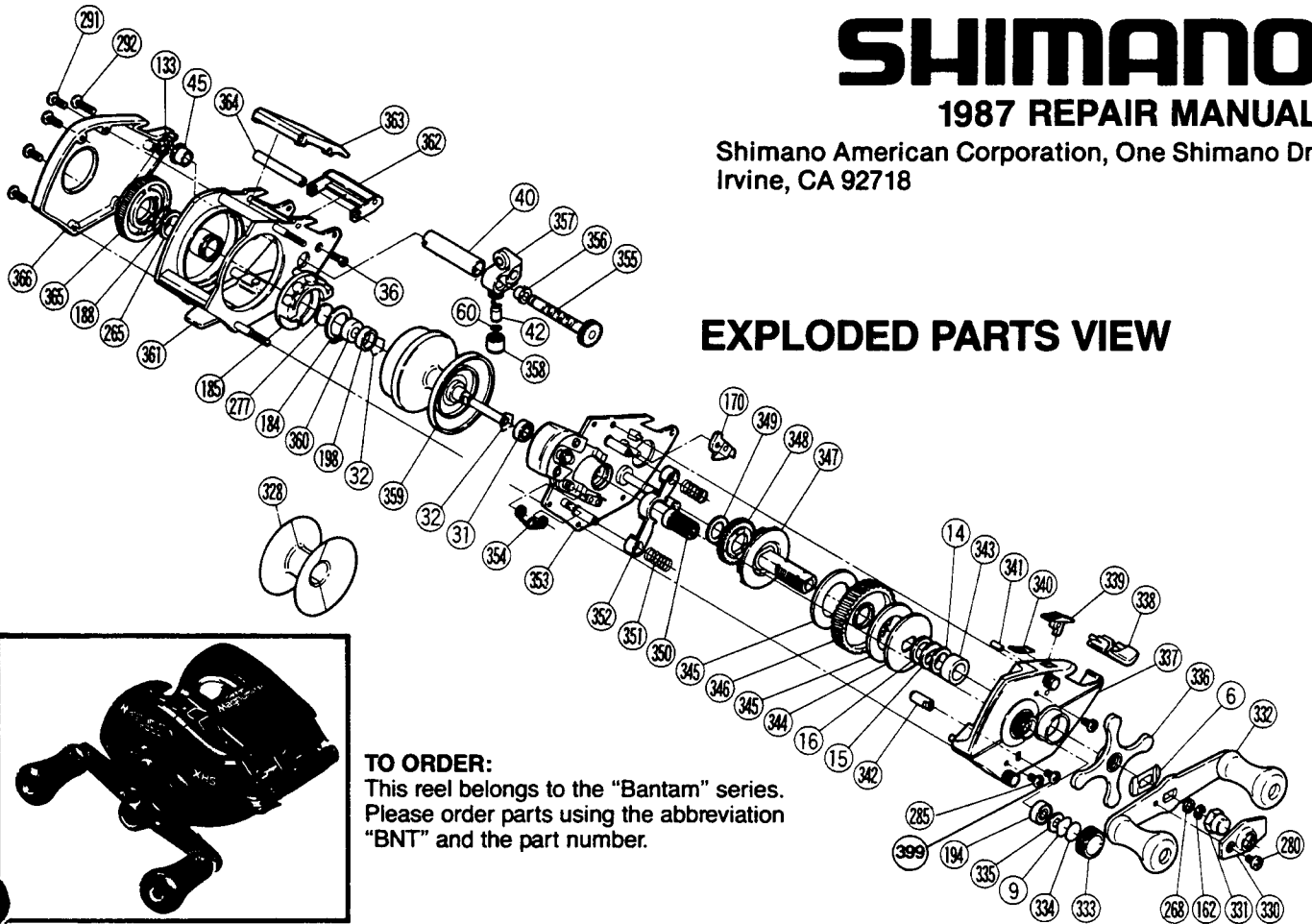

### EXPLODED PARTS VIEW

**TO ORDER:**  
This reel belongs to the "Bantam" series.  
Please order parts using the abbreviation  
"BNT" and the part number.

# BANTAM<sup>®</sup> MAGNUMLITE<sup>®</sup> 2000GT

## PARTS LIST

### PART# DESCRIPTION

- 6. Friction Washer
- 9. Cast Control Spacer
- 14. Drag Spring Washer
- 15. "D" Washer
- 16. Drag Spacer
- 31. Spool Shaft Bearing
- 32. Bearing Lock
- 36. Right Stabilizer Bar Screw
- 40. Level Wind Guard
- 42. Level Wind Pawl
- 45. Level Wind Bearing Left
- 60. Pawl Shim (optional)
- 133. Level Wind Gear Lock
- 162. "C" Lock
- 170. Anti Reverse Dog
- 184. Magnet Retainer Lock
- 185. Magnet Retainer
- 198. O Ring
- 34. Spool Shaft Bearing
- 198. Bearing Spacer
- 265. Thrust Washer
- 268. Drive Shaft Shim

### PART# DESCRIPTION

- 277. Left Bearing Spacer
- 280. Handle Nut Lock Screw
- 285. Right Side Plate Screw
- 291. Left Side Plate Screw
- 292. Left Stabilizer Bar Screw
- 328. V Converter
- 330. Handle Nut Lock Plate
- 331. Handle Nut
- 332. Handle
- 333. Cast Control Cap
- 334. Right Bearing Spacer
- 335. Oil Retainer
- 336. Star Drag
- 337. Right Side Plate
- 338. Right Side Plate Cover
- 339. Anti Reverse Switch
- 340. Switch Spring
- 341. Switch Spring Lock
- 342. Retractor Guide
- 343. Drive Shaft Bearing
- 344. Pressure Plate
- 345. Drag Washer

### PART# DESCRIPTION

- 346. Drive Gear
- 347. Drive Shaft
- 348. Level Wind Drive Gear
- 349. Set Plate Washer
- 350. Pinion Gear
- 351. Pinion Yoke Spring
- 352. Pinion Yoke
- 353. Set Plate
- 354. Retractor Spring
- 355. Level Wind Gear
- 356. Level Wind Bearing (Right)
- 357. Line Guide
- 358. Pawl Cap
- 359. Spool
- 360. Spool Shaft Bushing
- 361. Frame
- 362. Level Wind Protector
- 363. Thumb Rest
- 364. Stabilizer Bar
- 365. Magnetic Control Dial
- 366. Left Side Plate
- 399. Large Head Retractor Guide Screw