

SHIMANO®

1987 REPAIR MANUAL

Shimano American Corporation, One Shimano Dr.
Irvine, CA 92718

TO ORDER:

This reel belongs to the "Rear Drag" series.
Please order parts using the abbreviation
"RD" and the part number.

※ Please look here for "S" mark here
(e.g. 87^S (KB) - JAPAN)

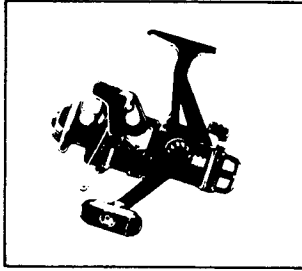

EXPLODED PARTS VIEW
AX200

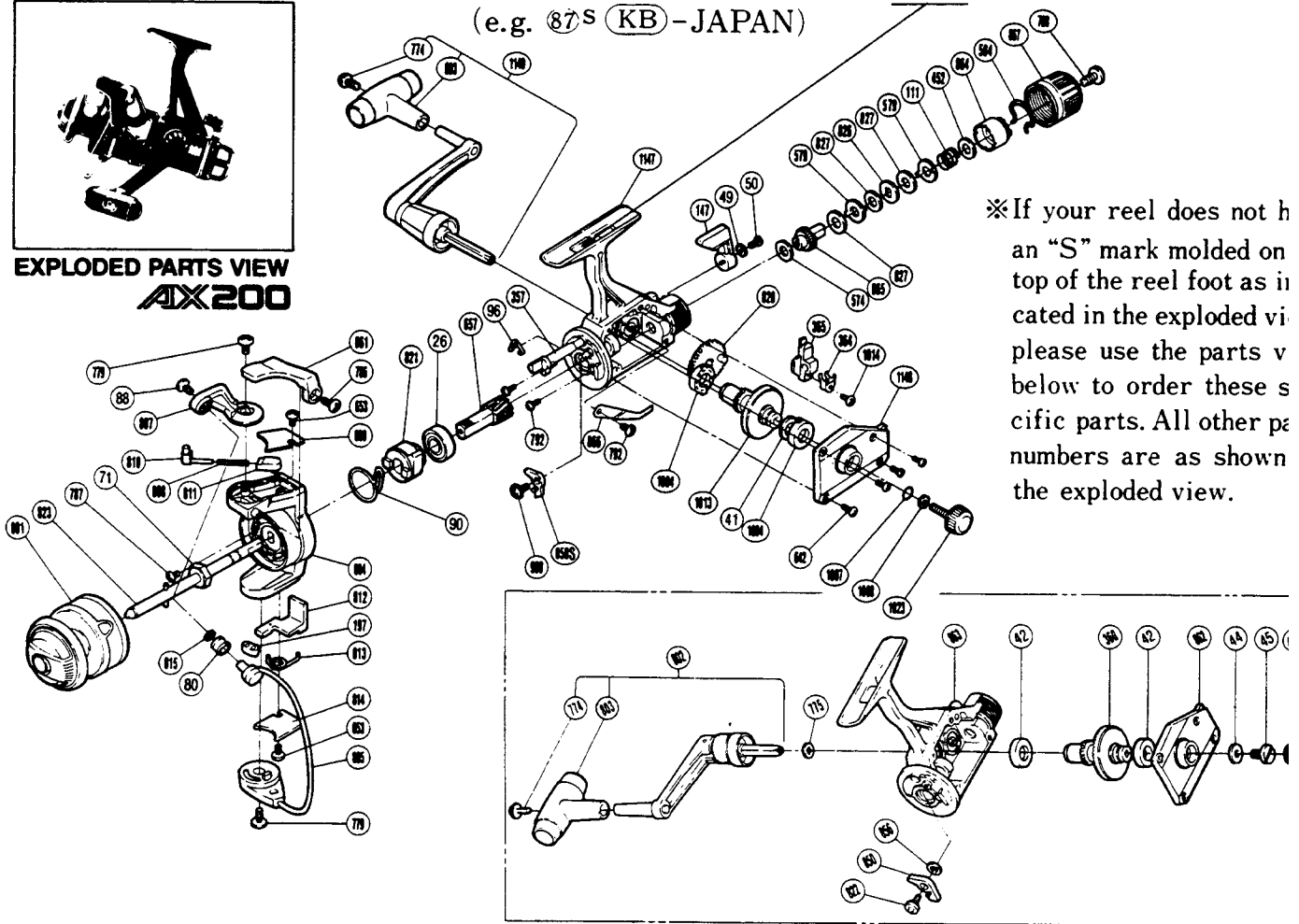

PARTS LIST

PART # DESCRIPTION

- 26. Ball Bearing
- 41. Drive Gear Washer
- 42. Bushing
- 44. Handle Lock Washer
- 45. Handle Lock Screw (Originally 796)
- 46A. Handle Screw Cap
- 49. Lock Washer
- 50. Anti-Reverse Lever Screw
- 71. Rotor Nut
- 80. Line Roller
- 88. Line Roller Screw (orig. 806)
- 90. Anti-Reverse Pawl Spring
- 96. Anti-Reverse Cam Spring
- 111. Drag Coil Spring
- 147. Anti-Reverse Lever
- 197. Bail Trip Slide Cam
- 357. Anti-Reverse Cam
- 360. Drive Gear
- 363. Slider Retainer Screw
- 364. Oscillating Slider Retainer
- 365. Oscillating Slider
- 452. Drag Spring Washer "A"
- 574. Drag Washer "C₂"
- 579. Eared Washer "B"
- 584. Hold Click Spring
- 642. Side Cover Screw
- 653. Bail Trip Cover Screw

PART # DESCRIPTION

- 657. Pinion Gear
- 662. Drag Knob Screw
- 774. Handle Knob Screw
- 775. Handle Lock Spacer
- 779. Bail Trip Cam Screw
- 786. Trigger Screw
- 787. Nut Lock Screw
- 792. Multi Purpose Screw
- 801. Spool Assembly (Universal)
- 802. Handle
- 803. Handle Knob
- 804. Rotor
- 805. Bail Assembly
- 807. Bail Arm
- 808. Bail Spring
- 809. Bail Spring Cover
- 810. Bail Spring Guide A
- 811. Bail Spring Guide B
- 812. Bail Trip Lever
- 813. Lever Spring
- 814. Bail Trip Cover
- 815. Line Roller Washer
- 820. Oscillating Gear
- 821. Anti-Reverse Ratchet
- 822. Anti-Reverse Pawl Screw
- 823. Main Shaft

PART # DESCRIPTION

- 826. Key Washer "A"
- 827. Drag Washer "H,"
- 850. Anti-Reverse Pawl
- 850S. Anti-Reverse Pawl ("S" Version)
- 856. Anti-Reverse Pawl Spacer
- 861. Quick-Fire II Trigger
- 862. Side Cover
- 863. Body
- 864. Pressure Screw
- 865. Drag Shaft
- 866. Drag Click
- 867. Drag Knob
- 1004. Bushing A ("S" Version)
- 1007. Lock Washer Retainer ("S" Version)
- 1008. Handle Lock Washer ("S" Version)
- 1013. Drive Gear ("S" Version)
- 1014. Slider Retainer Screw ("S" Version)
- 1023. Handle Screw Cap ("S" Version)
- 1147. Body ("S" Version)
- 1148. Side Cover ("S" Version)
- 1149. Handle Assembly ("S" Version)