

# SHIMANO®

## 1987 REPAIR MANUAL

Shimano American Corporation, One Shimano Dr.  
Irvine, CA 92718

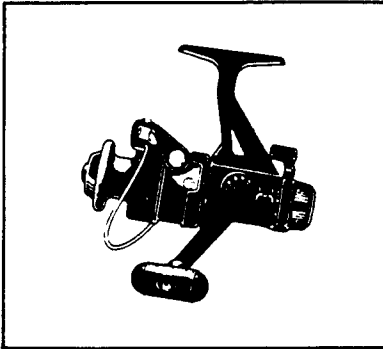

### TO ORDER:

This reel belongs to the "Rear Drag" series.  
Please order parts using the abbreviation  
"RD" and the part number.

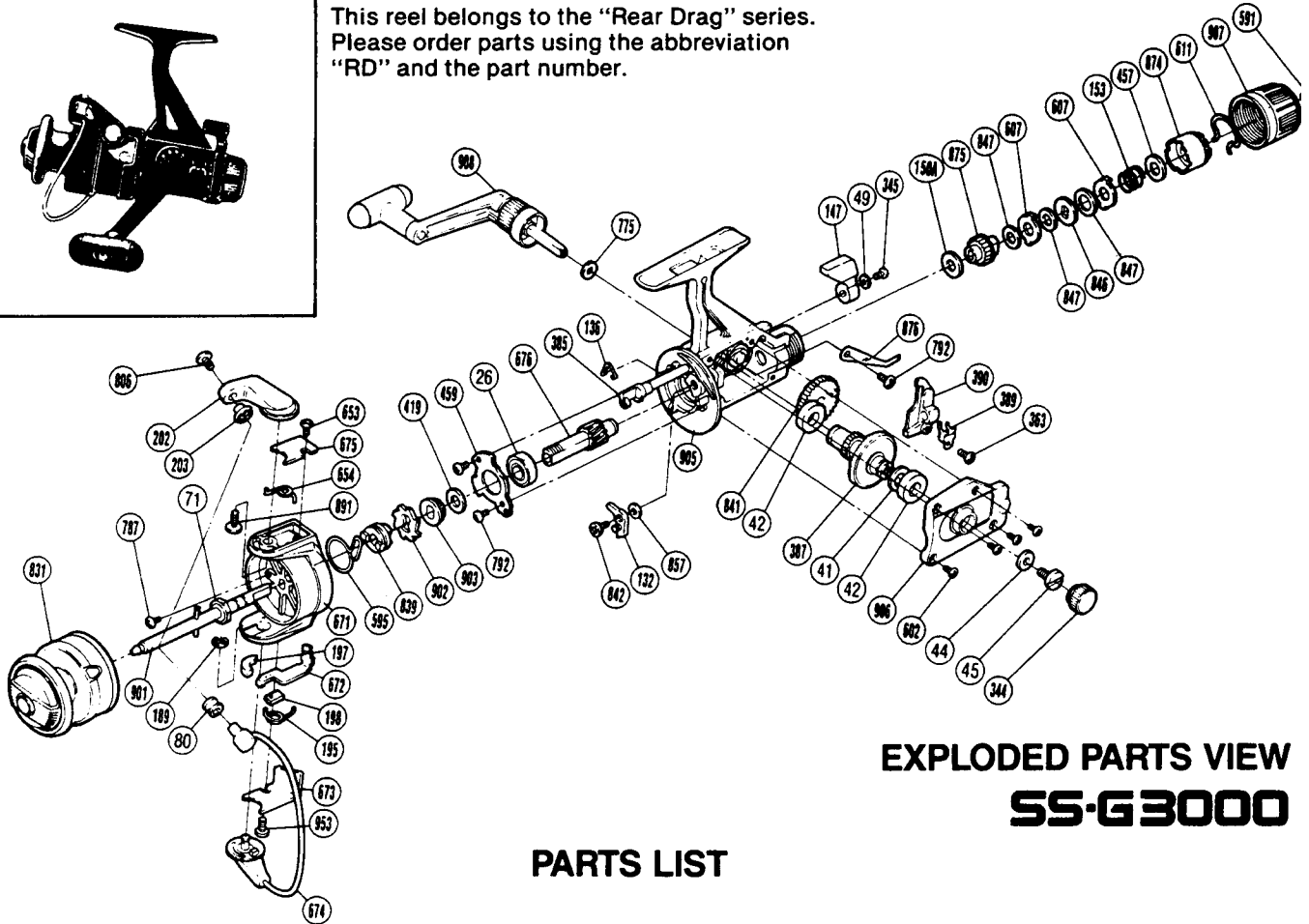

## EXPLODED PARTS VIEW SS-G3000

### PARTS LIST

#### PART # DESCRIPTION

- 26. Ball Bearing
- 41. Drive Gear Washer
- 42. Bushing
- 44. Handle Lock Washer
- 45. Handle Lock Screw (Originally 796)
- 49. Lock Washer
- 71. Rotor Nut
- 80. Line Roller
- 132. Anti-Reverse Pawl
- 136. Anti-Reverse Cam Spring
- 147. Anti-Reverse Lever
- 150A. Drag Washer "C<sub>2</sub>"
- 153. Drag Coil Spring
- 189. "E" Lock
- 195. Lever Spring
- 197. Bail Trip Slide Cam
- 198. Trip Lever Guide
- 202. Bail Arm
- 203. Line Roller Washer
- 344. Handle Screw Cap
- 345. Anti-Reverse Lever Screw
- 363. Slider Retainer Screw

#### PART # DESCRIPTION

- 385. Anti-Reverse Cam
- 387. Drive Gear
- 389. Oscillating Slider Retainer
- 390. Oscillating Slider
- 419. Bushing Washer
- 457. Drag Spring Washer "A"
- 459. Bearing Retainer
- 591. Drag Knob Screw
- 595. Anti-Reverse Pawl Spring
- 602. Side Cover Screw
- 607. Eared Washer "B"
- 611. Hold Click Spring
- 653. Bail Trip Cover Screw
- 654. Bail Spring
- 671. Rotor
- 672. Bail Trip Lever
- 673. Bail Trip Cover
- 674. Bail Assembly
- 675. Bail Spring Cover
- 676. Pinion Gear
- 775. Handle Lock Spacer

#### PART # DESCRIPTION

- 787. Nut Lock Screw
- 792. Multi Purpose Screw
- 806. Line Roller Screw
- 831. Spool Assembly (Universal)
- 839. Anti-Reverse Spring Holder
- 841. Oscillating Gear
- 842. Anti-Reverse Pawl Screw
- 846. Key Washer "A"
- 847. Drag Washer "H<sub>1</sub>"
- 857. Anti-Reverse Pawl Spacer
- 874. Pressure Screw
- 875. Drag Shaft
- 876. Drag Click
- 891. Bail Arm Screw
- 901. Main Shaft
- 902. Anti-Reverse Ratchet
- 903. Pinion Spacer
- 905. Body
- 906. Side Cover
- 907. Drag Knob
- 908. Handle Assembly