

SHIMANO

1987 REPAIR MANUAL

Shimano American Corporation, One Shimano Dr.
Irvine, CA 92718

TO ORDER:

This reel belongs to the "Triton Lever Drag" series.
Please order parts using the abbreviation "TLD"
and the part number.

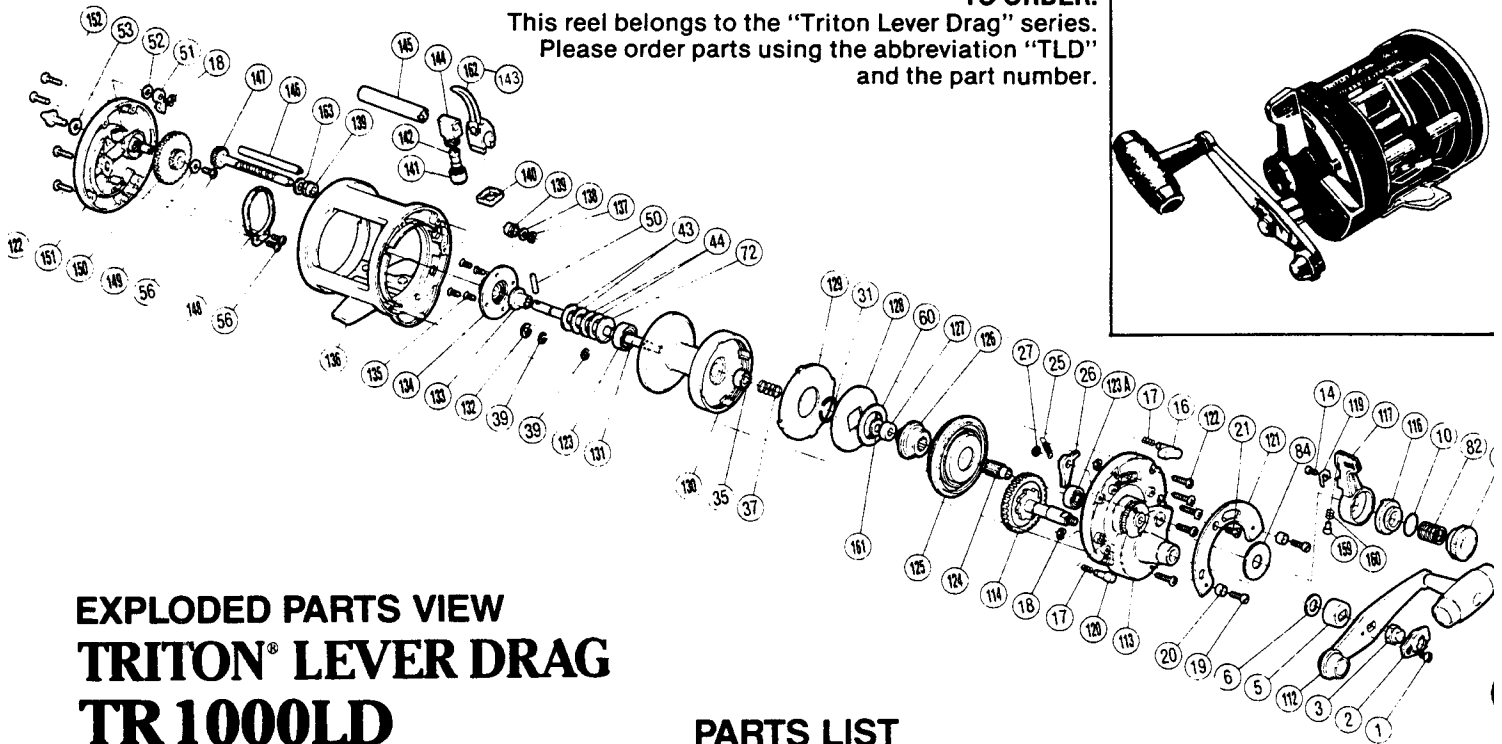
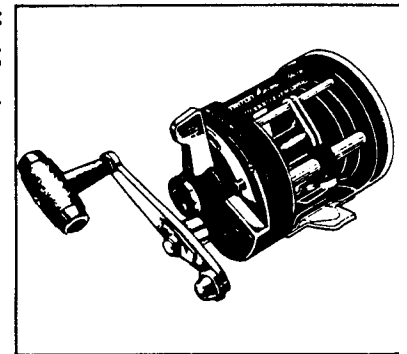

EXPLODED PARTS VIEW TRITON® LEVER DRAG TR 1000LD

PARTS LIST

PART # DESCRIPTION

- 1. Handle Lock Screw
- 2. Handle Lock
- 3. Handle Nut
- 5. Gear Shaft Shield
- 6. Gear Shaft Thrust Washer
- 10. Body "O" Seal
- 14. Click Spring Screw
- 16. Strike Stop
- 17. Pressure Spring
- 18. "C" Lock
- 19. Quadrant Anchor Bolt
- 20. Bolt Shield
- 21. Quadrant Screw
- 25. Dog Spring
- 26. Dog
- 27. Dog Spring Retainer
- 31. Seal Lock
- 35. Ball Bearing
- 37. Pressure Release Spring
- 39. "C" Lock
- 43. Pre-Load Washer (B)
- 44. Pre-Load Spring B
- 50. Cross Pin B
- 51. Click Pawl
- 52. Click Pawl Washer
- 53. Click Button Washer A
- 56. Click Spring Screw
- 60. Pre-Load Spring A
- 72. Pre-Load Washer A
- 82. Dial Spring

PART # DESCRIPTION

- 84. Lever Thrust Ring
- 112. Handle
- 113. Right Side Plate
- 114. Main Gear
- 115. Pre-Program Dial
- 116. Lever Shaft Body
- 117. Drag Control Lever
- 118. Friction Shoe Assembly****
- 119. Lever Click Spring
- 120. Free Spool Detent
- 121. Lever Quadrant
- 122. Side Plate Bolt
- 123. Ball Bearing (Main Shaft)
- 123A. Ball Bearing (Side Plate)
- 124. Pinion Gear
- 125. Cooling Shield
- 126. Pinion Guard
- 127. Bushing
- 128. Drag Plate
- 129. Titanium Drag Washer
- 130. Spool
- 131. Main Shaft
- 132. "C" Lock
- 133. Pre-Load Body
- 134. Click Gear
- 135. Click Gear Screw
- 136. Frame
- 137. Worm Shaft Retainer
- 138. Worm Shaft Holder Washer

PART # DESCRIPTION

- 139. Worm Bearing
- 140. Line Guide Cover
- 141. Pawl Cap
- 142. Line Guide Pawl
- 143. Line Guide (original)
- 144. Level Wind Guide
- 145. Level Wind Guard
- 146. Stabilizer Bar
- 147. Worm Shaft
- 148. Click Spring
- 149. Lock Washer
- 150. Idle Gear
- 151. Left Side Plate
- 152. Click Button
- 159. Friction Shoe
- 160. Friction Shoe Spring
- 161. Thrust Washer*
- 162. Line Guide (New)**
- 163. Worm Shaft Spacer** ***

* Not used on older reels.

** 162 and 163 are used together on newer reels.

*** Not on reels using 143 line guide.

**** Order 159 and 160.