

# SHIMANO®

## 1987 REPAIR MANUAL

Shimano American Corporation, One Shimano Dr.  
Irvine, CA 92718

### TO ORDER:

This reel belongs to the "Triton Lever Drag" series.  
Please order parts using the abbreviation "TLD"  
and the part number.

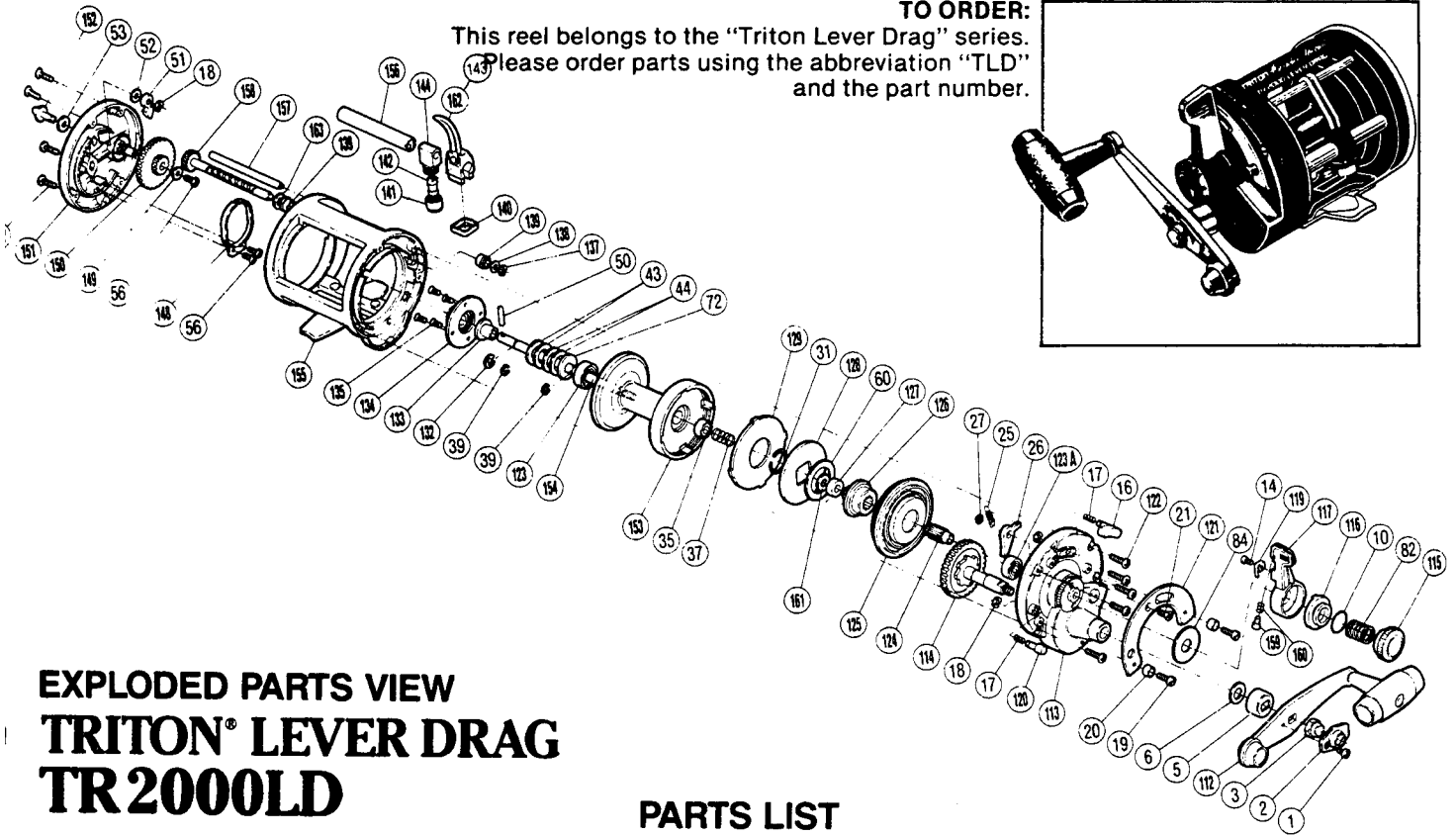
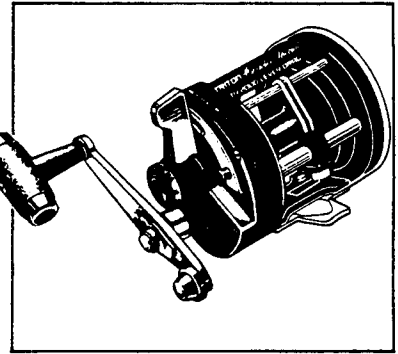

## EXPLODED PARTS VIEW TRITON® LEVER DRAG TR2000LD

### PARTS LIST

PART #	DESCRIPTION	PART #	DESCRIPTION	PART #	DESCRIPTION
1.	Handle Lock Screw	72.	Pre-Load Washer A	138.	Worm Shaft Holder Washer
2.	Handle Lock	82.	Dial Spring	139.	Worm Bearing
3.	Handle Nut	84.	Lever Thrust Ring	140.	Line Guide Cover
5.	Gear Shaft Shield	112.	Handle	141.	Pawl Cap
6.	Gear Shaft Thrust Washer	113.	Right Side Plate	142.	Line Guide Pawl
10.	Body "O" Seal	114.	Main Gear	143.	Line Guide (original)
14.	Click Spring Screw	115.	Pre-Program Dial	144.	Level Wind Guide
16.	Strike Stop	116.	Lever Shaft Body	148.	Click Spring
17.	Pressure Spring	117.	Drag Control Lever	149.	Lock Washer
18.	"C" Lock	118.	Friction Shoe Assembly****	150.	Idle Gear
19.	Quadrant Anchor Bolt	119.	Lever Click Spring	151.	Left Side Plate
20.	Bolt Shield	120.	Free Spool Detent	152.	Click Button
21.	Quadrant Screw	121.	Lever Quadrant	153.	Spool
25.	Dog Spring	122.	Side Plate Bolt	154.	Main Shaft
26.	Dog	123.	Ball Bearing (Main Shaft)	155.	Frame
27.	Dog Spring Retainer	123A	Ball Bearing (Side Plate)	156.	Level Wind Guard
31.	Seal Lock	124.	Pinion Gear	157.	Stabilizer Bar
35.	Ball Bearing	125.	Cooling Shield	158.	Worm Shaft
37.	Pressure Release Spring	126.	Pinion Guard	159.	Friction Shoe
39.	"C" Lock	127.	Bushing	160.	Friction Shoe Spring
43.	Pre-Load Washer (B)	128.	Drag Plate	161.	Thrust Washer*
44.	Pre-Load Spring B	129.	Titanium Drag Washer	162.	Line Guide (New)**
50.	Cross Pin B	132.	"C" Lock	163.	Worm Shaft Spacer** ***
51.	Click Pawl	133.	Pre-Load Body		
52.	Click Pawl Washer	134.	Click Gear		
53.	Click Button Washer A	135.	Click Gear Screw		
56.	Click Spring Screw	137.	Worm Shaft Retainer		
60.	Pre-Load Spring A				

\* Not used on older reels.  
\*\*162 and 163 are used together on newer reels.  
\*\*\*Not on reels using 143 line guide.  
\*\*\*\*Order 159 and 160.