

※Please check the head of the "Magnetic Control Dial" here to see whether you have an old or new-type reel.

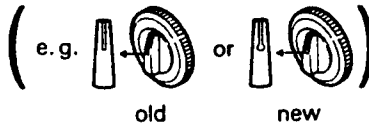

※If your reel has an old-type "Magnetic Control Dial" indicated in the exploded view, please use the parts in the box below the main diagram to order these specific parts. All other part numbers are as shown in the main exploded view.

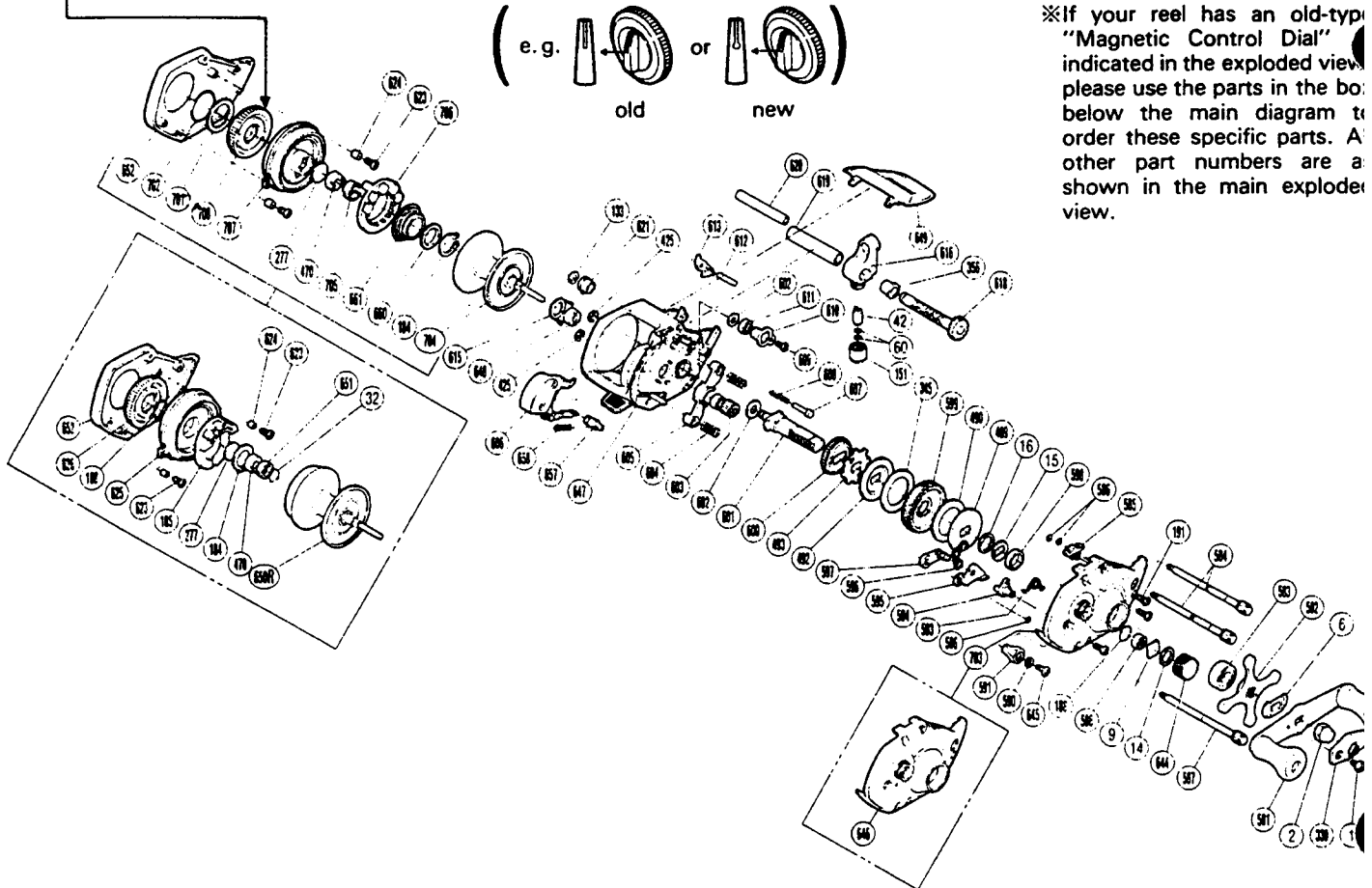

BNT No.	PARTS NAMES	BNT No.	PARTS NAMES	BNT No.	PARTS NAMES
0001	Handle Nut Plate Screw	0587	Side Plate Bolt "A"	0621	Worm Bearing "B"
0002	Handle Nut	0588	Spool Shaft Bushing	0623	Dial Case Screw
0006	Friction Washer "A"	0590	Lock Washer	0624	Screw Support
0009	Cast Control Spacer	0591	Flipping Lever	0644	Cast Control Cap
0014	Friction Washer "B"	0593	Cam Spring	0645	Flipping Lever Screw
0015	Drag Spring Washer	0594	Flipping Cam	0647	One-Piece Frame
0016	Friction Washer "C"	0595	Joint Plate	0648	Spool Shaft Bushing
0042	Line Guide Pawl	0596	Retractor Spring	0649	Thumb Rest
0060	Spacer (optional)	0597	Retractor Spring Guide	0652	Left Side Plate
0133	Worm Shaft Retainer	0598	Bushing	0657	Clutch Button Guide Pin
0151	Pawl Cap	0599	Drive Gear	0658	Flipping Retractor Spring
0184	Magnet Retainer Lock	0600	Idle Gear	0660	Spring Spacer (new)
0188	O Ring	0601	Drive Shaft	0661	Magnet Retainer Spring (new)
0191	Right Side Plate Screw	0602	Drive Shaft Washer "C"	0701	Thrust Washer Spacer (optional) (new)
0277	Bushing Spacer "B"	0603	Pinion Gear	0702	Dial O Ring (new)
0330	Handle Nut Plate	0604	Yoke Spring	0703	Right Side Plate (new)
0345	Drive Shaft Washer "B"	0605	Yoke	0704	Spool (new)
0356	Worm Bearing "A"	0606	Clutch Button	0705	Bushing Retainer (new)
0425	Clutch Button Lock	0607	Switch Spring Pin	0706	Magnet Retainer (new)
0458	Bushing "C"	0608	Switch Spring	0707	Dial Case (new)
0489	Key Washer "A"	0609	Drive Shaft Retainer Screw	0708	Magnetic Control Dial (new)
0490	Drag Washer	0610	Drive Shaft Retainer		
0492	Key Washer "B"	0611	Drive Shaft Bushing		
0493	Anti-Reverse Ratchet	0612	Anti-Reverse Pawl Pin	0032	Bushing Retainer
0581	Handle Assembly	0613	Anti-Reverse Pawl	0185	Magnet Retainer
0582	Star Drag	0615	Bushing Retainer	0625	Dial Case
0583	Drive Shaft Bearing	0616	Line Guide	0626	Magnetic Control Dial
0584	Side Plate Bolt "C"	0618	Worm Shaft	0646	Right Side Plate
0585	Anti-Reverse Switch	0619	Lever Wind Guard	0650R	Spool