

## EXPLODED PARTS VIEW

MEDIUM SPECIAL GRAPHITE CONSTRUCTION

# FX300

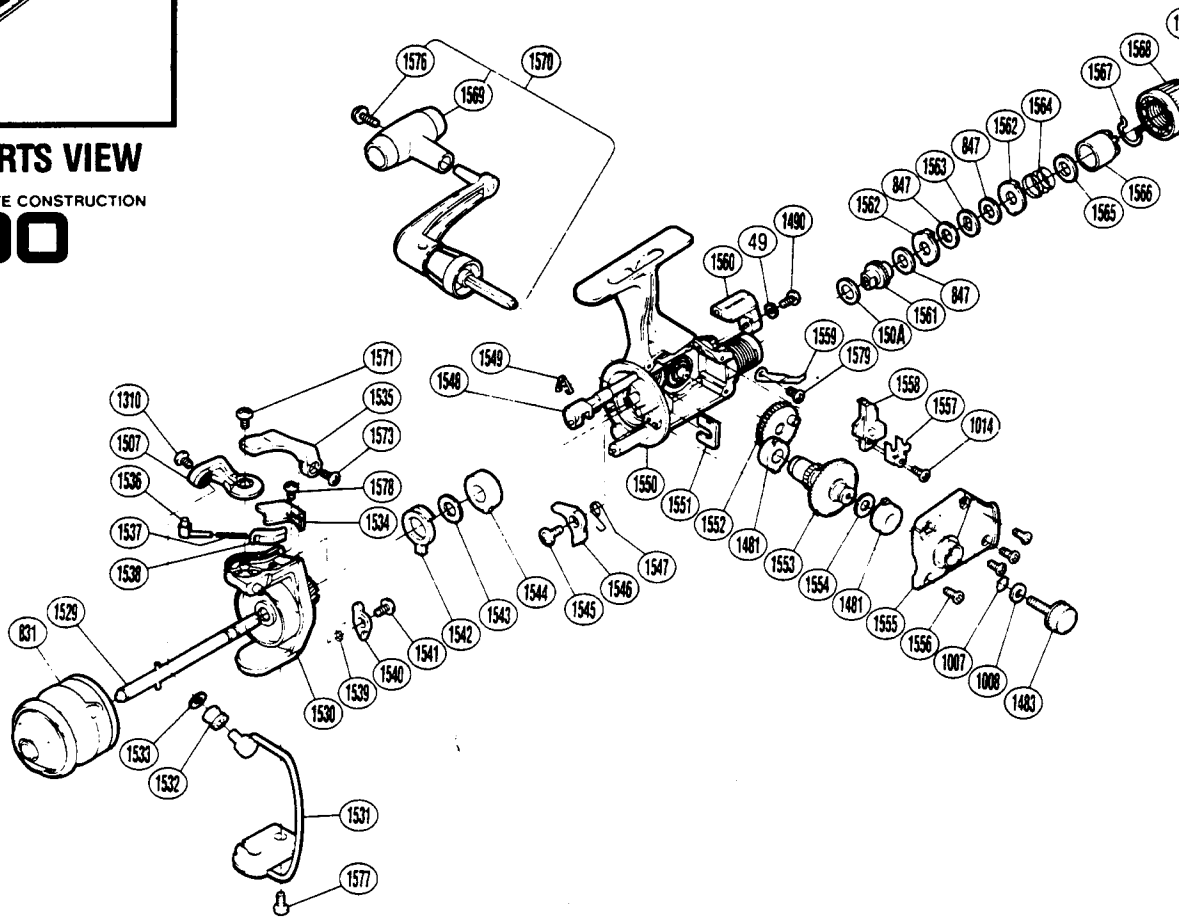

## PARTS LIST

PART #	DESCRIPTION	PART #	DESCRIPTION	PART #	DESCRIPTION
RD 0049	Lock Washer	RD 1538	Bail Spring Guide B	RD 1559	Drag Click
RD 0150A	Drag Washer "C2" (White)	RD 1539	Lever Spring	RD 1560	Anti-Reverse Lever
RD 0831	Spool Assembly (Universal)	RD 1540	Bail Trip Lever	RD 1561	Drag Shaft
RD 0847	Drag Washer "H1"	RD 1541	Lever Screw	RD 1562	Eared Washer "B"
RD 1007	Lock Washer Retainer	RD 1542	Anti-Reverse Lock Out	RD 1563	Key Washer "A"
RD 1008	Handle Lock Washer	RD 1543	Bushing Washer	RD 1564	Drag Coil Spring
RD 1014	Slider Retainer Screw	RD 1544	Bushing	RD 1565	Drag Spring Washer "A"
RD 1310	Line Roller Screw	RD 1545	Anti-Reverse Pawl Screw	RD 1566	Pressure Screw
RD 1481	Bushing A	RD 1546	Anti-Reverse Pawl	RD 1567	Hold Click Spring
RD 1483	Handle Screw Cap	RD 1547	Anti-Reverse Pawl Spring	RD 1568	Drag Knob
RD 1490	Anti-Reverse Lever Screw	RD 1548	Anti-Reverse Cam	RD 1569	Handle Knob
RD 1507	Bail Arm	RD 1549	Anti-Reverse Cam Spring	RD 1570	Handle Assembly
RD 1529	Main Shaft	RD 1550	Body	RD 1571	Bail Trip Cam Screw
RD 1530	Rotor	RD 1551	Rotor Lock	RD 1573	Trigger Screw
RD 1531	Bail Assembly	RD 1552	Oscillating Gear	RD 1576	Handle Knob Screw
RD 1532	Line Roller	RD 1553	Drive Gear	RD 1577	Bail Hold Cover Screw
RD 1533	Line Roller Washer	RD 1554	Drive Gear Washer	RD 1578	Bail Spring Cover Screw
RD 1534	Bail Spring Cover	RD 1555	Side Cover	RD 1579	Drag Click Screw
RD 1535	Quick-Fire II Trigger	RD 1556	Side Cover Screw	RD 1580	Drag Knob Screw
RD 1536	Bail Spring Guide A	RD 1557	Oscillating Slider Retainer		
RD 1537	Bail Spring	RD 1558	Oscillating Slider		