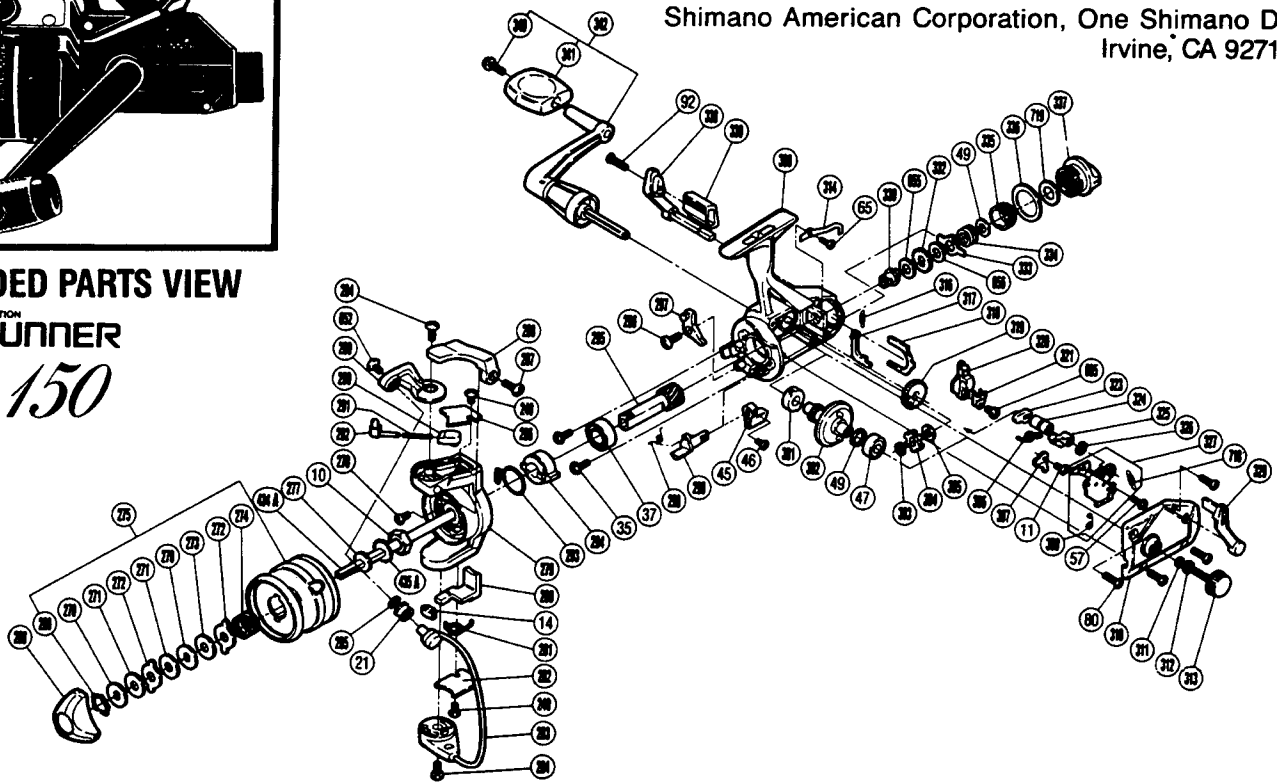
**EXPLODED PARTS VIEW**

GRAPHITE CONSTRUCTION

BAITRUNNER*150*Shimano American Corporation, One Shimano D
Irvine, CA 9271**PARTS LIST**

PART #	DESCRIPTION	PART #	DESCRIPTION	PART #	DESCRIPTION
BR 0010	Rotor Nut	BR 0285	Line Roller Washer	BR 0318	Dial Retainer
BR 0011	Nut Lock Screw	BR 0286	Bail Spring Cover	BR 0319	Oscillating Gear
BR 0014	Bail Trip Slide Cam	BR 0287	Trigger Screw	BR 0320	Oscillating Slider
BR 0021	Line Roller	BR 0288	Quick-Fire II Trigger	BR 0321	Oscillating Slider Retainer
BR 0035	Bearing Retainer Screw	BR 0289	Bail Arm	BR 0323	Clutch Cam
BR 0037	Ball Bearing	BR 0290	Bail Spring Guide B	BR 0324	Clutch Cam Spacer
BR 0045	Anti-Reverse Lever	BR 0291	Bail Spring	BR 0325	Clutch Arm
BR 0046	Anti-Reverse Lever Screw	BR 0292	Bail Spring Guide A	BR 0326	Lever Shaft Retainer
BR 0047	Ball Bearing	BR 0293	Anti-Reverse Pawl Spring	BR 0327	Clutch Plate Assembly
BR 0049	Drive Gear Washer	BR 0294	Anti-Reverse Ratchet	BR 0329	Baitrunner Lever Arm (L)
BR 0057	Clutch Plate Screw	BR 0295	Pinion Gear	BR 0330	Free Spool Tension Shaft
BR 0065	Dial Click Screw	BR 0296	Anti-Reverse Pawl Screw	BR 0332	Click Gear
BR 0080	Side Cover Screw B	BR 0297	Anti-Reverse Pawl	BR 0333	Eared Washer "BFS"
BR 0092	Baitrunner Lever Screw	BR 0298	Anti-Reverse Cam Spring	BR 0334	Free Spool Tension Spring
BR 0240	Bail Trip Cover Screw	BR 0299	Anti-Reverse Cam	BR 0335	Free Spool Tension Screw
BR 0268	Drag Knob	BR 0300	Body	BR 0336	Dial Spacer
BR 0269	Drag Washers Retainer	BR 0301	Bushing	BR 0337	Baitrunner Tension Dial
BR 0270	Key Washer	BR 0302	Drive Gear	BR 0338	Baitrunner Lever Arm (R)
BR 0271	Drag Washer 1	BR 0303	"C" Lock	BR 0339	Baitrunner Lever Bridge
BR 0272	Eared Washer	BR 0304	Baitrunner Ratchet	BR 0340	Handle Knob Screw
BR 0273	Drag Washer 2	BR 0305	Ratchet Spacer	BR 0341	Handle Knob
BR 0274	Drag Spring	BR 0306	Clutch Spring	BR 0342	Handle Assembly
BR 0275	Spool Assembly	BR 0307	Baitrunner Pawl Guide	BR 0434A	Main Shaft
BR 0277	Spool Washer	BR 0309	Clutch Pawl Spring	BR 0435A	Spool Support
BR 0278	Nut Lock Screw	BR 0310	Side Cover	BR 0652	Line Roller Screw
BR 0279	Rotor	BR 0311	Lock Washer Retainer	BR 0655	Free Spool Tension Washer (A)
BR 0280	Bail Trip Lever	BR 0312	Handle Lock Washer	BR 0656	Free Spool Tension Washer (B)
BR 0281	Lever Spring	BR 0313	Handle Screw Cap	BR 0685	Slider Retainer Screw
BR 0282	Bail Trip Cover	BR 0314	Dial Click	BR 0718	Baitrunner Click Spring
BR 0283	Bail Assembly	BR 0316	Baitrunner Pawl Spring	BR 0719	Adjusting Spacer
BR 0284	Bail Trip Cam Screw	BR 0317	Baitrunner Pawl		