

SHIMANO®

1989 REPAIR MANUAL

Shimano American Corporation, One Shimano Dr.
Irvine, CA 92718

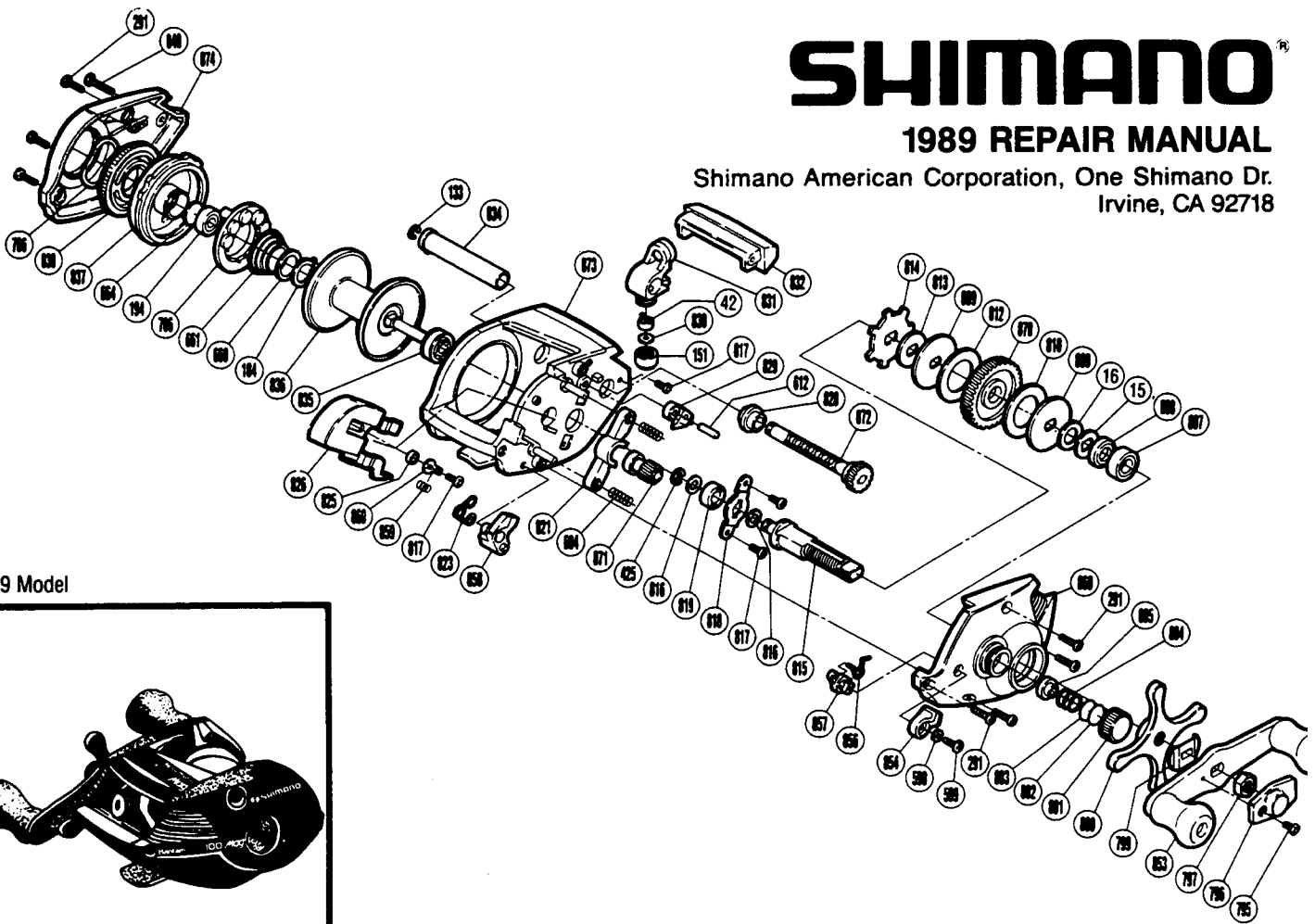

1989 Model



EXPLODED PARTS VIEW

Bantam **TX 100 Mag**
Flip-N-Crank

PARTS LIST

PART #	DESCRIPTION
BNT 0015	Drag Spring Washer
BNT 0016	Friction Washer (C)
BNT 0042	Line Guide Pawl
BNT 0133	Worm Shaft Retainer
BNT 0151	Pawl Cap
BNT 0184	Magnet Retainer Lock
BNT 0194	Ball Bearing
BNT 0291	Side Plate Screw
BNT 0425	Clutchbutton Lock
BNT 0589	Flipping Lever Screw
BNT 0590	Lock Washer
BNT 0604	Yoke Spring
BNT 0612	Anti-Reverse Pawl Pin
BNT 0660	Spring Spacer
BNT 0661	Magnet Retainer Spring
BNT 0664	Spacer (B)
BNT 0706	Magnet Retainer
BNT 0766	Dial Friction Washer
BNT 0795	Handle Nut Plate Screw
BNT 0796	Handle Nut Plate
BNT 0797	Handle Nut
BNT 0799	Friction Washer
BNT 0800	Star Drag

PART #	DESCRIPTION
BNT 0801	Cast Control Cap
BNT 0802	Spool Tension Spacer (B)
BNT 0803	Spool Tension Spacer (A)
BNT 0804	Spool Tension Spring
BNT 0805	Spool Shaft Bushing (A)
BNT 0807	Drive Shaft Bearing
BNT 0808	Friction Washer (B)
BNT 0809	Key Washer (A)
BNT 0810	Drag Washer (A)
BNT 0812	Drag Washer (B)
BNT 0813	Key Washer (B)
BNT 0814	Anti-Reverse Ratchet
BNT 0815	Drive Shaft
BNT 0816	Drive Shaft Washer
BNT 0817	Multi Purpose Screw
BNT 0818	Drive Shaft Retainer
BNT 0819	Drive Shaft Bushing
BNT 0821	Yoke
BNT 0823	Retractor Spring
BNT 0825	Yoke Plate Washer (A)
BNT 0826	Clutch Button
BNT 0828	Worm Bearing
BNT 0829	Anti-Reverse Pawl

PART #	DESCRIPTION
BNT 0830	Spacer (Optional)
BNT 0831	Line Guide
BNT 0832	Level Wind Protector
BNT 0834	Level Wind Guard
BNT 0835	Spool Shaft Bushing (B)
BNT 0836	Spool
BNT 0837	Dial Case
BNT 0838	Magnetic Control Dial
BNT 0840	Left Side Plate Screw
BNT 0853	Handle Assembly
BNT 0854	Flipping Lever
BNT 0856	Cam Spring
BNT 0857	Flipping Cam
BNT 0858	Joint Plate
BNT 0859	Flipping Retractor Spring
BNT 0860	Yoke Plate Washer (B)
BNT 0869	Right Side Plate
BNT 0870	Drive Gear
BNT 0871	Pinion Gear
BNT 0872	Worm Shaft
BNT 0873	One-Piece Frame
BNT 0874	Left Side Plate