

EXPLODED PARTS VIEW

SHIMANO®

1991 REPAIR MANUAL

Shimano American Corporation, One Shimano Dr.
Irvine, CA 92718

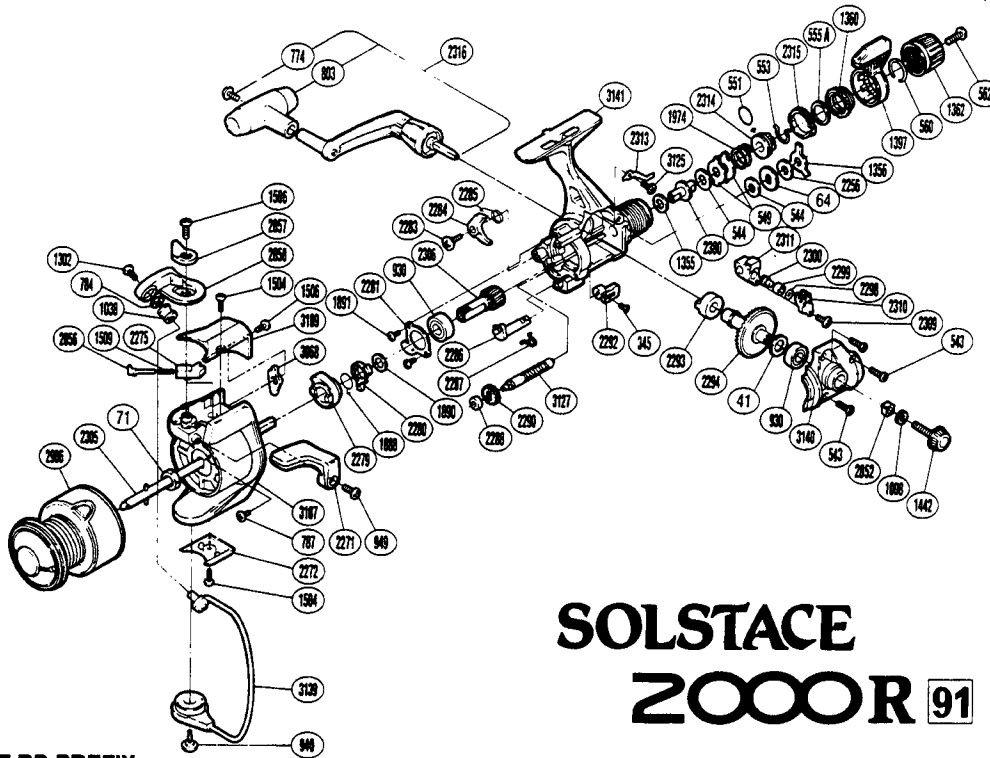

SOLSTACE ZOOR 91

TO ORDER: USE RD PREFIX
WITH PART NUMBER

PARTS LIST

RD #	DESCRIPTION	RD #	DESCRIPTION	RD #	DESCRIPTION
0041	Drive Gear Washer	1397	Fightin' Drag II Lever	2298	Spacer
0064	Click Gear	1442	Handle Screw Cap	2299	Oscillating Slider Bushing
0071	Rotor Nut	1504	Bail Spring Cover Screw	2300	Oscillating Pawl
0345	Anti-Reverse Lever Screw	1506	Multi Purpose Screw	2305	Main Shaft
0543	Side Cover Screw	1509	Bail Spring	2306	Pinion Gear
0544	Drag Washer "C ₂ " (White)	1888	Anti-Reverse Lock Out Spring	2309	Slider Retainer Screw
0549	Eared Washer "B"	1890	Bushing Washer	2310	Oscillating Slider Retainer
0551	"O" Ring	1891	Bearing Retainer Screw	2311	Oscillating Slider
0553	Hold Click Spring	1974	Drag Coil Spring	2313	Drag Click
0555A	Fightin' Pressure Screw Washer	2256	Drag Washer "C ₁ "	2314	Pressure Screw
0560	Lever Hold Spring	2271	Quick-Fire II Trigger	2315	Lever Click Gear
0562	Drag Programmer Screw	2272	Rotor Side Cover	2316	Handle Assembly
0774	Handle Knob Screw	2275	Bail Spring Guide (B)	2380	Drag Shaft
0784	Line Roller washer	2279	Anti-Reverse Ratchet	2852	Handle Screw Lock
0787	Nut Lock Screw	2280	Anti-Reverse Lock out	2856	Bail Spring Guide (A)
0803	Handle Knob	2281	Bearing Retainer	2857	Trigger Cam
0930	Ball Bearing	2283	Anti-Reverse Pawl Screw	2858	Bail Arm
0940	Bail Trip Cam Screw	2284	Anti-Reverse Pawl	2906	Spool Assembly
0949	Trigger Screw	2285	Anti-Reverse Pawl Spring	3068	Bail Trip Lever
1008	Handle Lock Washer	2286	Anti-Reverse Cam	3107	Rotor
1038	SiC Ceramic Roller	2287	Anti-Reverse Cam Spring	3109	Bail Spring Cover
1302	Line Roller Screw	2288	Worm Bearing	3125	Drag Click Screw
1355	Drag Washer "C ₁ " (white)	2290	Idle Gear	3127	Worm Shaft
1356	Eared Washer "B"	2292	Anti-Reverse Lever	3139	Bail Assembly
1360	Fightin' Pressure Screw	2293	Drive Gear Bushing	3140	Side Cover
1362	Drag Programmer	2294	Drive Gear	3141	Body