

**EXPLODED PARTS VIEW**

# SHIMANO®

## 1991 REPAIR MANUAL

Shimano American Corporation, One Shimano Dr.  
Irvine, CA 92718

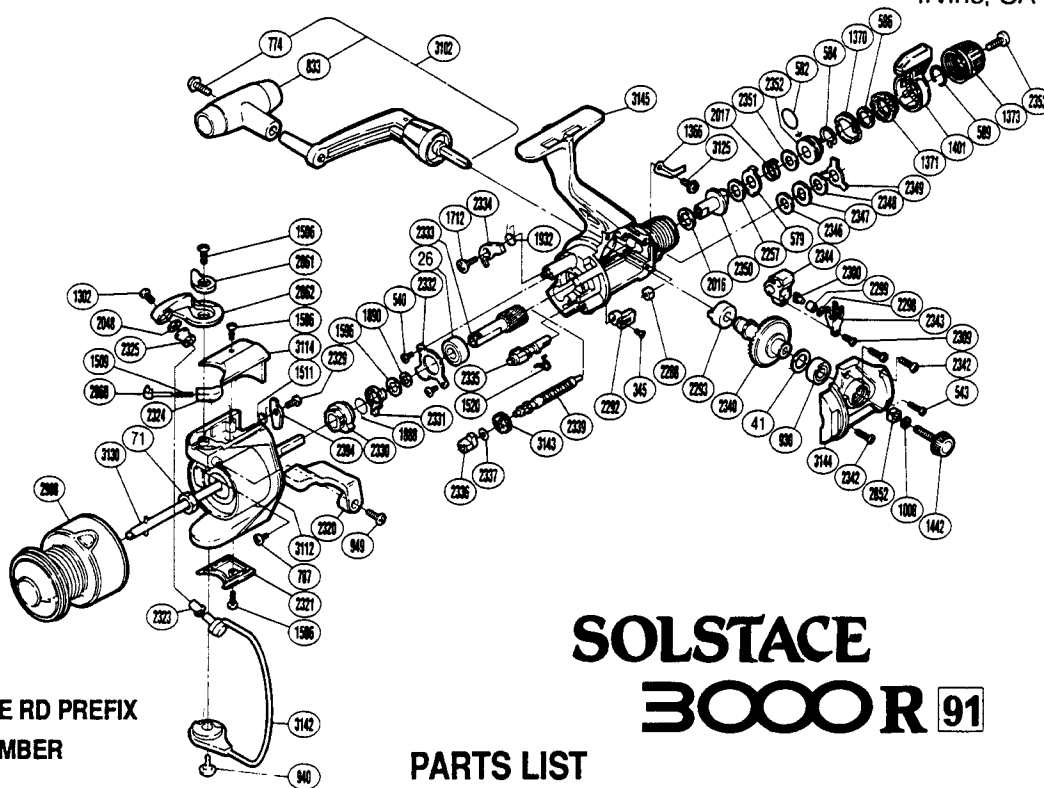

**TO ORDER: USE RD PREFIX  
WITH PART NUMBER**

# SOLSTACE 3000R 91

## PARTS LIST

RD #	DESCRIPTION	RD #	DESCRIPTION	RD #	DESCRIPTION
0026	Ball Bearing	1596	Bushing Washer	2337	Worm Shaft Spacer
0041	Drive Gear Washer	1712	Anti-Reverse Pawl Screw	2339	Worm Shaft
0071	Rotor Nut	1888	Anti-Reverse Lock Out Spring	2340	Drive Gear
0345	Anti-Reverse Lever Screw	1890	Bushing Washer	2342	Side Cover Screw (A)
0540	Bearing Retainer Screw	1932	Anti-Reverse Pawl Spring	2343	Oscillating Slider Retainer
0543	Side Cover Screw (B)	2016	Drag Washer "H2" (white)	2344	Oscillating Slider
0579	Eared Washer "B"	2017	Drag Coil Spring	2346	Drag Washer "C2" (white)
0582	"O" Ring	2048	Line Roller Washer	2347	Click Gear
0584	Hold Click Spring	2257	Drag Washer "H1"	2348	Drag Washer "C1"
0586	Fightin' Pressure Screw Washer	2288	Worm Bearing (rear)	2349	Eared Washer "BF"
0589	Lever Hold Spring	2292	Anti-Reverse Lever	2350	Drag Shaft
0774	Handle Knob Screw	2293	Drive Gear Bushing	2351	Drag Spring Washer
0787	Nut Lock Screw	2298	Spacer	2352	Pressure Screw
0833	Handle Knob	2299	Oscillating Slider Bushing	2353	Drag Programmer Screw
0930	Ball Bearing	2300	Oscillating Pawl	2394	Bail Trip Lever
0940	Bail Trip Cam Screw	2309	Slider Retainer Screw	2852	Handle Screw Lock
0949	Trigger Screw	2320	Quick-Fire II Trigger	2860	Bail Spring Guide (A)
1008	Handle Lock Washer	2321	Rotor Side Cover	2861	Trigger Cam
1302	Line Roller Screw	2323	Line Roller Bushing	2862	Bail Arm
1366	Drag Click	2324	Bail Spring Guide (B)	2908	Spool Assembly
1370	Lever Click Gear	2325	Sic Ceramic Roller	3102	Handle Assembly
1371	Fightin' Pressure Screw	2329	Bail Trip Lever Screw	3112	Rotor
1373	Drag Programmer	2330	Anti-Reverse Ratchet	3114	Bail Spring Cover
1401	Fightin' Pressure Screw	2331	Anti-Reverse Lock Out	3125	Drag Click Screw
1442	Handle Screw Cap	2332	Bearing Retainer	3130	Main Shaft
1506	Multi-Purpose Screw	2333	Pinion Gear	3142	Bail Assembly
1509	Bail Spring	2334	Anti-Reverse Pawl	3143	Idle Gear
1511	Lever Spring	2335	Anti-Reverse Cam	3144	Side Cover
1520	Anti-Reverse Cam Spring	2336	Worm Bearing (front)	3145	Body