

EXPLODED PARTS VIEW

# SHIMANO®

## 1991 REPAIR MANUAL

Shimano American Corporation, One Shimano Dr.  
Irvine, CA 92718

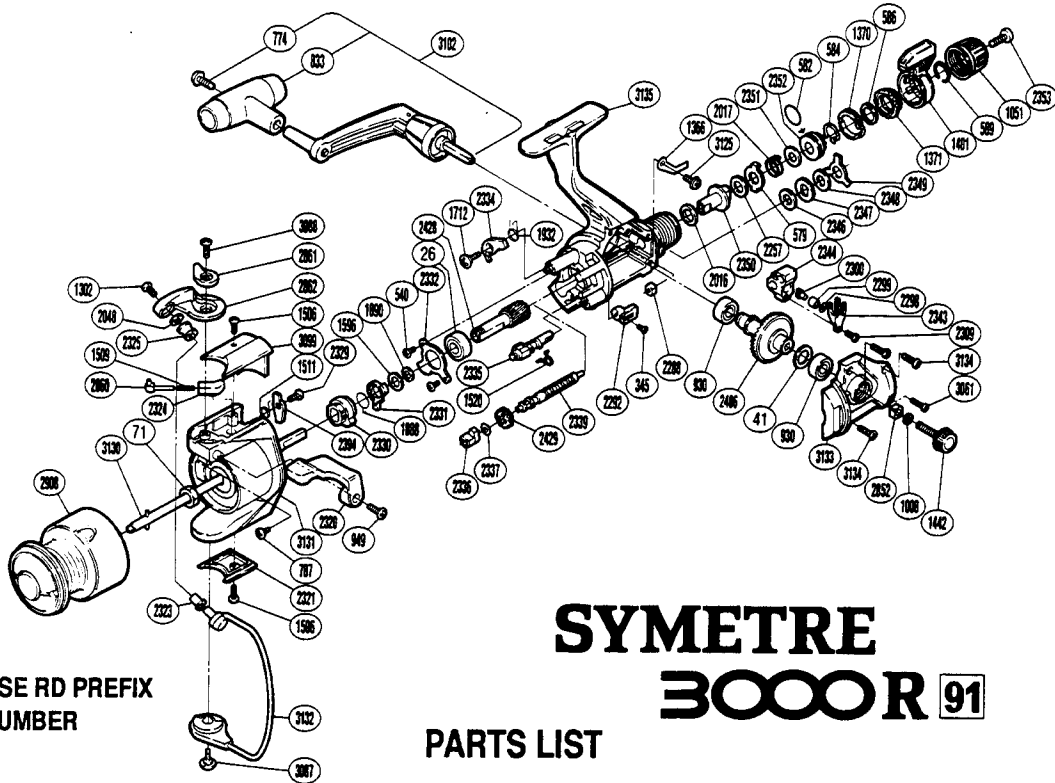

# SYMETRE 3000R 91

TO ORDER: USE RD PREFIX  
WITH PART NUMBER

### PARTS LIST

RD #	DESCRIPTION	RD #	DESCRIPTION	RD #	DESCRIPTION
0026	Ball Bearing	1888	Anti-Reverse Lock Out Spring	2346	Drag Washer "C2" (white)
0041	Drive Gear Washer	1890	Bushing Washer	2347	Click Gear
0071	Rotor Nut	1932	Anti-Reverse Pawl Spring	2348	Drag Washer "C1"
0345	Anti-Reverse Lever Screw	2016	Drag Washer "H2" (white)	2349	Eared Washer "B"
0540	Bearing Retainer Screw	2017	Drag Coil Spring	2350	Drag Shaft
0579	Eared Washer "B"	2048	Line Roller Washer	2351	Drag Spring Washer
0582	"O" Ring	2257	Drag Washer "H1"	2352	Pressure Screw
0584	Hold Click Spring	2288	Worm Bearing (rear)	2353	Drag Programmer Screw
0586	Fightin' Pressure Screw Washer	2292	Anti-Reverse Lever	2394	Bail Trip Lever
0589	Lever Hold Spring	2298	Spacer	2406	Drive Gear
0774	Handle Knob Screw	2299	Oscillating Slider Bushing	2428	Pinion Gear
0787	Nut Lock Screw	2300	Oscillating Pawl	2429	Idle Gear
0833	Handle Knob	2309	Slider Retainer Screw	2852	Handle Screw Lock
0930	Ball Bearing	2320	Quick-Fire II Trigger	2860	Bail Spring Guide "A"
0949	Trigger Screw	2321	Rotor Side Cover	2861	Trigger Cam
1008	Handle Lock Washer	2323	Line Roller Bushing	2862	Bail Arm
1051	Drag Programmer	2324	Bail Spring Guide (B)	2908	Spool Assembly
1302	Line Roller Screw	2325	SiC Ceramic Roller	3061	Side Cover Screw (B)
1366	Drag Click	2329	Bail Trip Lever Screw	3087	Bail Trip Cam Screw
1370	Lever Click Gear	2330	Anti-Reverse Ratchet	3088	Bail Arm Screw
1371	Fightin' Pressure Screw	2331	Anti-Reverse Lock Out	3099	Bail Spring Cover
1401	Fightin'/Drag II Lever	2332	Bearing Retainer	3102	Handle Assembly
1442	Handle Screw Cap	2334	Anti-Reverse Pawl	3125	Drag Click Screw
1506	Bail Spring Cover Screw	2335	Anti-Reverse Cam	3130	Main Shaft
1509	Bail Spring	2336	Worm Bearing (front)	3131	Rotor
1511	Lever Spring	2337	Worm Shaft Spacer	3132	Bail Assembly
1520	Anti-Reverse Cam Spring	2339	Worm Shaft	3133	Side Cover
1596	Bushing Washer	2343	Oscillating Slider Retainer	3134	Side Cover Screw (A)
1712	Anti-Reverse Pawl Screw	2344	Oscillating Slider	3135	Body