

AERO® SUSTAIN™  
Spinning Reels

Greatest Spinning  
Reel on Earth

- Dyna-Balance
- Super Stopper Anti-Reverse
- Aluminum-Titanium Aero® Long Spool Design
- AeroWrap™ System
- Aluminum Frame
- Front Drag
- 5.2:1 Gear Ratio
- 6 Stainless Steel Ball Bearings
- 1 Roller Bearing
- Spare Aluminum-Titanium Spool

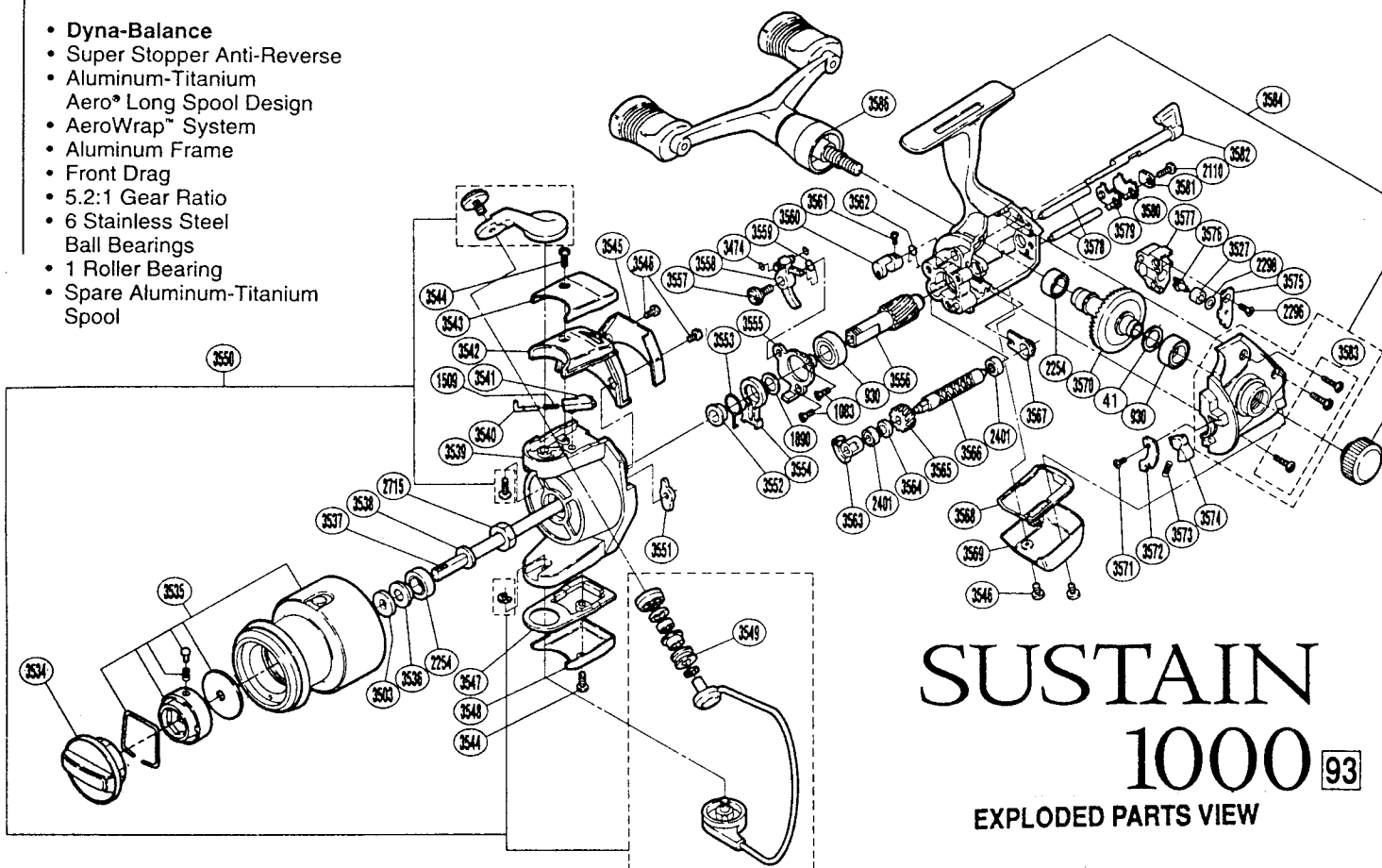

## SUSTAIN 1000 93 EXPLODED PARTS VIEW

MODEL NO.	LINE / CAPACITY	GEAR RATIO	WT. (OZ.)	BEARINGS
SA-1000F	2/270,4/140,6/110	5.2:1	7.9	7

No holds were barred when we set out to make this reel. We stretched our minds and manufacturing capabilities to the limit to make the best operating reel possible. The result is Sustain™, which has unsurpassed levels of precision, smoothness and durability. The price tag is high, but for the connoisseur who's looking for the ultimate, the search is over.

**Precision** - Cold forging, a process where aluminum is pounded into shape with incredibly heavy amounts of weight, is used to make the tapered aluminum spools, drive gear, pinion and idle gears. Cold forged parts are extremely strong since the parts are not stressed by heat and they can be made to extremely tight tolerances. Sustain's body, rotor and side cover are made from die-cast aluminum for strength and lightness. The precision fit between these parts makes Sustain™ run like a fine Swiss watch.

**Smoothness** - 7 (8 - 4000 size) ball bearings support all stress points and ensure exceptionally smooth retrieves. Lightweight titanium is used on the spool lip, oversized ball bearing line roller guide, and the bail wire. This low-friction material lets line pass without resistance and wear. AeroWrap™ creates a two-speed spool oscillation via a worm gear to lay the line on the spool in an even pattern. This pattern minimizes line-to-line friction on the cast to create smoother, further casts. Last, but not least, DynaBalance™ with a double paddle handle eliminates rotor wobble for the smoothest retrieve you've ever felt.

**Durability** - All the materials used to make Sustain™ so precise and smooth have the double effect of also making the reel very durable. It doesn't stop here, however, the Super Stopper™ anti-reverse system reduces handle backplay and the wear resulting from this backplay. A stainless steel rotor protector and rear housing aprons protect the reel. Finally, Sustain™ comes with a cloth reel bag to protect it when it's not in use.

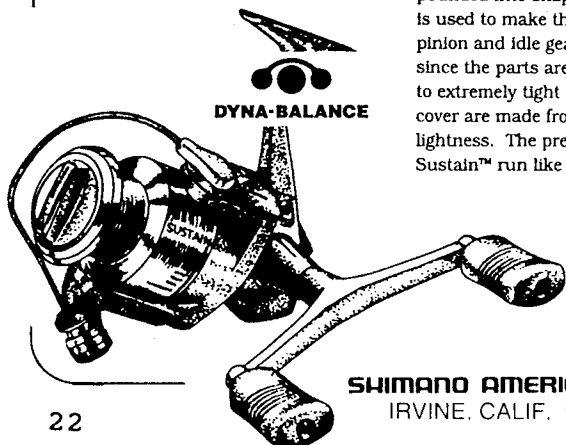

SHIMANO AMERICAN CORPORATION ONE SHIMANO DR., P.O. BOX 19615  
IRVINE, CALIF. 92713-9615 PHONE: 714-951-5003 FAX: 714-951-6212

PART #	DESCRIPTION	*A* INTERCHANGEABILITY	*B* INTERCHANGEABILITY
RD 0041	Drive Gear Washer	BR 0048, RD 1524, MLX0040, X/Z0150.	
RD 0930	Ball Bearing	BR 0047.	
RD 1083	Bearing Retainer Screw		
RD 1509	Ball Spring		
RD 1890	Bushing Washer	TGT0224.	
RD 2110	Worm Shaft Retainer Screw	BR 0685.	
RD 2254	Ball Bearing	BR 0505.	
RD 2296	Slider Retainer Screw	BR 0511.	
RD 2298	Spacer	BR 0513.	
RD 2401	Ball Bearing		
RD 2715	Rotor Nut	BR 0488.	
RD 3474	*O* Ring		
RD 3503	Spool Washer		
RD 3527	Oscillating Slider Bushing		
RD 3534	Drag Knob		
RD 3535	Spool Assembly		
RD 3536	Bearing Bushing		
RD 3537	Main Shaft		
RD 3538	Spool Support		
RD 3539	Rotor		
RD 3540	Ball Spring guide (A)		
RD 3541	Ball Spring Guide (B)		
RD 3542	Ball Spring Cover		
RD 3543	Rotor Protector (A)		
RD 3544	Protector Screw (B)		
RD 3545	Rotor Protector (C)		
RD 3546	Protector Screw (A)		
RD 3547	Rotor Side Shield		
RD 3548	Rotor Protector (B)		
RD 3549	SIC Ceramic Roller		
RD 3550	Ball Assembly		
RD 3551	Ball Trip Lever		
RD 3552	Lock Out Spring Holder		
RD 3553	Anti-Reverse Lock Out Spring		
RD 3554	Anti-Reverse Lock Out		
RD 3555	Bearing Retainer		
RD 3556	Pinion Gear		
RD 3557	Anti-Reverse Pawl Screw		
RD 3558	Anti-Reverse Pawl		
RD 3559	Anti-Reverse Pawl Spring		
RD 3560	Anti-Reverse Cam		
RD 3561	Anti-Reverse Cam Screw		
RD 3562	Anti-Reverse Cam Spring		
RD 3563	Worm Bearing		
RD 3564	Idle Gear Spacer		
RD 3565	Idle Gear		
RD 3566	Worm Shaft		
RD 3567	Bushing		
RD 3568	Rear Shield		
RD 3569	Rear Protector		
RD 3570	Drive Gear		
RD 3571	Trip Cam Screw		
RD 3572	Trip Cam Retainer		
RD 3573	Trip Cam Spring		
RD 3574	Ball Trip Cam		
RD 3575	Oscillating Pawl Cover		
RD 3576	Oscillating Pawl		
RD 3577	Oscillating Slider		
RD 3578	Oscillating Guide		
RD 3579	Worm Shaft Retainer Washer		
RD 3580	Worm Shaft Retainer		
RD 3581	Worm Shaft Retainer Spacer		
RD 3582	Anti-Reverse Lever		
RD 3583	Side Cover Screw		
RD 3584	Body Assembly		
RD 3585	Handle Screw Cap		
RD 3586	Double Paddle Handle Assembly		