

**AERO® SOLSTACE™**  
Spinning Reels

*Stylish and Versatile*

- Dyna-Balance
- Aluminum Aero® Long Spool Design
- Front Drag or Rear Drag
- XT-7 Composite Frame
- 5.2:1 Gear Ratio
- 2 Stainless Steel Ball Bearings
- 1 Roller Bearing
- Spare Graphite Spool

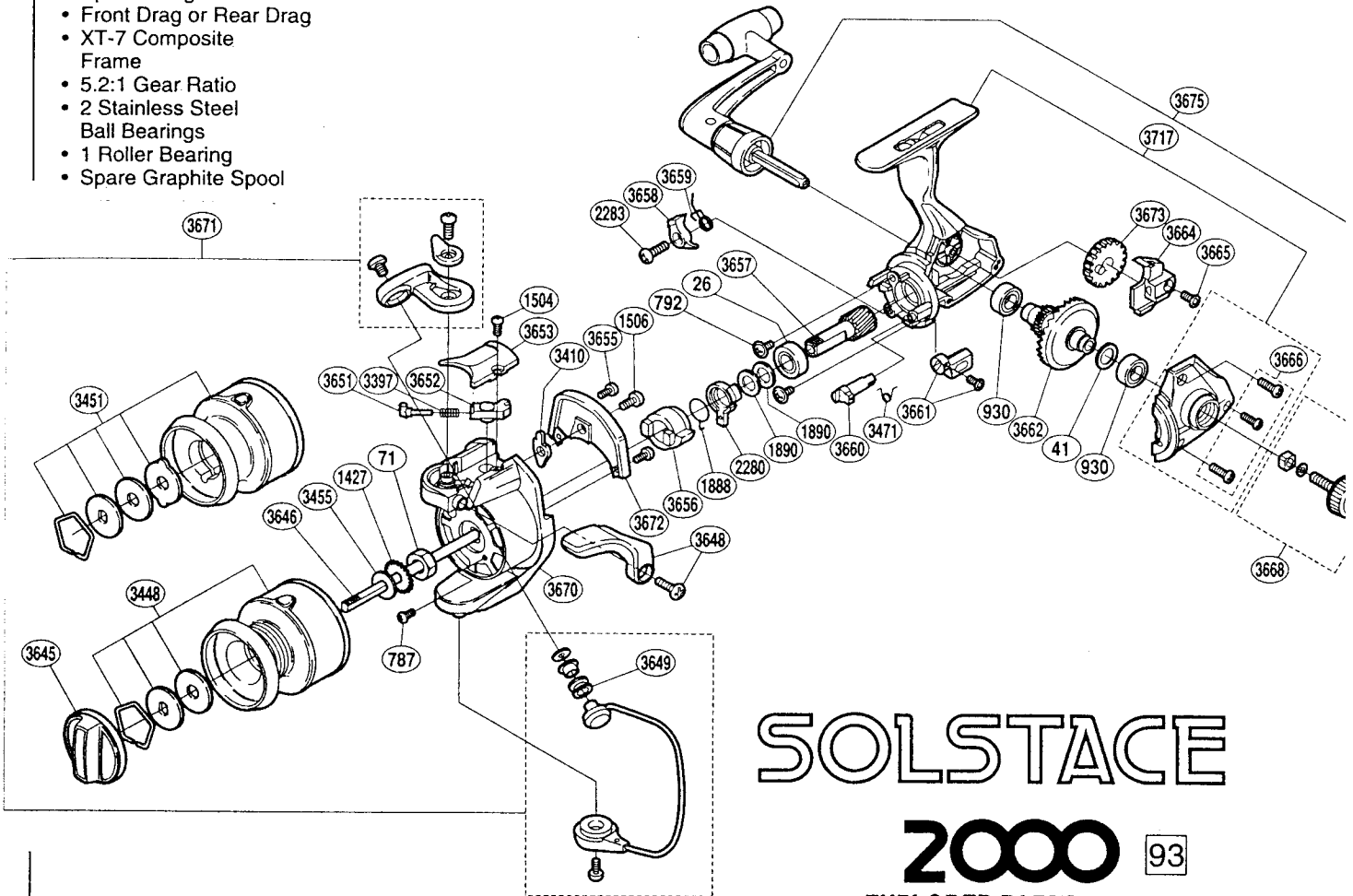

# SOLSTACE

## 2000 93

### EXPLODED PARTS VIEW

MODEL NO.	LINE / CAPACITY	GEAR RATIO	WT. (OZ.)	BEARINGS
SO-2000FA	6/170,8/120,10/100	5.2:1	9.1	3

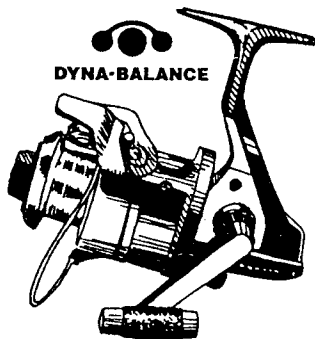

The versatile Solstace™ does everything well. First, and foremost, it's great for sensing fish. The smoothness created by DynaBalance™ and a 3 stainless steel ball bearing drive train lets one feel faint nibbles, that until now went undetected. Second, Solstace™ goes the distance. A drive train with solid gearing and three stainless steel ball bearings at the most critical stress points ensures several years of faithful service. Third, the versatile 5.2:1 gear ratio provides a good balance between high speed land power. The customer wanting a reliable, quality reel will be pleased with the Solstace™.

## SO-2000FA

PART #	DESCRIPTION	"A" INTERCHANGEABILITY	"B" INTERCHANGEABILITY
RD 0026	Ball Bearing	BNT0807, BR 0037, KXB0028, MLX0025, TGT0223, TLD0123, TT 0117	
RD 0041	Drive Gear Washer	BR 0049, RD 1524, MLX0040, X/Z0150	
RD 0071	Rotor Nut	BR 0010, KXB0073, MLX0096	
RD 0787	Nut Lock Screw	BNT0696, BR 0278	RD 1111
RD 0792	Bearing Retainer Screw	BR 0035	RD 0358, TGT0005
RD 0930	Ball Bearing	BR 0047	
RD 1427	Spool Support	BR 0435A, X/Z0089	
RD 1504	Ball Spring Cover Screw		RD 1891
RD 1506	Bail Trip Lever Screw	BR 0470, BR 0539	BNT0689, BR 0066, MCR0021, TGT0068, TLD0056, TT 0187, RD 0540, RD 3088
RD 1888	Anti-Reverse Lock Out Spring		
RD 1890	Bushing Washer	TGT0224	
RD 2280	Anti-Reverse Lock Out		
RD 2283	Anti-Reverse Pawl Screw	BR 0557	
RD 3397	Ball Spring		
RD 3410	Bail Trip Lever		
RD 3448	Spool Assembly (aluminum)		
RD 3451	Spool Assembly (graphite)		
RD 3455	Spool Washer		
RD 3471	Anti-Reverse Cam Spring		
RD 3645	Drag Knob		RD 3391, RD 3453
RD 3646	Main Shaft		
RD 3648	Quick-Fire II Trigger Assembly		RD 3394
RD 3649	Line Roller		
RD 3651	Bail Spring Guide (A)		
RD 3652	Bail Spring Guide (B)		
RD 3653	Bail Spring Cover		RD 3702, RD 3722
RD 3655	Cover Screw		RD 3402
RD 3656	Anti-Reverse Ratchet		
RD 3657	Pinion Gear		
RD 3658	Anti-Reverse Pawl		
RD 3659	Anti-Reverse Pawl Spring		
RD 3660	Anti-Reverse Cam		
RD 3661	Anti-Reverse Lever Assembly		
RD 3662	Drive Gear		
RD 3664	Oscillating Slider		
RD 3665	Slider Retainer Screw		
RD 3666	Side Cover Screw		RD 3404, RD 3704, RD 3724, RD 3759
RD 3668	Handle Screw Cap Assembly		RD 3406
RD 3670	Rotor		RD 3706, RD 3727
RD 3671	Bail Assembly		RD 3707
RD 3672	Counterbalance Cover		RD 3708, RD 3729
RD 3673	Oscillating Gear		
RD 3675	Handle Assembly		
RD 3717	Body Assembly		