

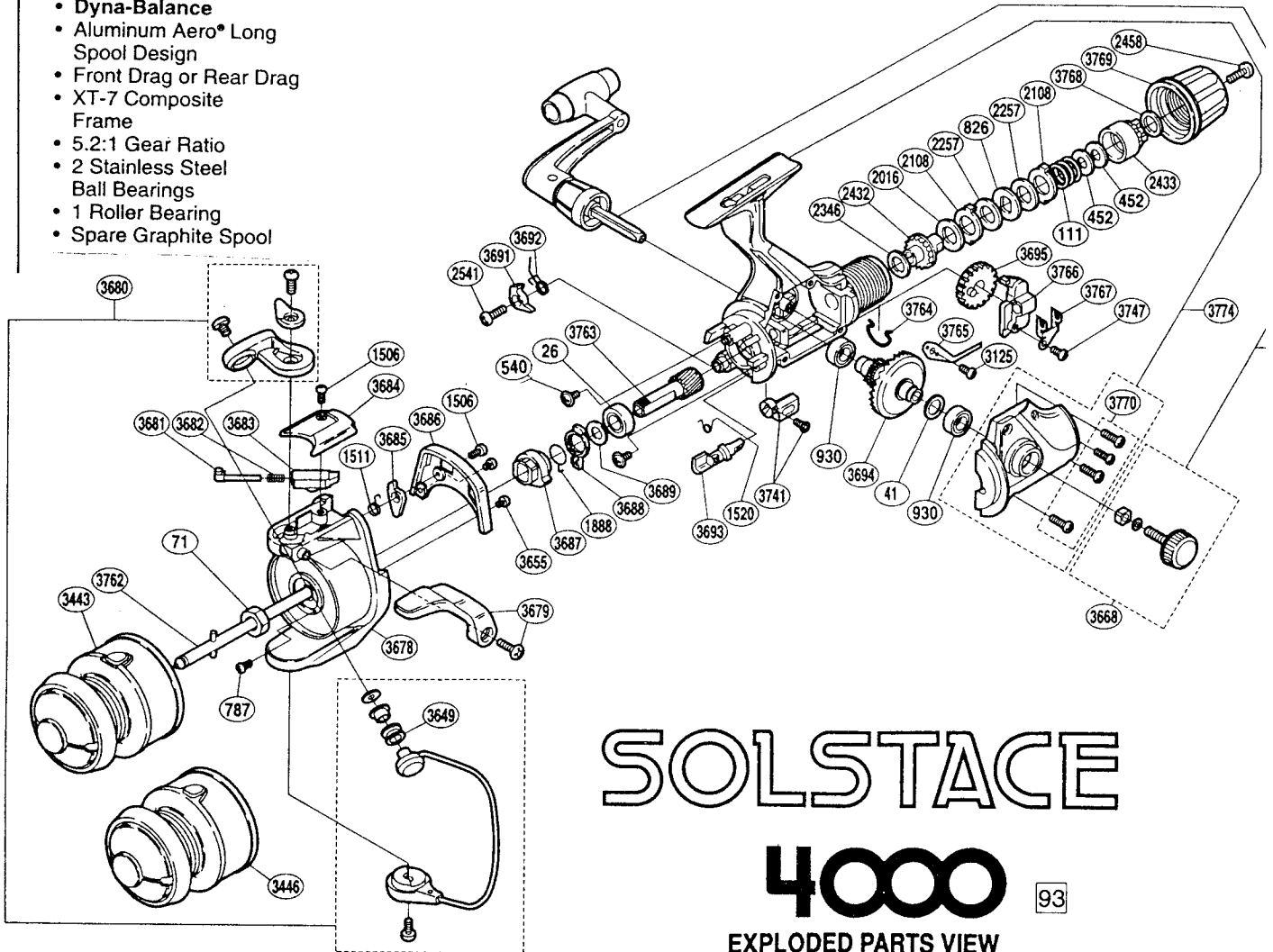

AERO® SOLSTACE™
Spinning Reels

Stylish and Versatile

- Dyna-Balance
- Aluminum Aero® Long Spool Design
- Front Drag or Rear Drag
- XT-7 Composite Frame
- 5.2:1 Gear Ratio
- 2 Stainless Steel Ball Bearings
- 1 Roller Bearing
- Spare Graphite Spool



SOLSTACE

4000

93

EXPLODED PARTS VIEW

MODEL NO.	LINE / CAPACITY	GEAR RATIO	WT. (OZ.)	BEARINGS
SO-4000RA	8/240,10/200,12/160	5.2:1	12.4	3

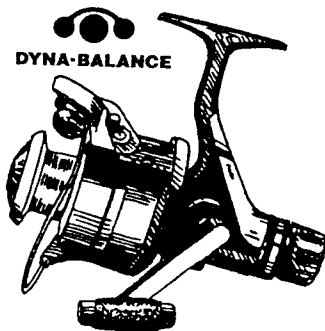

The versatile Solstace™ does everything well. First, and foremost, it's great for sensing fish. The smoothness created by DynaBalance™ and a 3 stainless steel ball bearing drive train lets one feel faint nibbles, that until now went undetected. Second, Solstace™ goes the distance. A drive train with solid gearing and three stainless steel ball bearings at the most critical stress points ensures several years of faithful service. Third, the versatile 5.2:1 gear ratio provides a good balance between high speed land power. The customer wanting a reliable, quality reel will be pleased with the Solstace™.

PART #	DESCRIPTION	"A" INTERCHANGEABILITY	"B" INTERCHANGEABILITY
RD 0026	Ball Bearing	BNT0807, BR 0037, KXB0028, MLX0025, TGT0223, TLD0123, TT 0117	
RD 0041	Drive Gear Washer	BR 0049, RD 1524, MLX0040, X/Z0150	
RD 0071	Rotor Nut	BR 0010, KXB0073, MLX0096	
RD 0111	Drag Coil Spring		
RD 0452	Drag Spring Washer	BR 0087	
RD 0540	Bearing Retainer Screw	BNT0689, BR 0066, MCR0021 TGT0068, TLD0056, TT 0187	BR 0470, BR 0539, RD 1506, RD 3088
RD 0787	Nut Lock Screw	BNT0696, BR 0278	RD 1111
RD 0826	Key Washer "A"	BR 0841	
RD 0930	Ball Bearing	BR 0047	
RD 1506	Multi Purpose Screw	BR 0470, BR 0539	BNT0689, BR 0066, MCR0021, TGT0068, TLD0056, TT 0187, RD 0540, RD 3088
RD 1511	Lever Spring		
RD 1520	Anti-Reverse Cam Spring		
RD 1888	Anti-Reverse Lock Out Spring		
RD 2016	Drag Washer "H" (cloth)	BR 0840	
RD 2108	Eared Washer "B"		
RD 2257	Drag Washer "H" (blue)		
RD 2346	Drag Washer "C" (cloth)	BR 0836	
RD 2432	Drag Shaft		
RD 2433	Pressure Screw		
RD 2458	Drag Knob Screw		
RD 2541	Anti-Reverse Pawl Screw		
RD 3125	Drag Click Screw		
RD 3443	Spool Assembly (aluminum)		
RD 3446	Spool Assembly (graphite)		RD 3882
RD 3649	Line Roller		
RD 3655	Cover Screw		RD 3402
RD 3668	Handle Screw Cap Assembly		RD 3406
RD 3678	Rotor		RD 3710, RD 3731
RD 3679	Quick-Fire II Trigger Assembly		RD 3416
RD 3680	Bail Assembly		RD 3711
RD 3681	Bail Spring Guide (A)		
RD 3682	Bail Spring		
RD 3683	Bail Spring Guide (B)		
RD 3684	Bail Spring Cover		RD 3712, RD 3734
RD 3685	Bail Trip Lever		
RD 3686	Counterbalance Cover		RD 3713, RD3735
RD 3687	Anti-Reverse Ratchet		
RD 3688	Anti-Reverse Lock Out		
RD 3689	Bushing Washer		
RD 3691	Anti-Reverse Pawl		
RD 3692	Anti-Reverse Pawl Spring		
RD 3693	Anti-Reverse Cam		
RD 3694	Drive Gear		
RD 3695	Oscillating Gear		
RD 3699	Handle Assembly		
RD 3741	Anti-Reverse Lever Assembly		
RD 3747	Slider Retainer Screw		
RD 3762	Main Shaft		
RD 3763	Pinion Gear		
RD 3764	Hold Click Spring		
RD 3765	Drag Click		
RD 3766	Oscillating Slider		
RD 3767	Oscillating Slider Retainer		
RD 3768	Drag Knob Spacer		
RD 3769	Drag Knob		RD 3875
RD 3770	Side Cover Screw		RD 3697, RD 3714, RD 3736, RD 3795, RD 3876
RD 3774	Body Assembly		