

AERO® SPIREX™  
Spinning Reels

Double Trouble

- Dyna-Balance
- Aluminum Aero® Long Spool Design
- Front Drag or Rear Drag
- XT-7 Composite Frame
- 5.2:1 Gear Ratio
- 3 Stainless Steel Ball Bearings
- 1 Roller Bearing
- Spare Graphite Spool

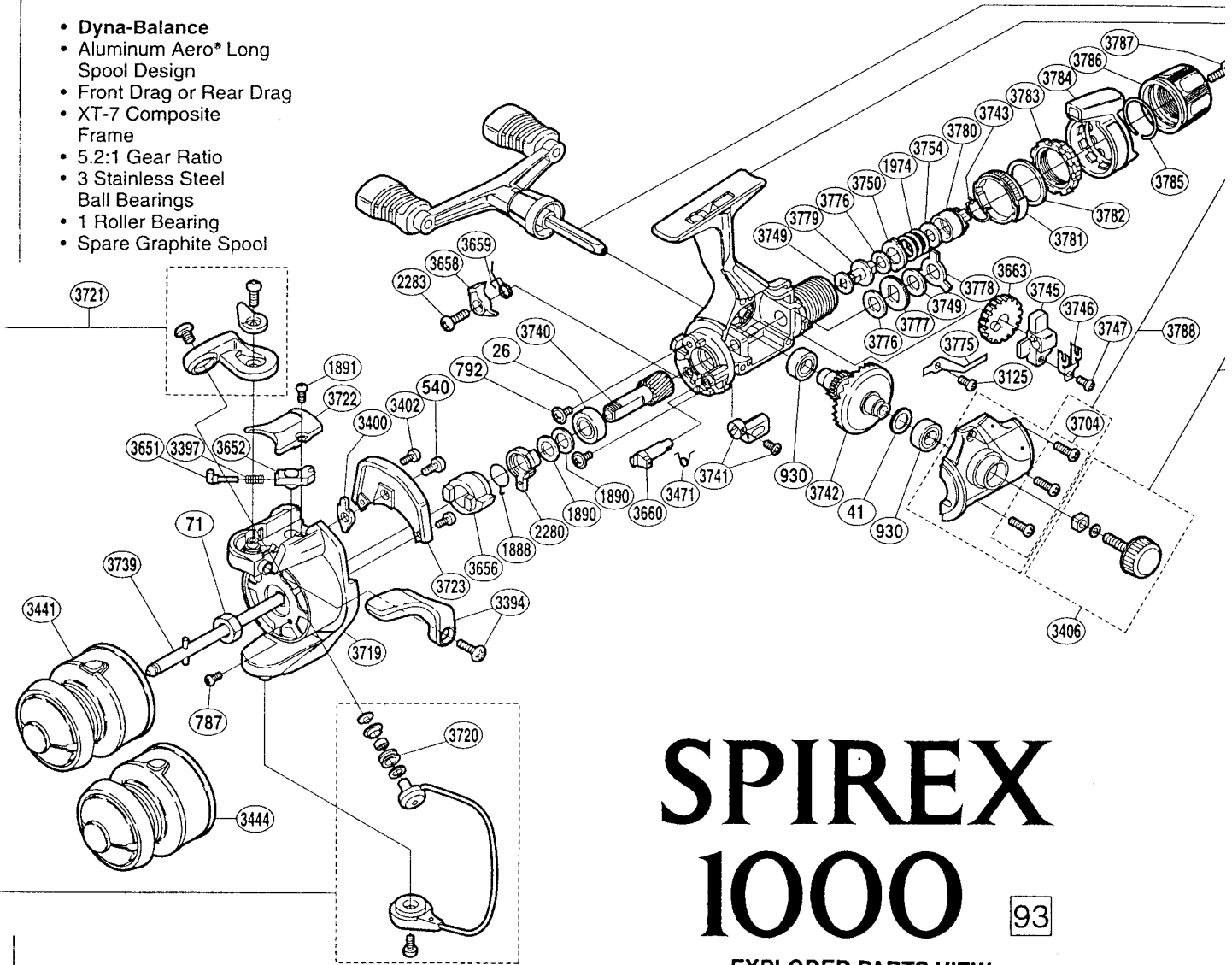

# SPIREX 1000

93

**EXPLODED PARTS VIEW**

MODEL NO.	LINE / CAPACITY	GEAR RATIO	WT. (OZ.)	BEARINGS
SR-1000R	2/270,4/140,6/110	5.2:1	10.0	4



You'll definitely do a double-take when you see Spirex™. It might seem a little strange seeing a double paddle handle on a spinning reel, but just wait until you give it a spin. The double paddle handle enhances the effect of ultra-smooth DynaBalance™ to an even further extreme. We double-dog dare you to find anything smoother.

Spirex™ is loaded with all kinds of great attributes. It has a choice of front or rear drags, 4 ball bearings, an oversized line gear roller, and a spare graphite spool. Spools are long cast design and tapered for improved casting over standard spools. On top of all this, Spirex™ is moderately priced.

## SR-1000R

PART #	DESCRIPTION	*A* INTERCHANGEABILITY	*B* INTERCHANGEABILITY
RD 0026	Ball Bearing	BNT0807, BR 0037, KXB0028, MLX0025, TGT0223, TLD0123, TT 0117	
RD 0041	Drive Gear Washer	BR 0049, RD 1524, MLX0040, X/Z0150	
RD 0071	Rotor Nut	BR 0010, KXB0073, MLX0098	
RD 0540	Ball Trip Lever Screw	BNT0889, BR 0068, MCR0021, TGT0068, TLD0058, TT 0187	BR 0470, BR 0539, RD 1506, RD 3088
RD 0787	Nut Lock Screw	BNT0898, BR 0278	RD 1111
RD 0792	Bearing Retainer Screw	BR 0035	RD 0358, TGT0005
RD 0930	Ball Bearing	BR 0047	
RD 1888	Anti-Reverse Lock Out Spring		
RD 1890	Bushing Washer	TGT0224	
RD 1891	Ball Spring Cover Screw		RD 1504
RD 1974	Drag Coil Spring		
RD 2280	Anti-Reverse Lock Out		
RD 2283	Anti-Reverse Pawl Screw	BR 0557	
RD 3125	Drag Click Screw		
RD 3394	Quick-Fire II Trigger Assembly		RD 3648
RD 3397	Ball Spring		
RD 3400	Ball Trip Lever		
RD 3402	Cover Screw		RD 3655
RD 3406	Handle Screw Cap Assembly		RD 3688
RD 3441	Spool Assembly (aluminum)		
RD 3444	Spool Assembly (graphite)		RD 3845
RD 3471	Anti-Reverse Cam Spring		
RD 3651	Ball Spring Guide (A)		
RD 3652	Ball Spring Guide (B)		
RD 3656	Anti-Reverse Ratchet		
RD 3658	Anti-Reverse Pawl		
RD 3659	Anti-Reverse Pawl Spring		
RD 3660	Anti-Reverse Cam		
RD 3663	Oscillating Gear		
RD 3704	Side Cover Screw		RD 3404, RD 3688, RD 3724, RD 3759
RD 3719	Rotor		RD 3700, RD 3647
RD 3720	Line Roller		
RD 3721	Ball Assembly		
RD 3722	Ball Spring Cover		RD 3653, RD 3702
RD 3723	Counterbalance Cover		RD 3654, RD 3703
RD 3726	Double Paddle Handle Assembly		RD 3681
RD 3739	Main Shaft		
RD 3740	Pinion Gear		
RD 3741	Anti-Reverse Lever Assembly		
RD 3742	Drive Gear		
RD 3743	Hold Click Spring		
RD 3745	Oscillating Slider		
RD 3746	Oscillating Slider Retainer		
RD 3747	Slider Retainer Screw		
RD 3749	Drag Washer *C* (white)		
RD 3750	Eared Washer *B*		
RD 3754	Drag Spring Washer		
RD 3775	Drag Click		
RD 3776	Drag Washer *C* (cloth)		
RD 3777	Click Gear		
RD 3778	Eared Washer *B*		
RD 3779	Drag Shaft		
RD 3780	Pressure Screw Assembly		
RD 3781	Lever Click Gear		
RD 3782	Fightin' Pressure Screw Washer		
RD 3783	Fightin' Pressure Screw		
RD 3784	Fightin' Drag Lever		RD 3895
RD 3785	Lever Hold Spring		
RD 3786	Drag Programmer		RD 3898
RD 3787	Drag Programmer Screw		BR 0814, RD 3758
RD 3788	Body Assembly		