

AERO®STRADIC™  
Spinning Reels

*Stratoradical*

- **Dyna-Balance**
- Super Stopper Anti-Reverse
- Aluminum Aero® Long Spool Design
- AeroWrap™ System
- XT-7 Composite Frame
- Front Drag
- 6:1 Gear Ratio (4000 model - 6.2:1)
- 4 Stainless Steel Ball Bearings
- 1 Roller Bearing
- Spare Aluminum Spool

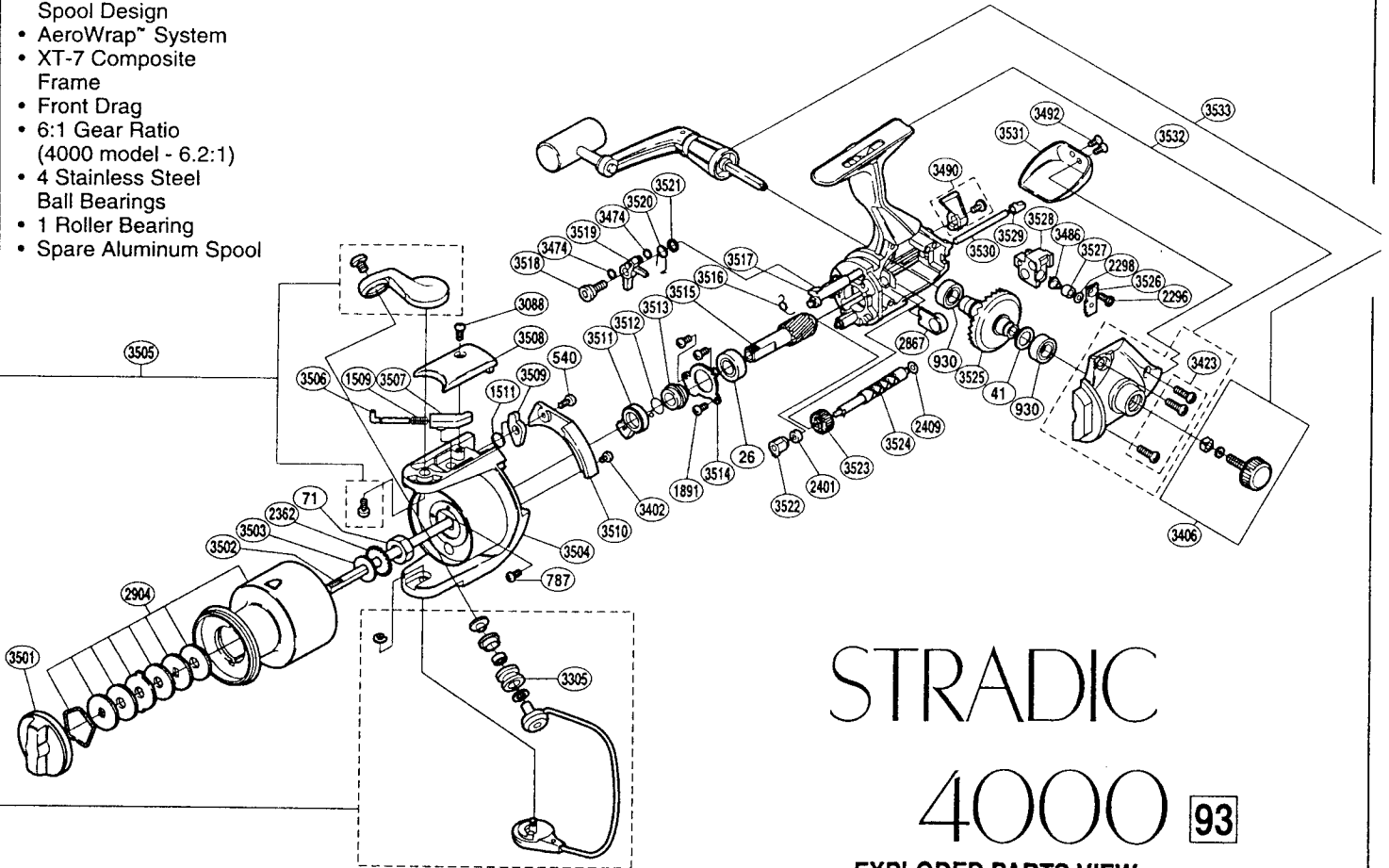

# STRADIC 4000 93

**EXPLODED PARTS VIEW**

MODEL NO.	LINE / CAPACITY	GEAR RATIO	WT. (OZ.)	BEARINGS
ST-4000FB	8/240,10/200,12/160	6.2:1	12.0	5

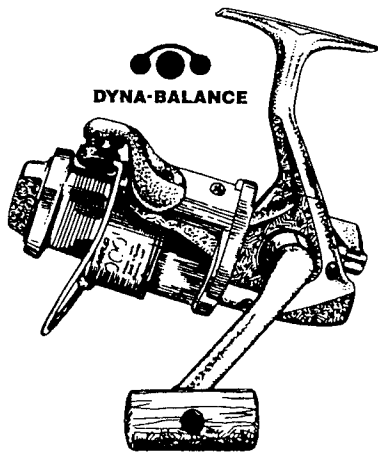

A good thing has just gotten better! Stradic™ has been redesigned. Over the past two years Stradic™ became known for it's exceptional smoothness and appearance. If you liked it then, you should really like it now.

How has Stradic™ been so greatly improved? Most prominently, Stradic™ now has DynaBalance™, which eliminates rotor wobble to create the smoothest retrieves you've ever experienced. On appearance, just take a look at Stradic's picture. Hooksets are quicker with the new Super Stopper™ anti-reverse. Not changing - Stradic™ still features a spare aluminum spool, AeroWrap™, an oversized ball bearing roller line guide, and fast gear ratios.

PART #	DESCRIPTION	"A" INTERCHANGEABILITY	"B" INTERCHANGEABILITY
RD 0026	Ball Bearing	BNT0807, BR 0037, KCB0028, MLX0025, TGT0223, TLD0123, TT 0117	
RD 0041	Drive Gear Washer	BR 0049, RD 1524, MLX0040, X/Z0150	
RD 0071	Rotor Nut	BR 0010, KCB0073, MLX0098	
RD 0540	Ball Trip Lever Screw	BNT0889, BR 0086, MCR0021, TGT0068, TLD0056, TT 0187	BR 0470, BR 0539, RD 1506, RD 3088
RD 0787	Nut Lock Screw	BNT0896, BR 0278	RD 1111
RD 0930	Ball Bearing	BR 0047	
RD 1509	Ball Spring		
RD 1511	Lever Spring		
RD 1891	Bearing Retainer Screw		RD 1504
RD 2296	Slider Retainer Screw	BR 0511	
RD 2298	Spacer	BR 0513	
RD 2362	Spool Support	BR 0532	
RD 2401	Ball Bearing		
RD 2409	Worm Shaft Spacer		
RD 2867	Bushing		
RD 2904	Spool Assembly		
RD 3088	Ball Spring Cover Screw		BNT0889, BR 0086, MCR0021, RD 0540, TGT0068, TLD0056, TT 0187, BR 0470, BR 0539, RD 1506
RD 3305	SiC Ceramic Roller		
RD 3402	Cover Screw		RD 3655
RD 3406	Handle Screw Cap Assembly		RD 3668
RD 3423	Slide Cover Screw		
RD 3474	O' Ring		
RD 3486	Oscillating Pawl		
RD 3490	Anti-Reverse Lever Assembly		
RD 3492	Rear Protector Screw		
RD 3501	Drag Knob		RD 3414, RD 3678
RD 3502	Main Shaft		
RD 3503	Spool Washer		
RD 3504	Rotor		RD 3799
RD 3505	Ball Assembly		RD 3800, RD 3817
RD 3506	Ball Spring Guide (A)		
RD 3507	Ball Spring Guide (B)		
RD 3508	Ball Spring Cover		RD 3801
RD 3509	Ball Trip Lever		
RD 3510	Counterbalance Cover		RD 3802
RD 3511	Anti-Reverse Lock Out		
RD 3512	Anti-Reverse Lock Out Spring		
RD 3513	Lock Out Spring Holder		
RD 3514	Bearing Retainer		
RD 3515	Pinion Gear		
RD 3516	Anti-Reverse Cam Spring		
RD 3517	Anti-Reverse Cam		
RD 3518	Anti-Reverse Pawl Screw		
RD 3519	Anti-Reverse Pawl		
RD 3520	Anti-Reverse Pawl Spring		
RD 3521	Anti-Reverse Pawl Spacer		
RD 3522	Worm Bearing		
RD 3523	Idle Gear		
RD 3524	Worm Shaft		
RD 3525	Drive Gear		
RD 3526	Oscillating Pawl Cover		
RD 3527	Oscillating Slider Bushing		
RD 3528	Oscillating Slider		
RD 3529	Oscillating Guide Holder		
RD 3530	Oscillating Guide		
RD 3531	Rear Protector		
RD 3532	Body Assembly		
RD 3533	Handle Assembly		