

# QUANTUM 310MG

DISCONTINUED

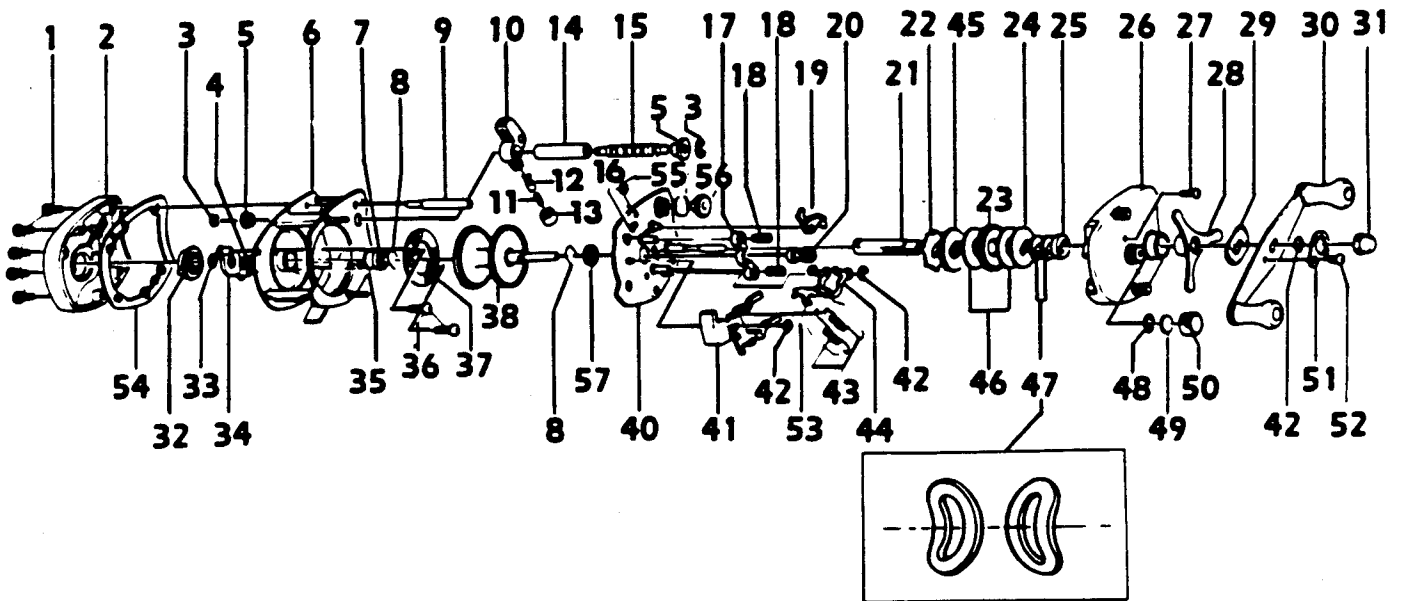

| Key No. | Part No. | Description            | Price | Key No. | Part No. | Description            | Price |
|---------|----------|------------------------|-------|---------|----------|------------------------|-------|
|         | CX4000   | SPARE PARTS W/WRENCH   | 3.69  | 28      | NX4663   | STAR DRAG              | 5.21  |
|         | NX4100   | LEVEL WIND HOOD        | 4.85  | 29      | CX4660   | HANDLE WASHER          | .36   |
|         | T130     | WRENCH                 | 2.59  | 30      | NX4701   | HANDLE ASSY.           | 6.14  |
| 1       | LX4102   | RIGHT SIDE PLATE SCR.  | .99   | 31      | NX4702   | HANDLE NUT             | .91   |
| 2       | NX4101   | LEFT SIDE PLATE        | 7.99  | 32      | NX4303   | MAGNETIC CONTROL DIAL  | 1.23  |
| 3       | CX4152   | WORM SHAFT RETAINER    | .31   | 33      | CX4250   | O RING                 | .49   |
| 4       | CX4301   | MAGNET RET. SPRING     | .36   | 34      | CX4261   | MAGNET RET. SUPPORT    | 1.46  |
| 5       | CX4156   | WORM GUARD BUSHING     | .62   | 35      | CX4255   | SPOOL TENSION SHIM A   | .36   |
| 6       | NX4051   | FRAME                  | 21.49 | 36      | CX4602   | MAGNET RETAINER SCREW  | .62   |
| 7       | BX4156   | SPOOL SHAFT BUSHING    | 2.69  | 37      | CX4257   | MAGNET RETAINER        | 8.59  |
| 8       | CX4253   | BEARING RETAINER       | .36   | 38      | CX4251   | SPOOL ASSY             | 13.35 |
| 9       | BX4159   | FRAME POST- SILVER     | 1.53  | 40      | NX4351   | SET PLATE              | 18.36 |
| 10      | NX4201   | LINE GUIDE             | 7.55  | 41      | NX4402   | SPOOL RELEASE BUTTON   | 2.64  |
| 11      | CX4203   | LINE GUIDE PAWL SPRING | .36   | 42      | CX4656   | RETAINER CLIP          | .36   |
| 12      | CX4202   | LINE GUIDE PAWL        | 2.21  | 43      | CX4353   | SET PLATE ACT. SPRING  | .36   |
| 13      | CX4204   | PAWL CAP               | .91   | 44      | CX4503-1 | SET PLATE ACTUATOR B   | 1.23  |
| 14      | BX4158   | WORM SHFT GUARD-SILVER | 2.64  | 45      | CX4658-2 | ANTI-REVERSE RATCHET   | 6.89  |
| 15      | CX4151-1 | WORM SHAFT W/O GEAR    | 3.69  | 46      | CX4661   | DRAG WASHER A          | .36   |
| 16      | CX4502   | SPOOL RELEASE SPRING   | .36   | 47      | CX4662   | DRIVE SHAFT SPR. WSHR  | .36   |
| 17      | CX4401   | PINION YOKE            | .62   | 48      | CX4258   | O RING                 | .36   |
| 18      | CX4403   | PINION YOKE SPRING     | .36   | 49      | CX4302   | SPOOL TENSION SHIM B   | .36   |
| 19      | CX4452-1 | DOUBLE ANTI-REV PAWL   | 3.38  | 50      | NX4259   | SPOOL TENSION KNOB     | 2.40  |
| 20      | NX4256   | PINION GEAR            | 9.21  | 51      | LX4703   | HANDLE NUT LOCK        | 1.23  |
| 21      | CX4652   | DRIVE SHAFT            | 3.69  | 52      | LX4704   | HANDLE NUT LOCK SCR.   | .49   |
| 22      | CX4451-1 | RELEASE RATCHET        | 1.23  | 53      | CX4501-1 | SET PLATE ACTUATOR A   | 1.23  |
| 23      | NX4651   | DRIVE GEAR             | 6.14  | 54      | NX4107   | LEFT SIDE PLATE SPACER | 1.84  |
| 24      | CX4659   | DRAG WASHER B          | .62   | 55      | CX4153   | GEAR RETAINING CLIP    | .31   |
| 25      | CX4254   | DRIVE SHFT BUSH        | .62   | 56      | NX4150   | WORM SHAFT GEAR        | 4.31  |
| 26      | OX4103   | RIGHT SIDE PLATE       | 15.89 | 57      | BX4157   | SPOOL SHAFT BUSHING B  | 2.69  |
| 27      | LX4352   | LEFT SIDE CVR SCREW    | .42   |         |          |                        |       |

Prices subject to change without notice. Prices do not include postage and handling. Some parts may not be available.

**PLEASE ORDER BY PART NUMBER**

Rev. 5/93

Zebco Division Brunswick Corporation, Box 270, Tulsa, OK 74101 USA 918-836-5581

