

QUANTUM 381

DISCONTINUED

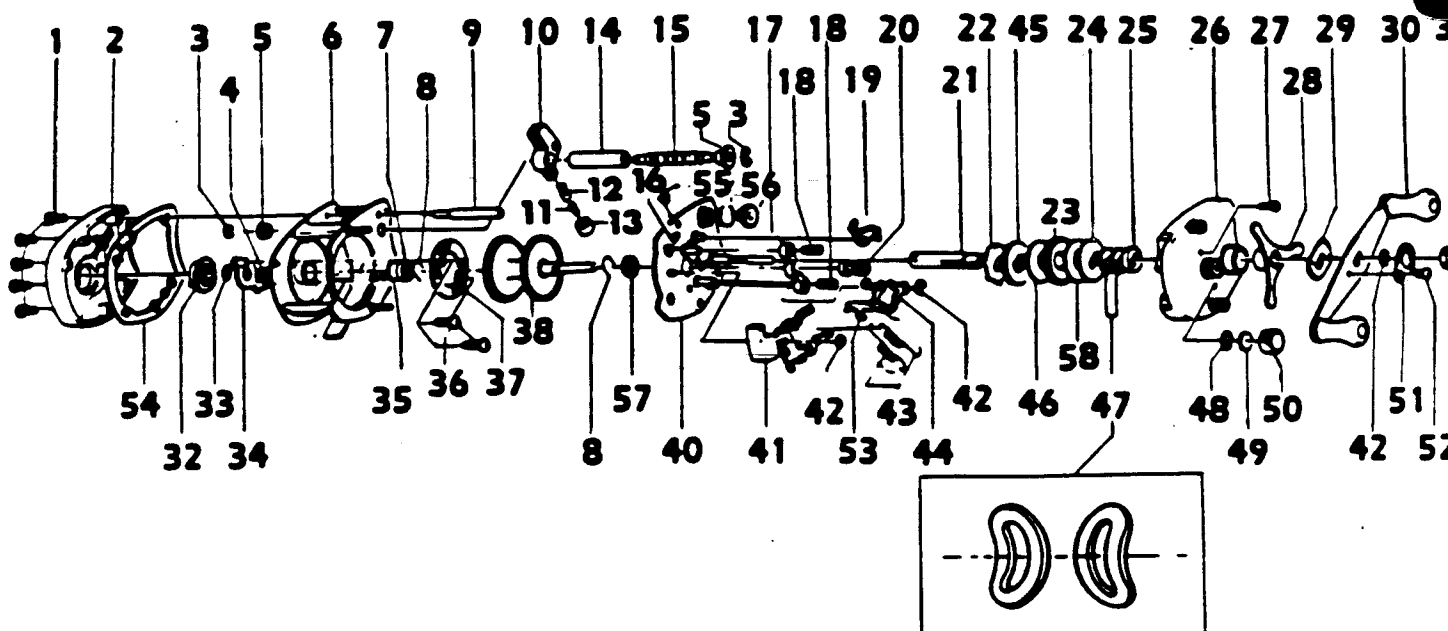

Key No.	Part No.	Description	Price	Key No.	Part No.	Description	Price
	CX4000	SPARE PARTS W/WRENCH	3.69	28	CX4663	STAR DRAG	4.90
	PX4100	LEVEL WIND HOOD	4.85	29	CX4660	HANDLE WASHER	.36
	T130	WRENCH	2.59	30	PX4701	HANDLE	5.53
1	CX4102	LEFT SIDE PLATE SCREW	.36	31	CX4702	HANDLE NUT	.91
2	PX4101	LEFT SIDE PLATE	13.45	32	NX4303	MAGNETIC CONTROL DIAL	1.23
3	CX4152	WORM SHAFT RETAINER	.31	33	CX4250	O RING	.49
4	CX4301	MAGNET RET. SPRING	.36	34	CX4261	MAGNET RET. SUPPORT	1.46
5	CX4156	WORM GUARD BUSHING	.62	35	CX4255	SPOOL TENSION SHIM A	.36
6	PX4051	FRAME	21.49	36	CX4602	MAGNET RETAINER SCREW	.62
7	BX4156	SPOOL SHAFT BUSHING	2.69	37	CX4257	MAGNET RETAINER	8.59
8	CX4253	BEARING RETAINER	.36	38	CX4251	SPOOL ASSY	13.35
9	PX4159	FRAME POST - BLACK	1.84	40	PX4351	SET PLATE	18.36
10	CX4201-1	LINE GUIDE	4.00	41	CX4402	SPOOL RELEASE BUTTON	2.00
11	CX4203	LINE GUIDE PAWL SPRING	.36	42	CX4656	RETAINER CLIP	.36
12	CX4202	LINE GUIDE PAWL	2.21	43	CX4353	SET PLATE ACT. SPRING	.36
13	CX4204	PAWL CAP	.91	44	CX4503-1	SET PLATE ACTUATOR B	1.23
14	CX4158	WORM SHAFT GUARD-BLK	2.64	45	PX4658-1	ANTI-REVERSE RATCHET	6.45
15	CX4151-1	WORM SHAFT W/O GEAR	3.69	46	PX4661	DRAG WASHER A	.56
16	CX4502	SPOOL RELEASE SPRING	.36	47	CX4662	DRIVE SHAFT SPR. WSHR	.36
17	CX4401	PINION YOKE	.62	48	CX4258	O RING	.36
18	CX4403	PINION YOKE SPRING	.36	49	CX4302	SPOOL TENSION SHIM B	.36
19	CX4452-1	DOUBLE ANTI-REV PAWL	3.38	50	CX4259	SPOOL TENSION KNOB	1.84
20	PX4256	PINION GEAR	10.43	51	CX4703	HANDLE NUT LOCK	.62
21	CX4652	DRIVE SHAFT	3.69	52	CX4704	HANDLE NUT LOCK SCREW	.33
22	CX4451-1	RELEASE RATCHET	1.23	53	CX4501-1	SET PLATE ACTUATOR A	1.23
23	PX4651	DRIVE GEAR	7.37	54	PX4107	LEFT SIDE PLATE SPACER	1.84
24	PX4659	DRAG WASHER B	1.23	55	CX4153	GEAR RETAINING CLIP	.31
25	CX4254	DRIVE SHFT BUSH	.62	56	PX4150	WORM SHAFT GEAR	4.85
26	PX4103	RIGHT SIDE PLATE	15.89	57	BX4157	SPOOL SHAFT BUSHING B	2.69
27	CX4352	RIGHT SIDE COVER SCREW	.36	58	PX4664	DRAG WASHER C	.56

Prices subject to change without notice. Prices do not include postage and handling. Some parts may not be available.

PLEASE ORDER BY PART NUMBER

Rev. 5/93

Zebco Division Brunswick Corporation, Box 270, Tulsa, OK 74101 USA 918-836-5581

BC
BRUNSWICK