



# BR150 / BR350 / BR350A

## SPECIFICATIONS :

Hvy FW / Med. Lt. SW  
 225 yds / 12 lb Line Capacity  
 Ball Bearings:  
 BR150 - 1 B.B.  
 BR350 / BR350A - 3 B.B.  
 4.8:1 Gear Ratio  
 13.8 oz.

## FEATURES :

Front Drag  
 Balanced Rotor  
 Oversized Twist Reducer Line Roller  
 POSI-Loc Selective Anti-Reverse (15 stop)  
 Aluminum Long Stroke Max-Cast Spool  
 Color: BR150 / 350 - Light Tan  
 BR350A - Dark Grey

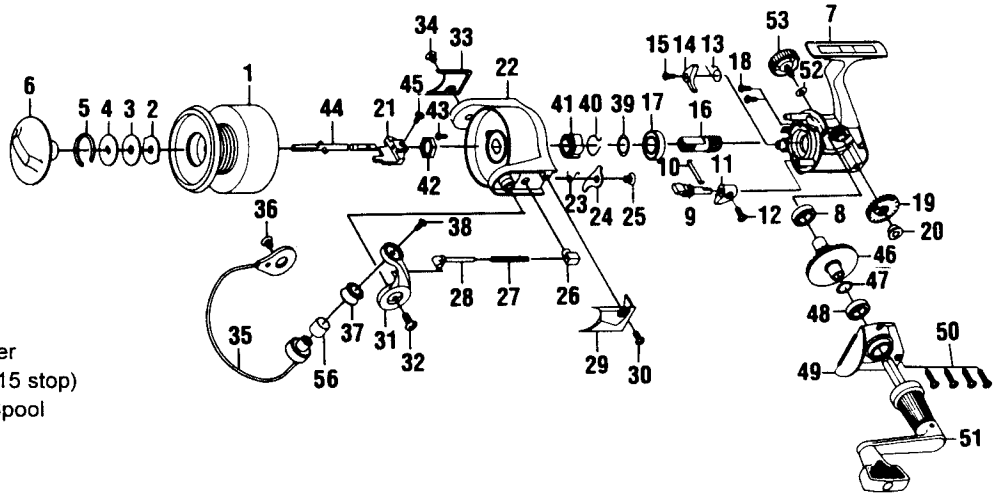

Key No.	Part No.	DESCRIPTION	Price	Key No.	Part No.	DESCRIPTION	Price
1	BH321-31	Spool Assembly	8.22	29	N / A	BH046-33 Arm Lever Cover (BR350A)	2.22
1	N / A	BH321-37 Spool Assembly (BR350A)	8.22	30	BH085-11	← Cover Screw	0.47
2	BH081-21	← Spool Washer "A"	0.59	30	N / A	BH085-13 Cover Screw (BR350A)	0.47
3	BH033-21	← Spool Washer "B"	0.64	31	BH007-12	← Arm Lever	3.18
4	BH080-31	← Spool Washer "D"	0.96	31	N / A	BH007-13 Arm Lever (BR350A)	3.18
5	BH038-21	← Drag Retainer	1.01	32	BH044-11	← Arm Lever Screw	0.64
6	BH332-31	← Drag Knob Assembly	3.29	32	N / A	BH044-13 Arm Lever Screw (BR350A)	0.64
6	N / A	BH332-36 Drag Knob Assembly (BR350A)	3.29	33	BH024-31	← Bail Holder Cover	1.65
7	BH001-31	BH001-32 Body (before A8 date code)	5.57	33	N / A	BH024-33 Bail Holder Cover (BR350A)	1.65
7	BH001-38	BH001-37 Body (after A8 date code)	5.57	34	BH085-11	← Cover Screw	0.64
7	N / A	BH001-39 Body (BR350A)	5.57	34	N / A	BH085-13 Cover Screw (BR350A)	0.64
8	BH027-11	N / A	0.77	35	BH347-32	← Bail Assembly	5.73
8	N / A	BH027-12 Ball Bearing	6.58	35	N / A	BH347-37 Bail Assembly (BR350A)	5.73
9	BH090-11	← Stopper Cam	1.60	36	BH044-11	← Bail Holder Screw	0.64
10	BH089-11	← Stopper Cam Spring	0.96	36	N / A	BH044-13 Bail Holder Screw (BR350A)	0.64
11	BH059-11	← Stopper Lever	1.08	37	BH004-12	← Line Roller	3.19
11	N / A	BH059-14 Stopper Lever (BR350A)	1.08	38	BH108-11	← Bail Screw	0.64
12	BH135-11	← Stopper Lever Screw	0.64	38	N / A	BH108-13 Bail Screw (BR350A)	0.64
12	N / A	BH135-12 Stopper Lever Screw (BR350A)	0.64	39	BH110-31	← Bearing Washer	0.54
13	BH061-11	← Stopper Spring	0.46	40	BH086-31	← Silent Spring	1.65
14	BH063-32	← Stopper	1.49	41	BH060-32	← Ratchet Gear	1.75
15	BH077-11	← Stopper Screw	0.64	42	BH006-31	← Rotor Nut	1.11
16	BH011-31	← Pinion Gear (before A8 date code)	2.76	43	BH094-11	← Rotor Nut Lock Screw	0.94
16	BH011-32	← Pinion Gear (after A8 & BR350A)	2.76	44	BH315-31	← Main Shaft Assembly	6.21
17	BH028-31	← Ball Bearing (before A8 date code)	8.70	45	BH100-11	← Main Shaft Screw	0.64
17	BH028-32	← Ball Bearing (after A8 & BR350A)	8.70	46	BH012-31	← Driver Gear	2.49
18	BH041-11	← Bearing Screw	0.64	47	BH026-11	← Adjust Washer	0.69
19	BH053-31	← O/S Gear	1.53	48	BH027-11	N / A	0.77
20	BH158-11	← O/S Gear Bushing	0.98	48	N / A	BH027-12 Ball Bearing	6.58
21	BH025-11	← O/S Slider	2.66	49	BH023-31	BH023-32 Body Cover	3.45
22	BH009-31	BH009-32 Rotor	5.84	49	N / A	BH023-37 Body Cover (BR350A)	3.45
22	N / A	BH009-37 Rotor (BR350A)	5.84	50	BH057-11	← Body Cover Screw	0.64
23	BH049-31	← Kick Lever Spring	0.96	50	N / A	BH057-13 Body Cover Screw (BR350A)	0.64
24	BH019-31	← Kick Lever	1.91	51	BH318-31	← Handle Assembly	6.37
25	BH136-11	← Kick Lever Screw	0.64	51	N / A	BH318-37 Handle Assembly (BR350A)	6.37
26	BH020-11	← Spring Holder	0.96	52	BH105-11	← Handle Cap Washer	0.47
27	BH022-31	← Arm Lever Spring	0.64	53	BH073-31	← Handle Screw Cap	2.34
28	BH031-31	← Spring Shaft	0.96	53	N / A	BH073-33 Handle Screw Cap (BR350A)	2.34
29	BH046-31	← Arm Lever Cover	2.22	56	BH016-11	← Line Roller Bushing	1.06

= These parts are not interchangeable with parts from different date code (ie., use Pinion Gear before A8 along with Ball Bearing and Body before A8)

<b>MODEL</b>	<b>EFFECTIVE DATE OF</b>	
INTRODUCED : 1997	PARTS LIST/DIAGRAM: Sept. '98	DISCONTINUED : N / A

Prices subject to change without notice. Prices do not include postage and handling.

PLEASE ORDER BY PART NUMBER

Zebco, P.O. Box 270, Tulsa, Ok. 74101; 918-831-6965 Phone or 800-FIXREEL (349-7335) FAX

