

# QUANTUM

# BR180A/BR380A

### SPECIFICATIONS:

Heavy Saltwater  
 330 yds/20 lb Line Capacity  
 4.8:1 Gear Ratio  
 21.1 oz. Weight

**BR180A:** 1 Ball Bearing

**BR380A:** 3 Ball Bearing

### FEATURES:

Oversized Front Drag and Center Shaft  
 Right/Left Interchangeable Handle

Magnum Gears  
 Selective Anti-Reverse  
 Internal Bail Trip

Oversized "Twist Reducer" Line Roller

Aluminum Long Stroke

Color: BR180A - Light Tan  
 BR380B - Dark Grey

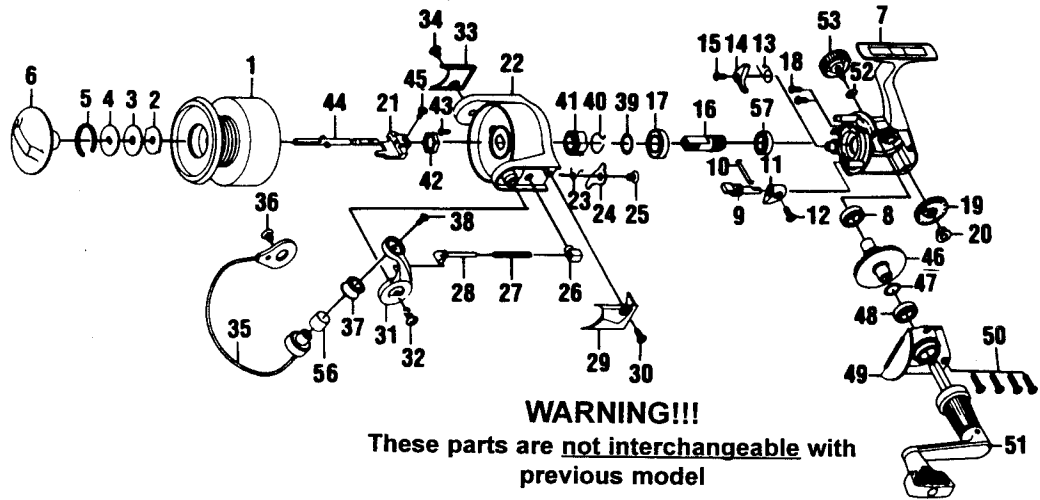

### Distinguishing Features:

The OLD model has an Anti-Reverse slide switch on the very back of reel. The NEW model has an Anti-Reverse lever on the bottom of reel just behind rotor.

### Special Handling Instructions:

If specific model version cannot be identified for parts order, send one of each part (for old and new model) and charge for one part.

| Key No. | BR180A Part No. | BR380B Part No. | Description         | Price | Key No. | BR180A Part No. | BR380B Part No. | Description          | Price |
|---------|-----------------|-----------------|---------------------|-------|---------|-----------------|-----------------|----------------------|-------|
| 1       | BH321-72        | BH321-73        | Spool Assembly      | 11.89 | 29      | BH046-72        | BH046-73        | Arm Lever Cover      | 1.03  |
| 2       | BH081-21        | BH081-21        | Spool Washer "A"    | .59   | 30      | BH085-11        | BH085-13        | Cover Screw          | .47   |
| 3       | BH033-21        | BH033-21        | Spool Washer "B"    | .64   | 31      | BH007-62        | BH007-61        | Arm Lever            | 1.60  |
| 4       | BH080-31        | BH080-31        | Spool Washer "D"    | .96   | 32      | BH044-11        | BH044-13        | Arm Lever Screw      | .64   |
| 5       | BH038-21        | BH038-21        | Drag Retainer       | 1.01  | 33      | BH024-62        | BH024-63        | Bail Holder Cover    | 1.03  |
| 6       | BH332-41        | BH332-46        | Drag Knob Assembly  | 3.34  | 34      | BH085-11        | BH085-13        | Cover Screw          | .64   |
| 7       | BH001-62        | BH001-63        | Body                | 6.70  | 35      | BH347-72        | BH347-71        | Bail Assembly        | 3.19  |
| 8       | BH027-71        | N/A             | Body Bushing        | .77   | 36      | BH044-11        | BH044-13        | Bail Holder Screw    | .64   |
| 8       | N/A             | BH027-61        | Ball Bearing        | 7.96  | 37      | BH004-12        | BH004-12        | Line Roller          | 3.19  |
| 9       | BH090-11        | BH090-11        | Stopper Cam         | 1.60  | 38      | BH108-11        | BH108-13        | Bail Screw           | .42   |
| 10      | BH089-11        | BH089-11        | Stopper Cam Spring  | .96   | 39      | BH110-61        | BH110-61        | Bearing Washer       | 1.28  |
| 11      | BH059-11        | BH059-14        | Stopper Lever       | 1.08  | 40      | BH086-61        | BH086-61        | Silent Spring        | 1.65  |
| 12      | BH135-11        | BH135-12        | Stopper Lever Screw | .64   | 41      | BH060-61        | BH060-61        | Ratchet Gear         | 1.28  |
| 13      | BH061-61        | BH061-61        | Stopper Spring      | 1.44  | 42      | BH006-61        | BH006-61        | Rotor Nut            | 1.28  |
| 14      | BH063-61        | BH063-61        | Stopper             | 1.28  | 43      | BH094-11        | BH094-11        | Rotor Nut Lock Screw | .94   |
| 15      | BH077-61        | BH077-61        | Stopper Screw       | .52   | 44      | BH315-71        | BH315-71        | Main Shaft Assembly  | 3.08  |
| 16      | BH011-61        | BH011-61        | Pinion Gear         | 3.34  | 45      | BH100-61        | BH100-61        | Main Shaft Screw     | .54   |
| 17      | BH028-61        | BH028-61        | Ball Bearing        | 7.96  | 46      | BH012-71        | BH012-71        | Driver Gear          | 3.23  |
| 18      | BH041-61        | BH041-61        | Bearing Screw       | .54   | 47      | BH026-61        | BH026-61        | Adjust Washer        | 1.06  |
| 19      | BH053-61        | BH053-61        | O/S Gear            | 1.65  | 48      | BH027-71        | N/A             | Body Cover Bushing   | .77   |
| 20      | BH158-61        | BH158-61        | O/S Gear Bushing    | .93   | 48      | N/A             | BH027-61        | Ball Bearing         | 7.96  |
| 21      | BH025-61        | BH025-61        | O/S Slider          | 2.17  | 49      | BH023-62        | BH023-63        | Body Cover           | 2.76  |
| 22      | BH009-72        | BH009-73        | Rotor               | 6.90  | 50      | BH057-11        | BH057-13        | Body Cover Screw     | .64   |
| 23      | BH049-71        | BH049-71        | Kick Lever Spring   | .96   | 51      | BH318-62        | BH318-63        | Handle Assembly      | 7.43  |
| 24      | BH019-71        | BH019-71        | Kick Lever          | 1.65  | 52      | BH105-11        | BH105-11        | Handle Cap Washer    | .47   |
| 25      | BH136-61        | BH136-61        | Kick Lever Screw    | .64   | 53      | BH073-31        | BH073-33        | Handle Screw Cap     | 3.23  |
| 26      | BH020-11        | BH020-11        | Spring Holder       | .96   | 56      | BH016-11        | BH016-11        | Line Roller Bushing  | 1.06  |
| 27      | BH022-71        | BH022-71        | Arm Lever Spring    | 1.06  | 57      | BH141-61        | BH141-61        | Pinion Bushing       | .95   |
| 28      | BH031-71        | BH031-71        | Spring Shaft        | .96   |         |                 |                 |                      |       |

|                         |           |   |           |                     |     |
|-------------------------|-----------|---|-----------|---------------------|-----|
| <b>MODEL INTRODUCED</b> | Dec. 1997 | <b>EFFECTIVE DATE OF PARTS LIST/DIAGRAM</b> | Dec. 1997 | <b>DISCONTINUED</b> | N/A |
|-------------------------|-----------|---|-----------|---------------------|-----|

Prices subject to change without notice. Prices do not include postage and handling.

**PLEASE ORDER BY PART NUMBER** Zebco Division Brunswick Corporation, Box 270, Tulsa, OK 74101 USA 918-836-5581

