



# BR140 / BR340 / BR340A

## SPECIFICATIONS :

M FW / Lt SW  
 200 yds / 10 lb Line Capacity  
 Ball Bearings:  
     BR140 - 1 B.B.  
     BR340 / BR340A - 3 B.B.  
 5.7:1 Gear Ratio  
 11.6 oz.

## FEATURES :

Front Drag  
 Balanced Rotor  
 Oversized Twist Reducer Line Roller  
 POSI-Loc Selective Anti-Reverse (15 stop)  
 Aluminum Long Stroke Max-Cast Spool  
 Color: BR140 / 340 - Light Tan  
       BR340A - Dark Grey

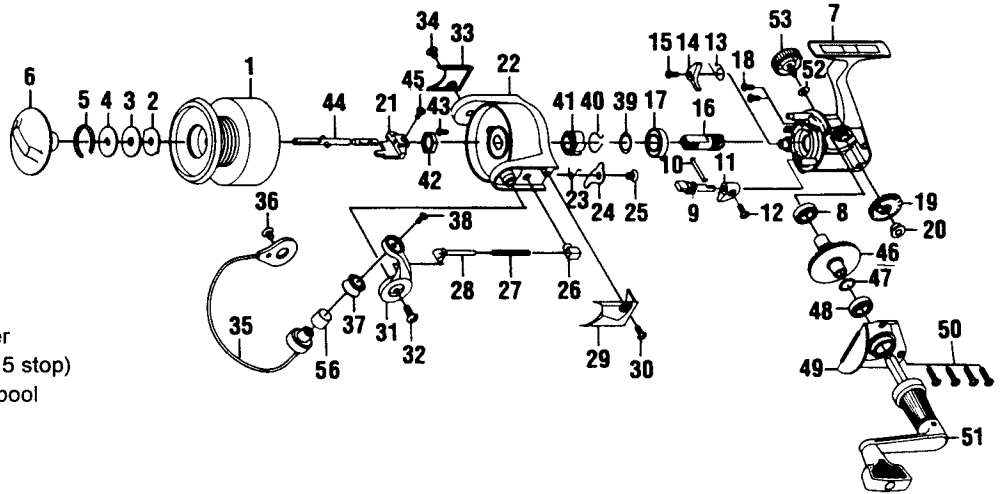

Key No.	Part No.	DESCRIPTION	Price	Key No.	Part No.	DESCRIPTION	Price	
1	BH321-21	Spool Assembly	8.22	29	N / A	Arm Lever Cover (BR340A)	1.43	
1	N / A	Spool Assembly (BR340A)	8.22	30	BH085-11	Cover Screw	0.64	
2	BH081-21	Spool Washer "A"	0.59	30	N / A	Cover Screw (BR340A)	0.47	
3	BH033-21	Spool Washer "B"	0.64	31	BH007-12	Arm Lever	3.18	
4	BH080-21	Spool Washer "D"	0.96	31	N / A	Arm Lever (BR340A)	2.44	
5	BH038-21	Drag Retainer	1.01	32	BH044-11	Arm Lever Screw	0.64	
6	BH332-21	Drag Knob Assembly	3.29	32	N / A	Arm Lever Screw (BR340A)	0.44	
6	N / A	Drag Knob Assembly (BR340A)	3.29	33	BH024-11	Bail Holder Cover	1.65	
7	BH001-21	Body (before A8 date code)	5.57	33	N / A	Bail Holder Cover (BR340A)	0.84	
7	BH001-18	Body (after A8 date code)	5.57	34	BH085-11	Cover Screw	0.64	
7	N / A	Body (BR340A)	5.57	34	N / A	Cover Screw (BR340A)	0.47	
8	BH027-11	Bushing	0.77	35	BH347-22	Bail Assembly	5.73	
8	N / A	Ball Bearing	6.58	35	N / A	Bail Assembly (BR340A)	5.73	
9	BH090-11	Stopper Cam	1.60	36	BH044-11	Bail Holder Screw	0.64	
10	BH089-11	Stopper Cam Spring	0.96	36	N / A	Bail Holder Screw (BR340A)	0.42	
11	BH059-11	Stopper Lever	1.08	37	BH004-12	Line Roller	3.19	
11	N / A	Stopper Lever (BR340A)	1.08	38	BH108-11	Bail Screw	0.64	
12	BH135-11	Stopper Lever Screw	0.64	38	N / A	Bail Screw (BR340A)	0.42	
12	N / A	Stopper Lever Screw (BR340A)	0.64	39	BH110-11	Bearing Washer	0.54	
13	BH061-11	Stopper Spring	0.46	40	BH086-11	Silent Spring	1.65	
14	BH063-12	Stopper	1.49	41	BH060-12	Ratchet Gear	1.75	
15	BH077-11	Stopper Screw	0.64	42	BH006-11	Rotor Nut	1.11	
16	BH011-13	Pinion Gear (before A8 date code)	2.76	43	BH094-11	Rotor Nut Lock Screw	0.64	
16	BH011-14	Pinion Gear (after A8 & BR340A)	2.76	44	BH315-21	Main Shaft Assembly	5.73	
17	BH028-11	Ball Bearing (before A8 date code)	8.70	45	BH100-11	Main Shaft Screw	0.64	
17	BH028-12	Ball Bearing (after A8 & BR340A)	8.70	46	BH012-13	Driver Gear	2.49	
18	BH041-11	Bearing Screw	0.64	47	BH026-11	Adjust Washer	0.69	
19	BH053-21	O/S Gear	1.53	48	BH027-11	N / A	Bushing	0.77
20	BH158-11	O/S Gear Bushing	0.98	48	N / A	Ball Bearing	6.58	
21	BH025-11	O/S Slider	2.66	49	BH023-21	Body Cover	3.45	
22	BH009-21	Rotor	5.30	49	N / A	Body Cover (BR340A)	3.45	
22	N / A	Rotor (BR340A)	5.30	50	BH057-11	Body Cover Screw	0.64	
23	BH049-21	Kick Lever Spring	0.96	50	N / A	Body Cover Screw (BR340A)	0.42	
24	BH019-21	Kick Lever	1.91	51	BH318-11	Handle Assembly	6.37	
25	BH136-11	Kick Lever Screw	0.64	51	N / A	Handle Assembly (BR340A)	6.37	
26	BH020-11	Spring Holder	0.96	52	BH105-11	Handle Cap Washer	0.47	
27	BH022-21	Arm Lever Spring	0.64	53	BH073-11	Handle Screw Cap	2.34	
28	BH031-21	Spring Shaft	0.96	53	N / A	Handle Screw Cap (BR340A)	2.34	
29	BH046-21	Arm Lever Cover	1.43	56	BH016-11	Line Roller Bushing	1.06	

   = These parts are not interchangeable with parts from different date code (ie., use Pinion Gear before A8 along with Ball Bearing and Body before A8)

<b>MODEL</b>	<b>EFFECTIVE DATE OF</b>	
<b>INTRODUCED : 1997</b>	<b>PARTS LIST/DIAGRAM: Sept. '98</b>	<b>DISCONTINUED : N / A</b>

Prices subject to change without notice. Prices do not include postage and handling.

PLEASE ORDER BY PART NUMBER

Zebco, P.O. Box 270, Tulsa, Ok. 74101; 918-831-6965 Phone or 800-FIXREEL (349-7335) FAX

