

# GSS10 / GSS20 / GSS30 Diagram

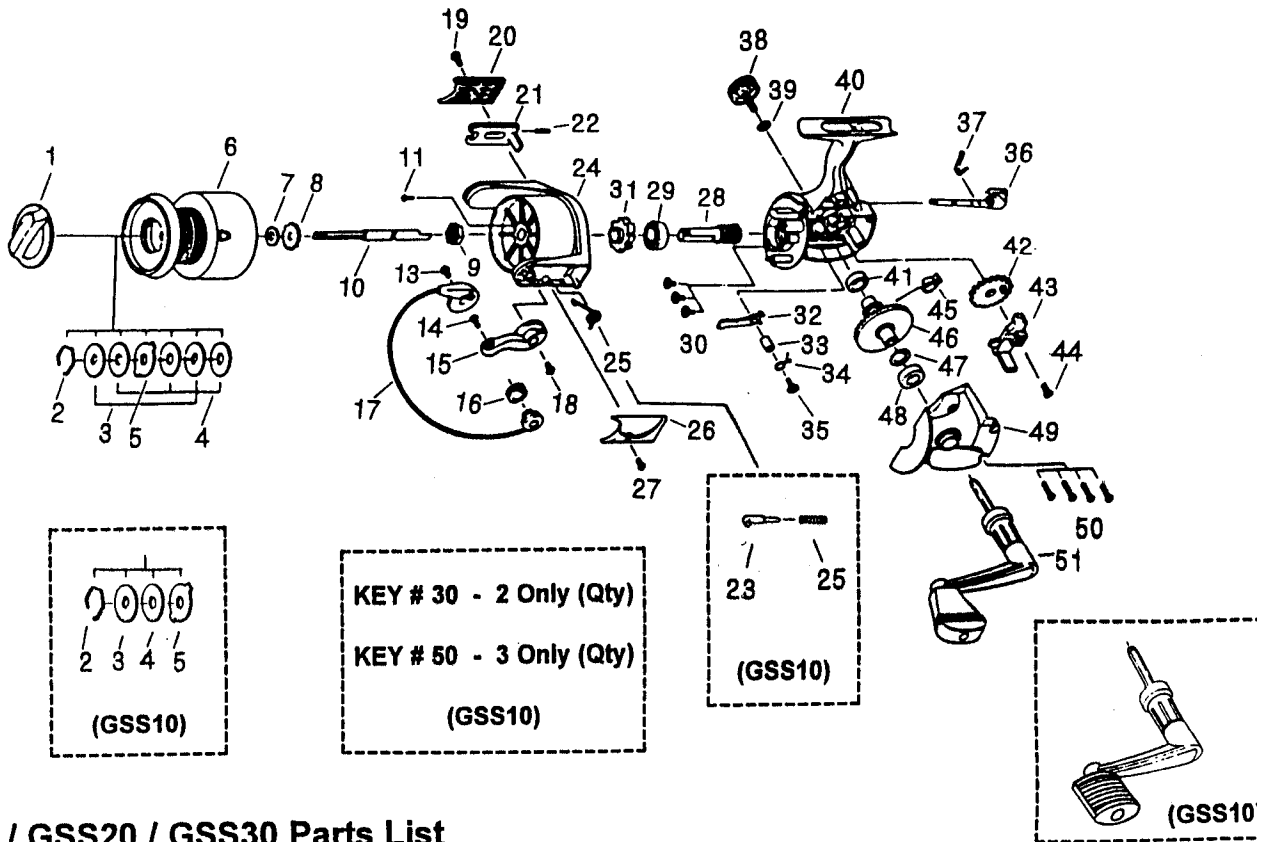

## GSS10 / GSS20 / GSS30 Parts List

KEY NO.	DESCRIPTION	Part No. GSS10	Part No. GSS20	Part No. GSS30	KEY NO.	DESCRIPTION	Part No. GSS10	Part No. GSS20	Part No. GSS30
1	DRAG KNOB ASSEMBLY	MH332-51	MH332-01	←	27	COVER SCREW	MH085-01	←	←
2	DRAG RETAINER	MH038-51	MH038-01	←	28	PINION GEAR	MH011-51	MH011-01	←
3	DRAG WASHER "D"	MH080-51	MH080-01	←	29	BALL BEARING	MH028-51	MH028-01	←
4	DRAG WASHER "B"	MH033-51	MH033-01	←	30	BEARING SCREW	MH041-01	←	←
5	DRAG WASHER "A"	MH081-51	MH081-01	←	31	RATCHET GEAR	MH060-51	MH060-01	←
6	SPOOL ASSEMBLY	MH321-51	MH321-01	MH321-31	32	ANTI REVERSE PAWL	MH063-51	MH063-01	←
7	SPOOL ADJUSTMENT WASHER	MH030-51	MH030-01	←	33	ANTI REVERSE PAWL POST	MH091-51	MH091-01	←
8	CLICK GEAR	MH037-51	MH037-01	←	34	ANTI REVERSE PAWL SPRING	MH061-51	MH061-01	←
9	ROTOR NUT	MH006-51	MH006-01	←	35	ANTI-REVERSE PAWL SCREW	MH077-51	MH077-01	←
10	MAIN SHAFT	MH015-51	MH015-01	←	36	ANTI REVERSE LEVER	MH090-51	MH090-01	←
11	ROTOR NUT LOCK SCREW	MH094-51	MH094-01	←	37	ANTI REVERSE LEVER SPRING	MH089-01	←	←
13	BALL HOLDER SCREW	MH044-01	MH044-01	←	38	HANDLE SCREW CAP	MH073-51	MH073-01	←
14	LINE SLIDER SCREW	MH108-51	MH108-01	←	39	HANDLE SCREW CAP WASHER	MH105-51	MH105-01	←
15	ARM LEVER	MH007-51	MH007-01	←	40	BODY	MH001-51	MH001-01	←
16	LINE ROLLER BALL BEARING	MH004-51	MH004-01	←	41	BODY BALL BEARING	MH027-51	MH027-01	←
17	BAIL ASSEMBLY	MH347-51	MH347-01	MH347-31	42	OSCILLATOR GEAR	MH053-51	MH053-01	←
18	ARM LEVER SCREW	MH044-01	←	←	43	OSCILLATOR SLIDER	MH025-51	MH025-01	←
19	KICK LEVER COVER SCREW	MH085-01	←	←	44	MAIN SHAFT SCREW	MH100-51	MH100-01	←
20	KICK LEVER COVER	MH024-51	MH024-01	←	45	SILENT CAM	MH086-51	MH086-01	←
21	KICK LEVER	MH019-51	MH019-01	MH019-31	46	DRIVE GEAR	MH012-51	MH012-01	←
22	KICK LEVER SPRING	MH049-01	←	←	47	DRIVE GEAR ADJ WASHER	MH026-51	MH026-01	←
23	BAIL SPRING SHAFT	MH031-01	N/A	N/A	48	BODY COVER BALL BEARING	MH027-51	MH027-01	←
24	ROTOR	MH009-51	MH009-01	MH009-31	49	BODY COVER	MH023-51	MH023-01	←
25	BAIL SPRING	MH022-51	MH022-01	←	50	BODY COVER SCREW	MH057-01	←	←
26	BAIL SPRING COVER	MH046-51	MH046-01	←	51	HANDLE ASSEMBLY	MH318-51	MH318-01	←

**LEW'S LIMITED (U.S.) WARRANTY** - Lew's products are warranted for a period of one (1) year from date of purchase against defects in workmanship and/or materials. Purchaser may return defective products, postage prepaid and insured, with proof of purchase (add \$2.25 in U.S. or Canada for postage and handling) direct to Lew's or the nearest Warranty Center. Lew's will repair or replace products at its option and return direct to purchaser. This warranty does not cover Lew's products damaged due to abuse, misuse, normal wear, excessive wear caused by neglect of cleaning and lubrication required or general service requirements due to owner's failure to provide reasonable and necessary maintenance. Lew's reels and rods not covered by the Lew's limited warranty may be repaired at a nominal charge to the purchaser, provided parts are available and the product is returned with return postage prepaid. \*ALL INCIDENTAL AND/OR CONSEQUENTIAL DAMAGES ARE EXCLUDED FROM THIS WARRANTY INSERT. IMPLIED WARRANTIES ARE LIMITED TO THE LIFE OF THIS WARRANTY. SOME STATES DO NOT ALLOW LIMITATIONS ON HOW LONG AN IMPLIED WARRANTY LASTS OR THE EXCLUSION OR LIMITATION OF INCIDENTAL OR CONSEQUENTIAL DAMAGES, SO THE ABOVE LIMITATIONS OR EXCLUSIONS MAY NOT APPLY TO YOU. THIS WARRANTY GIVES YOU SPECIFIC LEGAL RIGHTS, AND YOU MAY ALSO HAVE OTHER LEGAL RIGHTS WHICH MAY VARY FROM STATE TO STATE.\*



6101 E. APACHE, TULSA, OK., 74115  
918-831-6965 (Voice), 800-FIXREEL (Fax)

Made in Korea  
Printed in Korea

©1996 BRUNSWICK CORP