



# GW50 / GW60 (Bass Pro Exclusive)

## SPECIFICATIONS :

M FW / Lt SW

Line Capacity:

GW50 - 170 yds / 14 lb

GW60 - 210 yds / 20 lb

4 Ball Bearings

4.8:1 Gear Ratio

Retrieve Rate:

GW50 - 28"

GW60 - 30"

Weight:

GW50 - 13.8 oz.

GW60 - 15.4 oz.

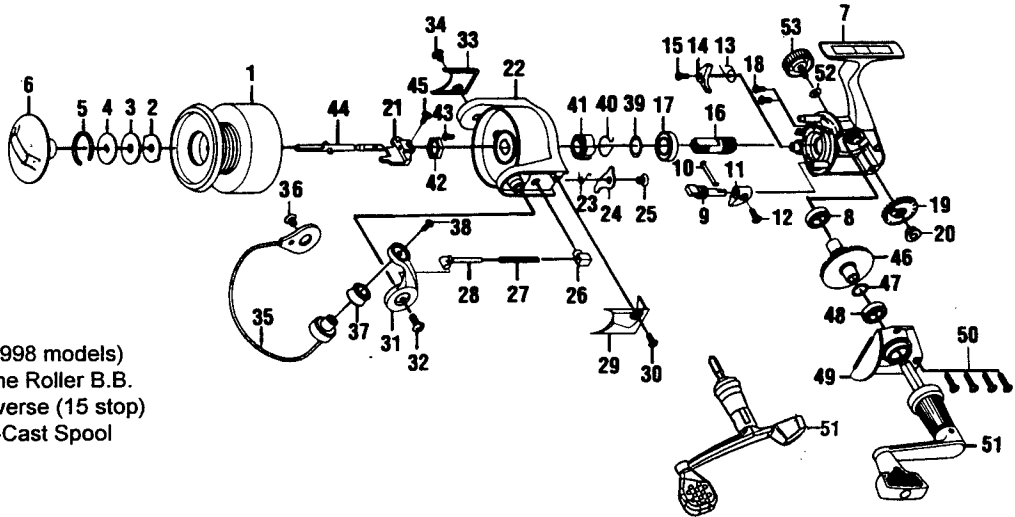

## FEATURES :

Front Drag

Balanced Rotor

Balanced Handle (New for 1998 models)

Oversized Twist Reducer Line Roller B.B.

POSI-Loc Selective Anti-Reverse (15 stop)

Aluminum Long Stroke Max-Cast Spool

Key No.	Part No. GW50	Part No. GW60	DESCRIPTION	Price	Key No.	Part No. GW50	Part No. GW60	DESCRIPTION	Price
1	BH321-33	BH321-43	Spool Assembly	8.22	28	BH031-31	←	Spring Shaft	0.96
2	BH081-21	←	Spool Washer "A"	0.59	29	BH046-33	BH046-43	Arm Lever Cover	1.85
3	BH033-21	←	Spool Washer "B"	0.64	30	BH085-13	←	Cover Screw	0.47
4	BH080-31	←	Spool Washer "D"	0.96	31	BH007-13	←	Arm Lever	2.44
5	BH038-21	←	Drag Retainer	1.01	32	BH044-13	←	Arm Lever Screw	0.42
6	BH332-33	BH332-43	Drag Knob Assembly	3.03	33	BH024-33	←	Bail Holder Cover	1.06
7	BH001-33	BH001-43	Body (before A8 date code)	3.92	34	BH085-13	←	Cover Screw	0.47
7	BH001-47	←	Body (after A8 date code)	3.92	35	BH347-33	BH347-43	Bail Assembly	5.20
8	BH027-12	←	Ball Bearing	6.58	36	BH044-13	←	Bail Holder Screw	0.42
9	BH090-11	←	Stopper Cam	1.60	37	BH004-14	←	Line Roller BB	4.14
10	BH089-11	←	Stopper Cam Spring	0.96	38	BH108-13	←	Bail Screw	0.42
11	BH059-14	←	Stopper Lever	1.08	39	BH110-31	←	Bearing Washer	0.54
12	BH135-12	←	Stopper Lever Screw	0.64	40	BH086-31	←	Silent Spring	1.65
13	BH061-11	←	Stopper Spring	0.46	41	BH060-32	←	Ratchet Gear	1.80
14	BH063-32	←	Stopper	1.53	42	BH006-31	←	Rotor Nut	1.22
15	BH077-11	←	Stopper Screw	0.64	43	BH094-11	←	Rotor Nut Lock Screw	0.94
16	BH011-31	←	Pinion Gear (before A8 date code)	3.34	44	BH315-31	BH315-41	Main Shaft Assembly	6.31
16	BH011-32	←	Pinion Gear (after A8 date code)	3.34	45	BH100-11	←	Main Shaft Screw	0.64
17	BH028-31	←	Ball Bearing (before A8 date code)	7.43	46	BH012-31	←	Driver Gear	5.52
17	BH028-32	←	Ball Bearing (after A8 date code)	7.43	47	BH026-11	←	Adjust Washer	0.69
18	BH041-11	←	Bearing Screw	0.64	48	BH027-12	←	Ball Bearing	6.58
19	BH053-31	←	O/S Gear	1.65	49	BH023-33	BH023-43	Body Cover	2.81
20	BH158-11	←	O/S Gear Bushing	0.98	50	BH057-13	←	Body Cover Screw	0.64
21	BH025-31	←	O/S Slider	2.71	51	BH318-32	←	Handle Assembly	4.40
22	BH009-33	BH009-43	Rotor	4.46	51	BH318-33	←	Balanced Handle (1998 models)	5.00
23	BH049-31	BH049-41	Kick Lever Spring	0.96	52	BH105-11	←	Handle Cap Washer	0.47
24	BH019-31	BH019-41	Kick Lever	1.97	53	BH073-33	←	Handle Screw Cap	2.44
25	BH136-11	←	Kick Lever Screw	0.64					
26	BH020-11	←	Spring Holder	0.96					
27	BH022-31	BH022-41	Arm Lever Spring	0.64					

▼ = Changed to Balanced Handle for 1998 models.

☐ = These parts are not interchangeable with parts from different date code (ie., use Pinion Gear before A8 along with Ball Bearing and Body before A8)

<b>MODEL</b>	<b>EFFECTIVE DATE OF</b>	
<b>INTRODUCED :</b> 1997	<b>PARTS LIST/DIAGRAM:</b> Sept. '98	<b>DISCONTINUED :</b> N / A

Prices subject to change without notice. Prices do not include postage and handling.

PLEASE ORDER BY PART NUMBER Zebco, P.O. Box 270, Tulsa, Ok. 74101; 918-831-6965 Phone or 800-FIXREEL (349-7335) FAX

