

# QUANTUM. HT2A / HT3A / HT4A

## SPECIFICATIONS :

### Application:

HT2A - Lt. FW  
HT3A - Med. Lt. FW  
HT4A - Med. FW

### 4.4:1 Gear Ratio

### Line Capacity:

HT2A - 140 yds / 6 lb  
HT3A - 160 yds / 8 lb  
HT4A - 180 yds / 10 lb

### Retrieve Rate (Inches Per Turn):

HT2A - 20.7"  
HT3A - 23.8"  
HT4A - 26.9"

### Weight:

HT2A - 9.9 oz.  
HT3A - 12.4 oz.  
HT4A - 13.8 oz.

### 1 Ball Bearing

## FEATURES :

Rear Drag  
Balanced Handle  
Oversized Twist Reducer Line Roller  
Aluminum Spool  
Geared (S-Curve) O/S System  
Color:

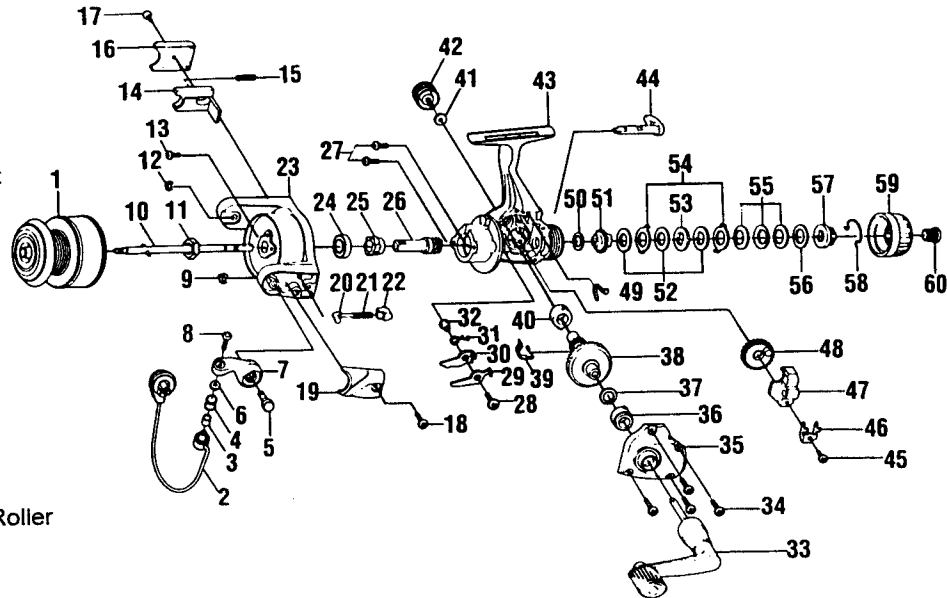

Key No.	HT2A Part No.	HT3A Part No.	HT4A Part No.	Description	Price	Key No.	HT2A Part No.	HT3A Part No.	HT4A Part No.	Description	Price
1	JH321-21	JH321-26	JH321-27	Spool Assy.	6.30	31	GU061-01	JU061-01	←	A/R Pawl Spring	0.37
2	JH347-15	JH347-16	JH347-17	Bail Assy.	4.38	32	GU091-01	GU091-02	←	Anti-Rev. Pawl Post	0.27
3	MT016-01	←	←	Line Roller Bushing	0.77	33	JH318-12	JH318-13	←	Handle Assy.	4.95
4	KH004-02	←	←	Line Roller	1.24	34	GU057-02	JU057-03	←	Body Cover Screw	0.81
5	HU051-01	HU051-03	HU051-01	Arm Lever Pin	0.59	35	JH023-16	KH023-17	LH023-15	Body Cover Assy	3.85
6	GU105-07	←	←	Line Roller Washer	0.15	36	GU027-01	JU027-01	←	Gear Shaft Bushing	0.84
7	JH007-03	←	←	Arm Lever	0.93	37	GU105-08	GU105-13	←	Adjustment Washer	0.15
8	AQ108-04	←	←	Line Slider Screw	0.31	38	GU012-01	JU012-02	←	Drive Gear	2.97
9	KQ034-01	←	←	E-Clip	0.15	39	GU086-01	JU086-01	←	Silent Cam	0.42
10	JU315-02	JU315-01	JU315-03	Main Shaft	1.06	40	GU027-01	JU027-01	←	Gear Shaft Bushing	0.84
11	GU006-01	RU006-01	RU006-01	Rotor Nut	0.32	41	GU105-01	←	←	Handle Cap Washer	0.10
12	KQ034-01	←	←	E-Clip	0.15	42	XU073-03	←	←	Handle Cap Screw	6.62
13	GU077-08	←	←	Rotor Nut Lck. Scrw.	0.15	43	JH001-16	KH001-17	LH001-15	Body Assy.	6.50
14	HU019-01	JU019-01	KU019-01	Kick Lever	0.54	44	KH090-03	←	←	Anti-Reverse Lever	1.49
15	KQ049-04	←	←	Kick Lever Spring	0.32	45	JU100-01	←	←	Oscillator Ret. Screw	0.27
16	HU046-06	JU046-05	KU046-04	Kick Lever Cover	0.26	46	HU078-01	JU078-01	←	O/S Slide Retainer	0.27
17	GU077-02	←	←	Kick Lvr Cvr Screw	0.15	47	HU025-01	JU025-01	KU025-01	Oscillator Slider	1.06
18	GU077-02	←	←	Cover Screw	0.15	48	HU053-01	JU053-01	KU053-01	Oscillator Gear	1.06
19	JH087-05	KH087-04	LH087-03	Arm Lvr Spring Cvr	0.26	49	GU089-01	←	←	Anti-Rev. Lvr Spring	0.54
20	KQ031-01	←	←	Arm Lever Spring Pin	0.27	50	GU105-34	GU105-32	←	Drag Friction Washer	0.81
21	KQ049-05	KQ049-02	←	Arm Lever Spring	0.32	51	HU075-01	JU075-01	KU075-01	Drag Click Gear	0.64
22	QL020-01	←	←	Arm Lvr Spring Holder	0.32	52	GU105-35	GU105-33	←	Drag Washer "B"	0.94
23	HU009-19	JU009-19	KU009-16	Rotor	6.35	53	HU080-01	JU080-01	←	Drag Washer "D"	0.54
24	AQ028-01	AQ028-06	←	Ball Bearing	6.95	54	HU081-01	JU081-01	←	Drag Washer "A"	0.54
25	HU060-01	JU060-01	←	Anti-Rev. Ratchet	2.12	55	HU043-01	JU043-01	←	Drag Spring	0.69
26	GU011-02	JU011-01	←	Pinion Gear	2.07	56	GU105-24	GU105-19	←	Drag Washer	0.94
27	GU077-01	JU077-01	←	Bearing Screw	0.15	57	HU066-01	JU066-01	←	Drag Nut	0.64
28	GU077-05	GU077-16	←	Anti-Rev. Pawl Screw	0.15	58	HU070-01	JU083-01	←	Drag Retainer Clip	1.16
29	GU063-01	JU063-01	←	Anti-Rev. Pawl "A"	0.47	59	MU332-01	KU332-01	←	Drag Knob Assy.	0.77
30	GU074-01	JU074-01	←	Anti-Rev. Pawl "B"	0.47	60	JH101-03	KH101-03	←	Drag Knob Screw	0.62

<b>MODEL INTRODUCED :</b> 1998	<b>EFFECTIVE DATE OF PARTS LIST/DIAGRAM:</b> Nov. '98	<b>DISCONTINUED :</b> N/A
--------------------------------	---	---------------------------

Prices subject to change without notice.  
PLEASE ORDER BY PART NUMBER

Zebco, P.O. Box 270, Tulsa, Ok. 74101; 918-831-6965 Phone or 800-FIXREEL (349-7335) FAX  
Prices do not include postage and handling.

