

QUANTUM[®]

HTX1F

SPECIFICATIONS :

Ultra Lt. FW
 125 yds / 4 lb Line Capacity
 5.3:1 Gear Ratio
 22.9" Retrieve Rate (inches per turn)
 8.1 oz.
 1 Ball Bearing

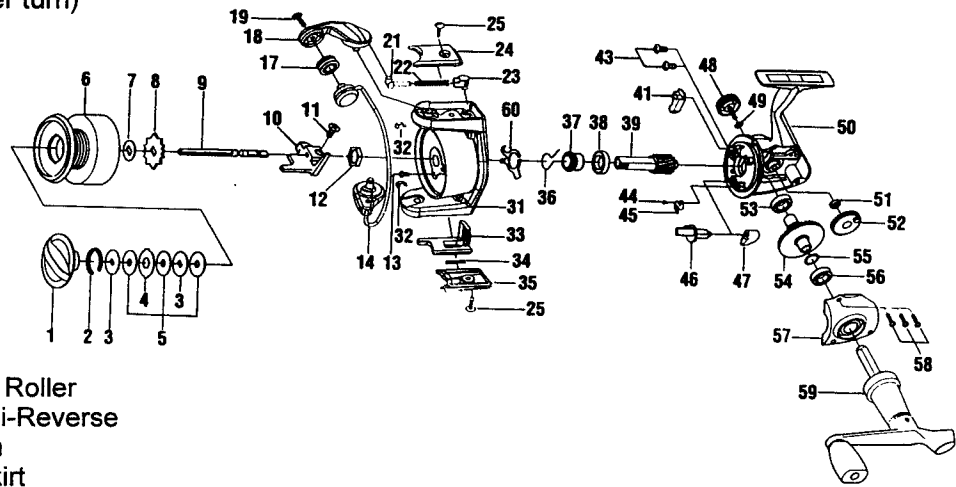

FEATURES :

Front Drag
 Tru-Balanced Rotor
 Balanced Handle
 Oversized Twist Reducer Line Roller
 Selective On/Off (50 Stop) Anti-Reverse
 Geared (S-Curve) O/S System
 Aluminum Spool w/ holes in skirt
 Spare Graphite Spool (HTX1F only)
 Color:

| Key No. | Part No. HTX1F | Description | Price | Key No. | Part No. HTX1F | Description | Price |
|---------|----------------|----------------------|-------|---------|----------------|-----------------------|-------|
| 1 | RH332-05 | Drag Knob Assy. | | 34 | KQ049-01 | Kick Lever Spring | |
| 2 | RH038-01 | Spool Retainer | | 35 | RH024-05 | Kick Lever Cover | |
| 3 | RH080-01 | Drag Washer "D" | | 36 | VH119-01 | Slider Spring "A" | |
| 4 | RH081-01 | Drag Washer "A" | | 37 | VH060-01 | Ratchet | |
| 5 | RH033-01 | Drag Washer "B" | | 38 | RH028-01 | Pinion Ball Bearing | |
| 6 | RH321-05 | Spool Assy. | | 39 | RH011-01 | Pinion Gear | |
| 7 | XH030-01 | Spool Adj. Washer | | 41 | VH063-01 | Stopper | |
| 8 | RH037-01 | Click Gear | | 43 | RH041-01 | Bearing Screw | |
| 9 | RH015-01 | Main Shaft | | 44 | TH146-01 | Stopper Cam Screw | |
| 10 | RH025-01 | Oscillator Slider | | 45 | RH089-01 | Stopper Cam Spring | |
| 11 | XH100-01 | Main Shaft Screw | | 46 | RH090-01 | Stopper Cam | |
| 12 | GU006-01 | Rotor Nut | | 47 | TH059-01 | Stopper Lever | |
| 13 | GU077-08 | Rotor Nut Lck. Scrw. | | 48 | TH073-01 | Handle Cap Screw | |
| 14 | VH347-01 | Bail Assy. | | 49 | TH105-01 | Handle Cap Washer | |
| 17 | BH004-02 | Line Roller B.B. | | 50 | VH301-02 | Body Assy. | |
| 18 | VH007-01 | Arm Lever | | 51 | TH158-01 | O/S Gear B.B. | |
| 19 | AQ108-01 | Bail Screw | | 52 | RH053-01 | Oscillator Gear | |
| 21 | KQ031-01 | Bail Spring Shaft | | 53 | BH027-01 | Body Ball Bearing | |
| 22 | KQ049-05 | Bail Spring | | 54 | RH012-01 | Drive Gear | |
| 23 | QL020-01 | Bail Spring Holder | | 55 | GU105-08 | Drive Gear Adj. Wshr. | |
| 24 | VH087-01 | Bail Spring Cover | | 56 | BH027-01 | Body Cvr. B.B. | |
| 25 | GU077-03 | Cover Screw | | 57 | RH023-05 | Body Cover | |
| 31 | VH009-01 | Rotor | | 58 | GU057-02 | Body Cover Screw | |
| 32 | GH034-01 | E-Clip | | 59 | RH318-04 | Handle Assy. | |
| 33 | KQ049-01 | Kick Lever | | 60 | VH086-01 | Slider Spring "B" | |

| | | |
|--------------------------|--------------------------------------|---------------------------|
| MODEL | EFFECTIVE DATE OF | |
| INTRODUCED : 1998 | PARTS LIST/DIAGRAM: Sept. '98 | DISCONTINUED : N/A |

Zebco, P.O. Box 270, Tulsa, Ok. 74101; 918-831-6965 Phone or 800-FIXREEL (349-7335) FAX
 PLEASE ORDER BY PART NUMBER Prices subject to change without notice.

