



HTX2F / HTX3F / HTX4F

SPECIFICATIONS :

Application:

- HTX2F - Lt. FW
- HTX3F - Med. FW
- HTX4F - Hvy FW

5.2:1 Gear Ratio

Line Capacity:

- HTX2F - 140 yds / 6 lb
- HTX3F - 160 yds / 8 lb
- HTX4F - 180 yds / 10 lb

Retrieve Rate (Inches Per Turn):

- HTX2F - 24.5"
- HTX3F - 30.2"
- HTX4F - 34.1"

Weight:

- HTX2F - 9.9 oz.
- HTX3F - 12.4 oz.
- HTX4F - 13.8 oz.

5 Ball Bearings

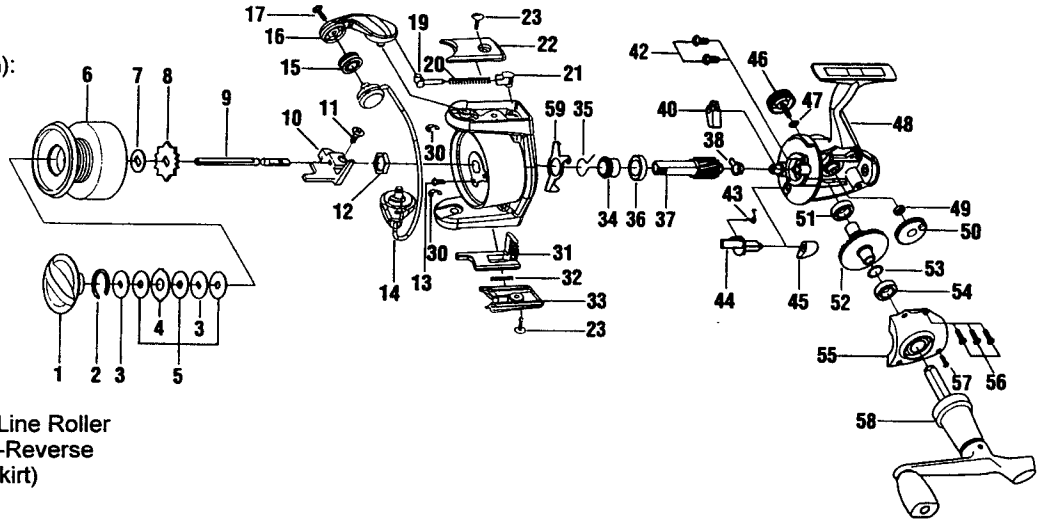

FEATURES :

- Front Drag
- Tru-Balanced Rotor
- Balanced Handle
- Oversized Twist Reducer B.B. Line Roller
- Selective On/Off (60 Stop) Anti-Reverse
- Aluminum Spool (w/ Holes in Skirt)
- Spare Graphite Spool
- Geared (S-Curve) O/S System
- Color:

Key No.	HTX2F	Part No. HTX3F	HTX4F	Description	Price	Key No.	HTX2F	Part No. HTX3F	HTX4F	Description	Price
1	XH332-02	←	←	Drag Knob Assy.	12.97	33	SH024-04	TH024-05	←	Kick Lever Cover	
2	RH038-01	XH038-01	←	Spool Retainer		34	WH060-01	XH060-01	←	Ratchet	
3	RH080-01	XH080-01	←	Drag Washer "D"		35	WH119-01	XH119-01	←	Slider Spring "A"	
4	RH081-01	XH081-01	←	Drag Washer "A"		36	RH028-01	AQ028-03	←	Pinion Ball Bearing	
5	RH033-01	XH033-01	←	Drag Washer "B"		37	SH011-01	TH011-01	←	Pinion Gear	
6	WH321-02	XH321-02	YH321-02	Spool Assy.		38	WH141-01	TH141-01	←	Pinion Bushing	
7	XH030-01	←	←	Spool Adj. Washer		40	WH063-01	XH063-01	←	Stopper	
8	XH037-01	←	←	Click Gear		42	TH041-01	←	←	Bearing Screw	
9	WH015-01	XH015-01	YH015-01	Main Shaft		43	TH089-01	←	←	Stopper Cam Spring	
10	WH025-01	XH025-01	←	Oscillator Slider		44	TH090-01	←	←	Stopper Cam	
11	XH100-01	←	←	Main Shaft Screw		45	TH059-01	←	←	Stopper Lever	
12	GU006-01	RU006-01	←	Rotor Nut		46	TH073-01	←	←	Handle Cap Screw	
13	GU077-08	←	←	Rotor Nut Lck. Scrw.		47	TH105-01	←	←	Handle Cap Washer	
14	WH347-03	XH347-03	YH347-03	Bail Assy.		48	WH301-02	XH301-02	XH301-04	Body Assy.	
15	BH004-14	←	←	Line Roller B.B.		49	TH158-01	←	←	O/S Gear B.B.	
16	XH007-01	←	←	Arm Lever		50	SH053-01	TH053-01	←	Oscillator Gear	
17	AQ108-01	←	←	Bail Screw		51	BH027-01	AQ028-03	←	Body Ball Bearing	
19	KQ031-01	←	←	Bail Spring Shaft		52	SH012-01	TH012-01	←	Drive Gear	
20	KQ049-05	←	←	Bail Spring		53	GU105-08	GU105-13	←	Drive Gear Adj. Wshr.	
21	QL020-01	←	←	Bail Spring Holder		54	BH027-01	AQ028-03	←	Body Cvr. B.B.	
22	WH087-01	XH087-01	←	Bail Spring Cover		55	SH023-07	TH023-08	TH023-15	Body Cover	
23	GU077-03	←	←	Cover Screw		56	JU057-03	←	←	Body Cover Screw	
29	WH009-03	XH009-03	YH009-03	Rotor		57	GU057-02	←	←	Body Cover Screw	
30	GH034-01	←	←	E-Clip		58	RH318-04	TH318-04	←	Handle Assy.	
31	SH019-01	TH019-01	UH019-01	Kick Lever		59	WH086-01	XH086-01	←	Slider Spring "B"	
32	TH049-01	←	←	Kick Lever Spring							

MODEL	EFFECTIVE DATE OF
INTRODUCED : 1998	PARTS LIST/DIAGRAM: Sept. '98
DISCONTINUED : N/A	

Prices subject to change without notice. Zebco, P.O. Box 270, Tulsa, Ok. 74101; 918-831-6965 Phone or 800-FIXREEL (349-7335) FAX
PLEASE ORDER BY PART NUMBER Prices do not include postage and handling.

