

### SPECIFICATIONS :

M FW / Lt SW

200 yds / 6 lb Line Capacity - IR2F

200 yds / 10 lb Line Capacity - IR4F

5.7:1 Gear Ratio

11.5 oz. - IR2F

12.4 oz. - IR4F

4 Stainless Steel Ball Bearings.

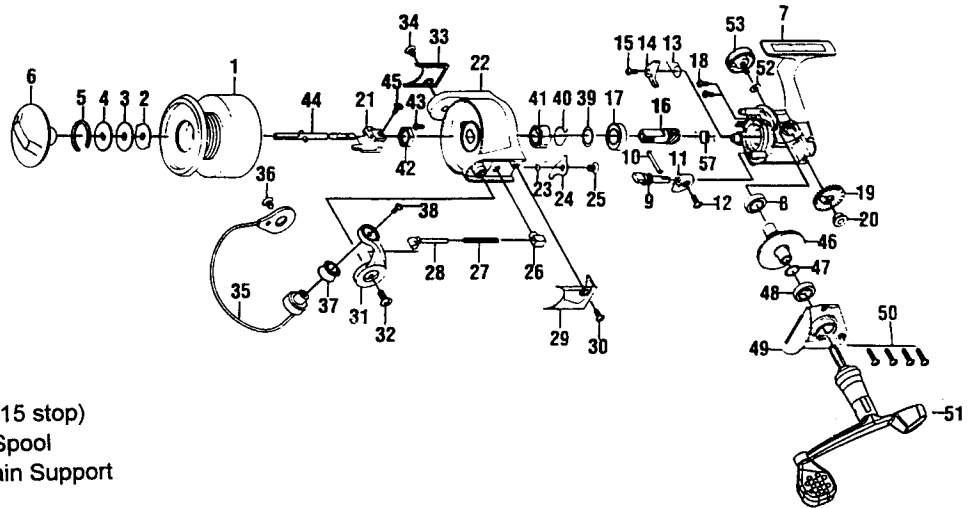

### FEATURES :

Front Drag

Balanced Rotor

Balanced Handle

Twist Reducer Line Roller

POSI-Loc Selective Anti-Reverse (15 stop)

Aluminum Long Stroke Max-Cast Spool

Aluminum Side Cover for Drive Train Support

Brass Pinion and Drive Gear

Key No.	Part No. IR2F	Part No. IR4F	DESCRIPTION	Price	Key No.	Part No. IR2F	Part No. IR4F	DESCRIPTION	Price
1	BH321-16	BH321-25	Spool Assembly	7.98	26	BH020-11	←	Spring Holder	0.96
2	BH081-11	BH081-21	Spool Washer "A"	0.59	27	BH022-11	BH022-21	Arm Lever Spring	0.64
3	BH033-11	BH033-21	Spool Washer "B"	0.64	28	BH031-11	BH031-21	Spring Shaft	0.96
4	BH080-11	BH080-21	Spool Washer "D"	0.96	29	BH046-16	BH046-24	Arm Lever Cover	2.68
5	BH038-11	BH038-21	Drag Retainer	1.01	30	BH085-14	←	Cover Screw	0.62
6	BH332-15	BH332-25	Drag Knob Assembly	3.24	31	BH007-13	←	Arm Lever	2.44
7	BH001-16	BH001-25	Body (before A8 date code)	6.18	32	BH044-14	←	Arm Lever Screw	0.62
7	BH001-28	←	Body (after A8 date code)	6.18	33	BH024-14	←	Bail Holder Cover	1.70
8	BH027-12	←	Ball Bearing	6.58	34	BH085-14	←	Cover Screw	0.62
9	BH090-11	←	Stopper Cam	1.60	35	BH347-13	BH347-23	Bail Assembly	5.09
10	BH089-11	←	Stopper Cam Spring	0.96	36	BH044-14	←	Bail Holder Screw	0.62
11	BH059-14	←	Stopper Lever	1.08	37	BH004-14	←	Line Roller Ball Bearing	4.14
12	BH135-13	←	Stopper Lever Screw	0.47	38	BH108-14	←	Bail Screw	0.62
13	BH061-11	←	Stopper Spring	0.46	39	BH110-11	←	Bearing Washer	0.54
14	BH063-12	←	Stopper	1.49	40	BH086-11	←	Silent Spring	1.65
15	BH077-11	←	Stopper Screw	0.64	41	BH060-12	←	Ratchet Gear	1.75
16	BH011-13	←	Pinion Gear (before A8 date code)	2.76	42	BH006-11	←	Rotor Nut	1.11
16	BH011-14	←	Pinion Gear (after A8 date code)	2.76	43	BH094-11	←	Rotor Nut Lock Screw	0.64
17	BH028-11	←	Ball Bearing (before A8 date code)	8.70	44	BH315-11	BH315-21	Main Shaft Assembly	5.73
17	BH028-12	←	Ball Bearing (after A8 date code)	8.70	45	BH100-11	←	Main Shaft Screw	0.64
18	BH041-11	←	Bearing Screw	0.64	46	BH012-14	←	Driver Gear	5.36
19	BH053-11	BH053-21	O/S Gear	1.53	47	BH026-11	←	Adjust Washer	0.69
20	BH158-11	←	O/S Gear Bushing	0.98	48	BH027-12	←	Ball Bearing	6.58
21	BH025-11	←	O/S Slider	2.66	49	BH023-16	BH023-25	Body Cover	5.15
22	BH009-16	BH009-26	Rotor	6.70	50	BH057-14	←	Body Cover Screw	0.62
23	BH049-11	BH049-21	Kick Lever Spring	0.96	51	BH318-16	←	Handle Assembly	7.47
24	BH019-11	BH019-21	Kick Lever	1.91	52	BH105-11	←	Handle Cap Washer	0.47
25	BH136-11	←	Kick Lever Screw	0.64	53	BH073-13	←	Handle Screw Cap	2.34

☐ = These parts are not interchangeable with parts from different date code (ie., use Pinion Gear before A8 along with Ball Bearing and Body before A8)

<b>MODEL</b>	<b>EFFECTIVE DATE OF</b>	
<b>INTRODUCED : 1997</b>	<b>PARTS LIST/DIAGRAM: Sept. '98</b>	<b>DISCONTINUED : N/A</b>

Prices subject to change without notice. Prices do not include postage and handling.

PLEASE ORDER BY PART NUMBER

Zebco, P.O. Box 270, Tulsa, Ok. 74101; 918-831-6965 Phone or 800-FIXREEL (349-7335) FAX

