

BROWNING® LT 01A

WARNING!!!

These parts are not interchangeable with previous model

SPECIFICATIONS:

Micro Light Fresh
80 yds./4 lb. Line Capacity
5.2:1 Ratio
4.9 oz. Weight
3 Ball Bearings

FEATURES:

Front Drag System
Silent Anti-Reverse
Right/Left Balanced Handle
Internal Bail Trip
Twist Reducing Line Roller
Brass Pinion Gear
Color: Grey

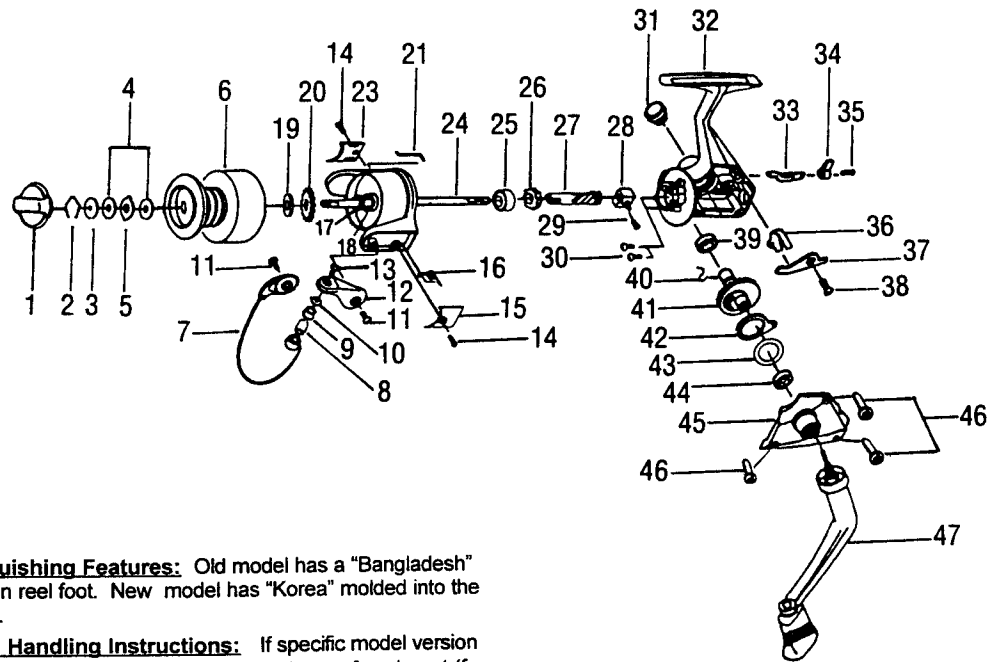

Distinguishing Features: Old model has a "Bangladesh" sticker on reel foot. New model has "Korea" molded into the reel foot.

Special Handling Instructions: If specific model version cannot be identified for parts order, send one of each part (for old and new model) and charge for one part.

Key No.	Part No.	Description	Price	Key No.	Part No.	Description	Price
1	QH332-03	Drag Knob Assembly	1.90	29	QH100-01	Main Shaft Screw	.25
2	QH038-01	Drag Retainer	.40	30	GU077-01	Bearing Screw	.15
3	QH080-01	Drag Washer "D"	.45	31	QH073-04	Handle Screw Cap	.80
4	QH033-01	Drag Washer "B"	.70	32	QH001-08	Body	2.60
5	QH081-01	Drag Washer "A"	.40	33	QH059-01	Anti-Reverse Cam	.70
6	QH321-08	Spool Assembly	6.05	34	QH090-03	Anti-Reverse Lever	.40
7	QH347-05	Bail Assembly	2.25	35	QH135-01	A/R Lever Screw	.25
8	QH016-01	Line Roller Bushing	.25	36	QH089-01	A/R Lever Spring	.25
9	QH004-01	Line Roller	.70	37	QH063-01	Anti-Reverse Pawl	.40
10	GU105-07	Line Roller Washer	.15	38	QH077-01	Anti-Reverse Pawl Screw	.25
11	QH051-01	Arm Lever Screw	.25	39	QH028-01	Gear Shaft Ball Bearing	6.20
12	QH007-04	Arm Lever	1.15	40	QH086-01	Silent Cam	.40
13	AQ108-05	Line Slider Screw	.25	41	QH012-01	Drive Gear	.85
14	GU077-01	Cover Screw	.15	42	QH104-01	Oscillator Cam	1.00
15	QH087-04	Bail Spring Cover	.85	43	QH026-01	Drive Gear Adj. Washer	.30
16	QH022-01	Bail Spring	.35	44	QH028-01	Gear Shaft Ball Bearing	6.20
17	QH006-01	Rotor Nut	.50	45	QH023-08	Body Cover	1.60
18	QH065-01	Rotor Washer	.25	46	GU057-02	Body Cover Screw	.81
19	QH030-01	Spool Adjustment Washer	.25	47	QH318-05	Handle Assembly	8.25
20	QH037-01	Click Gear	.40				
21	QH009-08	Rotor	.80				
22	QH019-01	Kick Lever	.40				
23	QH024-04	Kick Lever Cover	.85				
24	QH015-01	Main Shaft	1.15				
25	AQ028-02	Pinion Ball Bearing	6.28				
26	QH060-01	Ratchet Gear	.80				
27	QH011-01	Pinion Gear	2.85				
28	QH025-01	Oscillator Slider	.50				

MODEL INTRODUCED	1998	EFFECTIVE DATE OF PARTS LIST/DIAGRAM	Feb. 1998	DISCONTINUED	N/A
------------------	------	--------------------------------------	-----------	--------------	-----

Prices subject to change without notice. Prices do not include postage and handling.

PLEASE ORDER BY PART NUMBER Zebco Division Brunswick Corporation, Box 270, Tulsa, OK 74101 USA 918-831-6965

