

BROWNING MIDAS 05

SPECIFICATIONS:

- Ultra Light
- 5.4:1 Gear Ratio
- 110 yds./4 lb. Line Capacity
- 6.4 oz. Weight
- Front Drag
- 4 Ball Bearings

FEATURES:

- Long-stroke gold anodized aluminum spool
- High-performance balanced handle and rotor prevent traditional spinning reel wobble
- Six models cover light to heavy fresh and saltwater applications
- Color - Dark Green

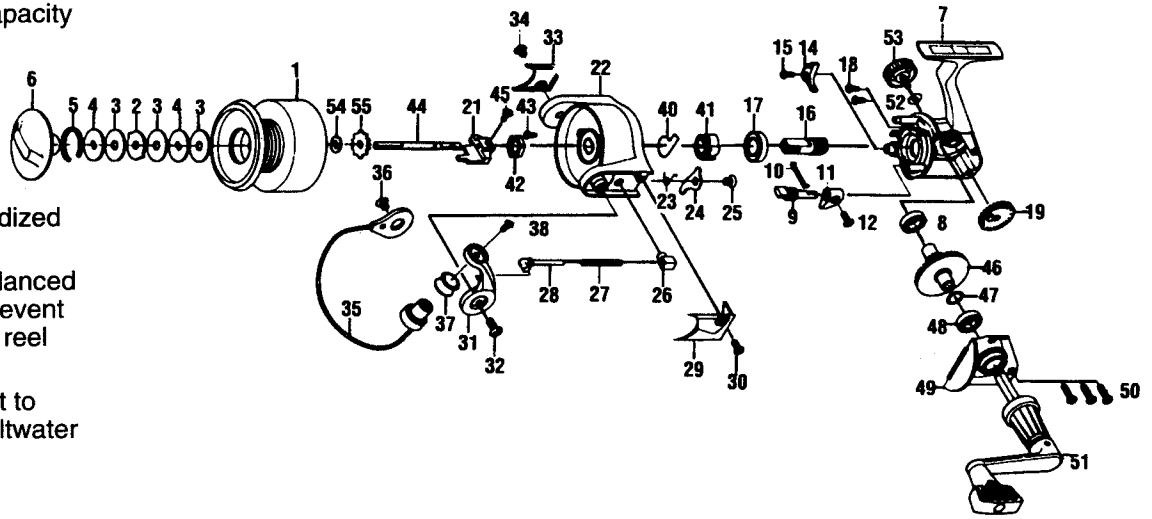

Key No.	Part No.	Description	Price	Key No.	Part No.	Description	Price
1	BH321-01	Spool Assembly	7.98	29	BH046-01	Arm Lever Cover	2.60
2	BH081-01	Spool Washer "A"	.55	30	BH085-13	Cover Screw	.46
3	BH033-11	Spool Washer "B"	.62	31	BH007-02	Arm Lever	3.00
4	BH080-01	Spool Washer "D"	.90	32	BH044-13	Arm Lever Screw	.41
5	BH038-11	Drag Reatiner	.98	33	BH024-01	Bail Holder Cover	1.65
6	BH332-01	Drag Knob Assembly	3.15	34	BH085-13	Cover Screw	.46
7	BH001-01	Body	6.00	35	BH347-02	Bail Assembly	6.25
8	BH027-01	Bearing	5.95	36	BH044-13	Bail Holder Screw	.41
9	BH090-11	Stopper Cam	1.55	37	BH004-02B	L/Roller or Bearing	5.05
10	BH089-11	Stopper Cam Spring	.93	38	BH108-01	Bail Screw	.60
11	BH059-14	Stopper Lever	1.05	40	BH086-01	Silent Spring	1.55
12	BH135-12	Stopper Lever Screw	.62	41	BH060-02	Ratchet Gear	1.70
14	BH063-02	Stopper	1.45	42	BH006-01	Rotor Nut	1.15
15	BH077-01	Stopper Screw	.60	43	BH094-11	Rotor Nut Lock Screw	.62
16	BH011-01	Pinion Gear	3.15	44	BH015-01	Main Shaft Assembly	2.45
17	BH028-01	Ball Bearing	7.00	45	BH100-01	Main Shaft Screw	.60
18	BH041-11	Bearing Screw	.62	46	BH012-01	Drive Gear	5.20
19	BH053-01	O/S Gear	1.55	47	BH026-01	Adjust Washer	.65
21	BH025-01	O/S Slider	2.55	48	BH027-01	Bearing	5.95
22	BH009-01	Rotor	6.50	49	BH023-01	Body Cover	5.00
23	BH049-01	Kick Lever Spring	.90	50	BH057-01	Body Cover Screw	.60
24	BH019-01	Kick Lever	1.85	51	BH318-01	Handle Assembly	7.25
25	BH136-01	Kick Lever Screw	.60	52	BH105-11	Handle Cap Washer	.46
26	BH020-11	Spring Holder	.93	53	BH073-13	Handle Screw Cap	2.27
27	BH022-01	Arm Lever Spring	.60	54	BH030-01	Click Gear Washer	.95
28	BH031-01	Spring Shaft	.90	55	BH037-01	Click Gear	.25

MODEL INTRODUCED	EFFECTIVE DATE OF PARTS LIST/DIAGRAM	Oct. 1996	DISCONTINUED	N/A
-------------------------	---	-----------	---------------------	-----

Prices subject to change without notice. Prices do not include postage and handling.

PLEASE ORDER BY PART NUMBER Zebco Division, Brunswick Corporation, Box 270, Tulsa, OK 74101 USA 918-831-6985

