

QUANTUM

MSC 00A

WARNING!!!

These parts are not interchangeable with previous model

SPECIFICATIONS:

Micro Light Fresh
80 yds./4 lbs. Line Capacity
5.2:1 Ratio
4.4 oz. Weight
1 Ball Bearings

FEATURES:

Front Drag System
Silent Anti-Reverse
Right/Left Balanced Handle
Internal Bail Trip
Twist Reducing Line Roller
Brass Pinion Gear
Color: Black

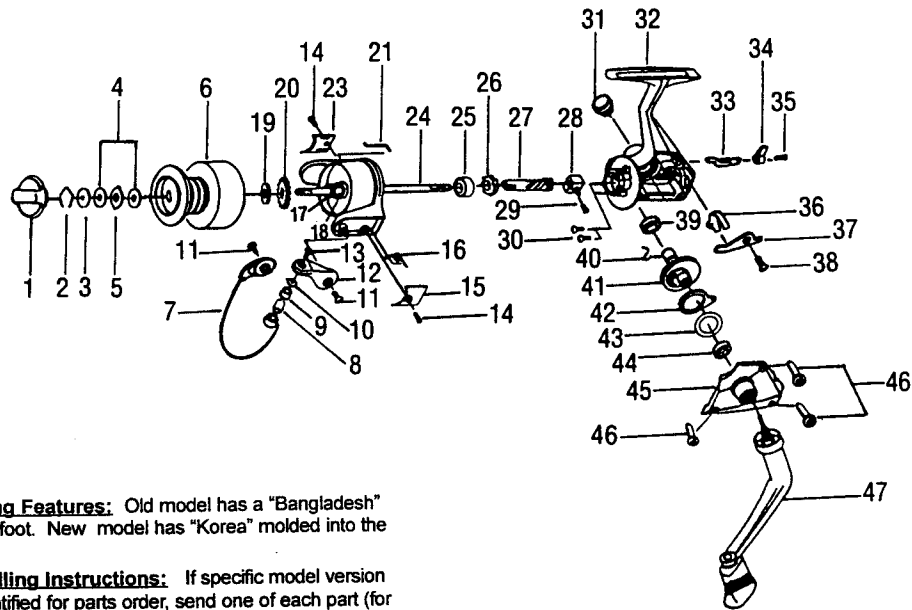

Distinguishing Features: Old model has a "Bangladesh" sticker on reel foot. New model has "Korea" molded into the reel foot.

Special Handling Instructions: If specific model version cannot be identified for parts order, send one of each part (for old and new model) and charge for one part.

Key No.	Part No.	Description	Price	Key No.	Part No.	Description	Price
1	QH332-01	Drag Knob Assembly	1.60	30	GU077-01	Bearing Screw	.15
2	QH038-01	Drag Retainer	.40	31	QH073-01	Handle Screw Cap	.35
3	QH080-01	Drag Washer "D"	.45	32	QH001-02	Body	2.55
4	QH033-01	Drag Washer "B"	.70	33	QH059-01	Anti-Reverse Cam	.70
5	QH081-01	Drag Washer "A"	.40	34	QH090-01	Anti-Reverse Lever	.40
6	QH321-02	Spool Assembly	6.05	35	QH135-02	A/R Lever Screw	.25
7	QH347-01	Bail Assembly	1.90	36	QH089-01	A/R Lever Spring	.25
8	QH016-01	Line Roller Bushing	.25	37	QH063-01	A/R Lever Pawl	.40
9	QH004-01	Line Roller	.70	38	QH077-01	A/R Lever Pawl Screw	.25
10	GU105-07	Line Roller Washer	.15	39	QH027-01	Gear Shaft Busing	.50
11	QH051-02	Arm Lever Screw	.25	40	QH086-01	Silent Cam	.40
12	QH007-01	Arm Lever	.50	41	QH012-01	Drive Gear	.85
13	AQ108-04	Line Slider Screw	.31	42	QH104-01	Oscillator Cam	1.00
14	GU077-09	Cover Screw	.35	43	QH026-01	Drive Gear Adj. Washer	.30
15	QH087-01	Bail Spring Cover	.45	44	QH028-01	Gear Shaft Bushing	.50
16	QH022-01	Bail Spring	.35	45	QH023-02	Body Cover	1.30
17	QH006-01	Rotor Nut	.50	46	GU057-01	Body Cover Screw	.15
18	QH065-01	Rotor Washer	.25	47	QH318-01	Handle Assembly	2.90
19	QH030-01	Spool Adjustment Washer	.25				
20	QH037-01	Click Gear	.40				
21	QH009-01	Rotor	1.10				
22	QH019-01	Kick Lever	.40				
23	QH024-01	Kick Lever Cover	.45				
24	QH015-01	Main Shaft	1.15				
25	AQ028-02	Pinion Ball Bearing	6.28				
26	QH060-01	Ratchet Gear	.80				
27	QH011-01	Pinion Gear	2.85				
28	QH025-01	Oscillator Slider	.50				
29	QH100-01	Main Shaft Screw	.25				

MODEL INTRODUCED	1998	EFFECTIVE DATE OF PARTS LIST/DIAGRAM	Feb. 1998	DISCONTINUED	N/A
------------------	------	--------------------------------------	-----------	--------------	-----

Prices subject to change without notice. Prices do not include postage and handling.

PLEASE ORDER BY PART NUMBER Zebco Division Brunswick Corporation, Box 270, Tulsa, OK 74101 USA 918-836-5581

