

# QUANTUM

# QL 00A

### WARNING!!!

These parts are not interchangeable with previous model

#### SPECIFICATIONS:

Micro Light Fresh  
80 yds./4 lbs. Line Capacity  
5.2:1 Ratio  
4.9 oz. Weight  
1 Ball Bearings

#### FEATURES:

Front Drag System  
Silent Anti-Reverse  
Right/Left Balanced Handle  
Internal Bail Trip  
Twist Reducing Line Roller  
Brass Pinion Gear  
Color: Black

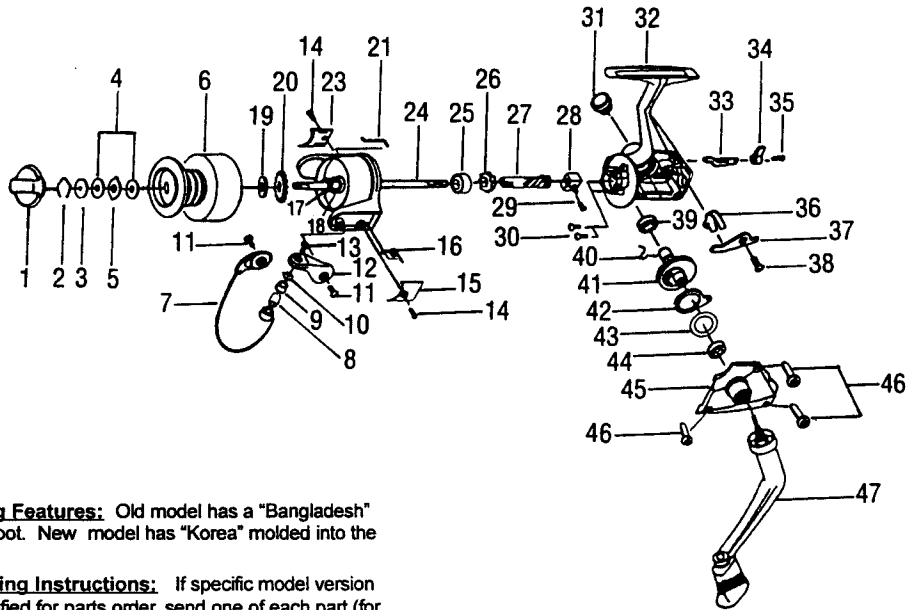

**Distinguishing Features:** Old model has a "Bangladesh" sticker on reel foot. New model has "Korea" molded into the reel foot.

**Special Handling Instructions:** If specific model version cannot be identified for parts order, send one of each part (for old and new model) and charge for one part.

| Key No. | Part No. | Description             | Price | Key No. | Part No. | Description            | Price |
|---------|----------|-------------------------|-------|---------|----------|------------------------|-------|
| 1       | QH332-01 | Drag Knob Assembly      | 1.60  | 30      | GU077-01 | Bearing Screw          | .15   |
| 2       | QH038-01 | Drag Retainer           | .40   | 31      | QH073-01 | Handle Screw Cap       | .35   |
| 3       | QH080-01 | Drag Washer "D"         | .45   | 32      | QH001-03 | Body                   | 2.60  |
| 4       | QH033-01 | Drag Washer "B"         | .70   | 33      | QH059-01 | Anti-Reverse Cam       | .70   |
| 5       | QH081-01 | Drag Washer "A"         | .40   | 34      | QH090-01 | Anti-Reverse Lever     | .40   |
| 6       | QH321-03 | Spool Assembly          | 6.05  | 35      | QH135-02 | A/R Lever Screw        | .25   |
| 7       | QH347-01 | Bail Assembly           | 1.90  | 36      | QH089-01 | A/R Lever Spring       | .25   |
| 8       | QH016-01 | Line Roller Bushing     | .25   | 37      | QH063-01 | A/R Lever Pawl         | .40   |
| 9       | QH004-01 | Line Roller             | .70   | 38      | QH077-01 | A/R Lever Pawl Screw   | .25   |
| 10      | GU105-07 | Line Roller Washer      | .15   | 39      | QH027-01 | Gear Shaft Bushing     | .50   |
| 11      | QH051-02 | Arm Lever Screw         | .25   | 40      | QH086-01 | Silent Cam             | .40   |
| 12      | QH007-01 | Arm Lever               | .50   | 41      | QH012-01 | Drive Gear             | .85   |
| 13      | AQ108-04 | Line Slider Screw       | .31   | 42      | QH104-01 | Oscillator Cam         | 1.00  |
| 14      | GU077-09 | Cover Screw             | .35   | 43      | QH026-01 | Drive Gear Adj. Washer | .30   |
| 15      | QH087-01 | Bail Spring Cover       | .45   | 44      | QH027-01 | Gear Shaft Bushing     | .50   |
| 16      | QH022-01 | Bail Spring             | .35   | 45      | QH023-03 | Body Cover             | 1.60  |
| 17      | QH006-01 | Rotor Nut               | .50   | 46      | GU057-01 | Body Cover Screw       | .15   |
| 18      | QH065-01 | Rotor Washer            | .25   | 47      | QH318-01 | Handle Assembly        | 2.25  |
| 19      | QH030-01 | Spool Adjustment Washer | .25   |         |          |                        |       |
| 20      | QH037-01 | Click Gear              | .40   |         |          |                        |       |
| 21      | QH009-04 | Rotor                   | 1.60  |         |          |                        |       |
| 22      | QH019-01 | Kick Lever              | .40   |         |          |                        |       |
| 23      | QH024-01 | Kick Lever Cover        | .45   |         |          |                        |       |
| 24      | QH015-01 | Main Shaft              | 1.15  |         |          |                        |       |
| 25      | AQ028-02 | Pinion Ball Bearing     | 6.28  |         |          |                        |       |
| 26      | QH060-01 | Ratchet Gear            | .80   |         |          |                        |       |
| 27      | QH011-01 | Pinion Gear             | 2.85  |         |          |                        |       |
| 28      | QH025-01 | Oscillator Slider       | .50   |         |          |                        |       |
| 29      | QH100-01 | Main Shaft Screw        | .25   |         |          |                        |       |

|                              |   |                         |
|------------------------------|---|-------------------------|
| <b>MODEL INTRODUCED</b> 1998 | <b>EFFECTIVE DATE OF PARTS LIST/DIAGRAM</b> Feb. 1998 | <b>DISCONTINUED</b> N/A |
|------------------------------|---|-------------------------|

Prices subject to change without notice. Prices do not include postage and handling.

**PLEASE ORDER BY PART NUMBER** Zebco Division Brunswick Corporation, Box 270, Tulsa, OK 74101 USA 918-836-5581

