

QUANTUM QLZ3 (WalMart Exclusive)

SPECIFICATIONS:

Med. Lt. FW
 160 yds / 8 lb Line
 4.0:1 Gear Ratio
 Retrieve Rate : 23.8" per turn
 Weight - 12.4 oz.
 4 Ball Bearing

FEATURES:

SnapShot Casting System
 Aluminum Pop Off Spool
 R / L Hand Retrieve
 Balanced Handle
 Rear Drag

Twist Reducing Ball Bearing Line Roller
 3-way Silent Anti-Reverse (on/off/ self-centering)
 Color: Med. Grey

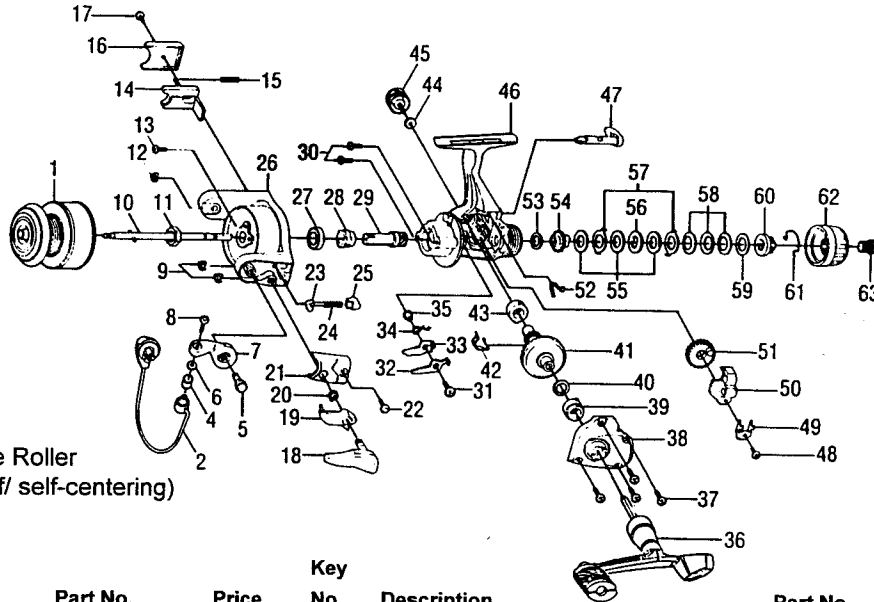

Key			Key				
No.	Description	Part No.	Price	No.	Description	Part No.	Price
1	SPOOL ASSEMBLY	JH321-42	6.23	33	ANTI-REVERSE PAWL "B"	JU074-01	1.01
2	BAIL ASSEMBLY	JU347-51	5.94	34	ANTI-REVERSE PAWL SPRING	JU061-01	1.06
4	LINE ROLLER BALL BEARING	BH004-14	4.14	35	ANTI-REVERSE PAWL POST	GU091-02	.74
5	ARM LEVER PIN	GU051-03	1.06	36	HANDLE ASSEMBLY	JH318-16	5.67
6	LINE ROLLER WASHER	GU105-07	.15	37	BODY COVER SCREW	JU057-04	.64
7	ARM LEVER	KU007-01	1.75	38	BODY COVER	KH023-10	2.83
8	LINE SLIDER SCREW	KQ108-01	.32	39	GEAR SHAFT BEARING	AQ028-02	6.28
9	E-CLIP	KQ034-01	.15	40	ADJUSTMENT WASHER	GU105-13	.66
10	MAIN SHAFT ASSEMBLY	JU315-01	1.85	41	DRIVE GEAR	JU012-02	3.55
11	ROTOR NUT	GU006-02	.84	42	SILENT CAM	JU086-01	1.16
12	E-CLIP	KQ034-01	.15	43	GEAR SHAFT BEARING	AQ028-02	6.28
13	ROTOR NUT LOCK SCREW	GU077-08	.15	44	HANDLE SCREW WASHER	GU105-01	0.10
14	KICK LEVER	JU019-01	1.06	45	HANDLE SCREW	GH073-05	.62
15	KICK LEVER SPRING	KQ049-06	.26	46	BODY	KH001-10	2.68
16	KICK LEVER COVER	JU046-04	.26	47	ANTI-REVERSE LEVER	KH090-03	1.49
17	KICK LEVER COVER SCREW	GU077-02	.15	48	OSCILLATOR RETAINER SCREW	JU100-01	.27
18	TRIGGER ASSEMBLY	GU115-08	3.72	49	OSCILLATOR SLIDE RETAINER	JU078-01	.32
19	TRIGGER LINK ASSEMBLY	GU097-06	1.75	50	OSCILLATOR SLIDER	JU025-01	1.85
20	TRIGGER SPRING	NL096-01	.84	51	OSCILLATOR GEAR	JU053-01	1.85
21	ARM LEVER SPRING COVER	JU087-04	.82	52	ANTI-REVERSE LEVER SPRING	GU089-01	.54
22	ARM LEVER COVER SCREW	GU077-02	.15	53	DRAG FRICTION WASHER	GU105-32	.79
23	ARM LEVER SPRING PIN	NL031-01	.27	54	DRAG CLICK GEAR	JU075-01	1.33
24	ARM LEVER SPRING	KQ049-02	.91	55	DRAG WASHER "B"	GU105-33	.91
25	ARM LEVER SPRING HOLDER	QL020-01	.32	56	DRAG WASHER "D"	JU080-01	1.06
26	ROTOR	JU009-22	3.81	57	DRAG WASHER "A"	JU081-01	1.06
27	BALL BEARING	AQ028-06	6.47	58	DRAG SPRING	JU043-01	1.38
28	ANTI-REVERSE RATCHET	JU060-01	2.49	59	DRAG WASHER	GU105-19	.99
29	PINION GEAR	JU011-01	2.44	60	DRAG NUT	JU066-01	1.33
30	BEARING SCREW	JU077-01	.64	61	DRAG CLICK SPRING	JU083-01	1.97
31	ANTI-REVERSE PAWL SCREW	GU077-05	.15	62	DRAG KNOB ASSEMBLY	KU332-01	.77
32	ANTI-REVERSE PAWL "A"	JU063-01	1.01	63	DRAG KNOB SCREW	KH101-03	.62

MODEL INTRODUCED: 1998	EFFECTIVE DATE OF PARTS LIST/DIAGRAM: Aug '98	DISCONTINUED N/A
-------------------------------	--	-------------------------

Prices subject to change without notice. Prices do not include postage and handling.

PLEASE ORDER BY PART NUMBER

Zebco, P.O. Box 270, Tulsa, Ok. 74101; 918-831-6965 Phone or 800-FIXREEL (349-7335) FAX

