

BROWNING® SFS 10A

WARNING!!!

These parts are not interchangeable with previous model

SPECIFICATIONS:

Micro Light Fresh
 80 yds./4 lb. Line Capacity
 5.2:1 Ratio
 4.9 oz. Weight
 1 Ball Bearing

FEATURES:

Front Drag System
 Silent Anti-Reverse
 Right/Left Balanced Handle
 Internal Bail Trip
 Twist Reducing Line Roller
 Brass Pinion Gear
 Color: Black

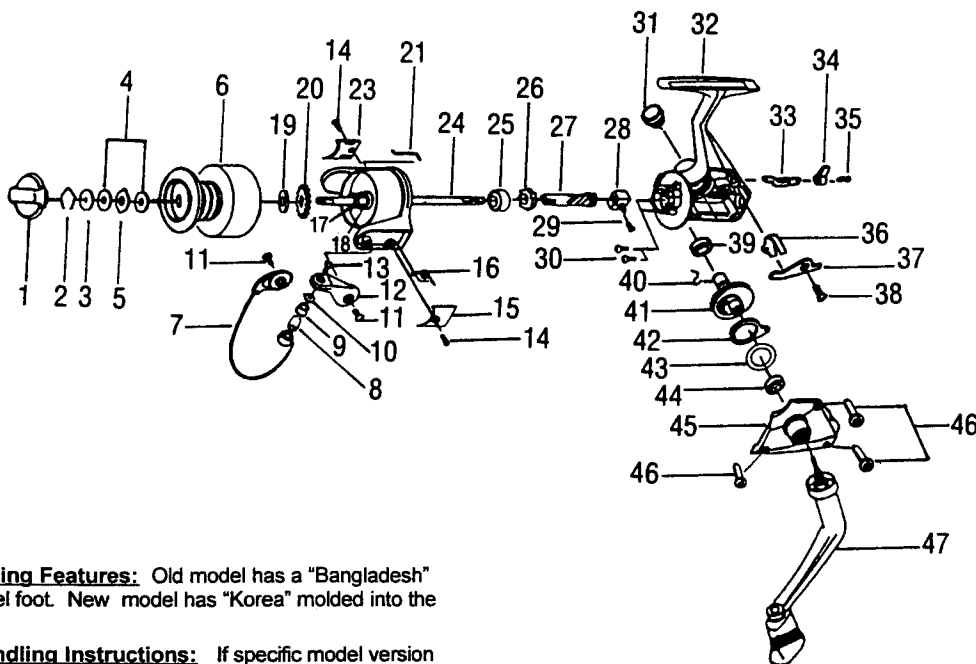

Distinguishing Features: Old model has a "Bangladesh" sticker on reel foot. New model has "Korea" molded into the reel foot.

Special Handling Instructions: If specific model version cannot be identified for parts order, send one of each part (for old and new model) and charge for one part.

| Key No. | Part No. | Description | Price | Key No. | Part No. | Description | Price |
|---------|----------|-------------------------|-------|---------|----------|-------------------------|-------|
| 1 | QH332-01 | Drag Knob Assembly | 1.60 | 29 | QH100-01 | Main Shaft Screw | .25 |
| 2 | QH038-01 | Drag Retainer | .40 | 30 | GU077-01 | Bearing Screw | .15 |
| 3 | QH080-01 | Drag Washer "D" | .45 | 31 | QH073-01 | Handle Screw Cap | .35 |
| 4 | QH033-01 | Drag Washer "B" | .70 | 32 | QH001-06 | Body | 2.60 |
| 5 | QH081-01 | Drag Washer "A" | .40 | 33 | QH059-01 | Anti-Reverse Cam | .70 |
| 6 | QH321-06 | Spool Assembly | 6.05 | 34 | QH090-01 | Anti-Reverse Lever | .40 |
| 7 | QH347-01 | Bail Assembly | 1.90 | 35 | QH135-02 | A/R Lever Screw | .25 |
| 8 | QH016-01 | Line Roller Bushing | .25 | 36 | QH089-01 | A/R Lever Spring | .25 |
| 9 | QH004-01 | Line Roller | .70 | 37 | QH063-01 | A/R Lever Pawl | .40 |
| 10 | GU105-07 | Line Roller Washer | .15 | 38 | QH077-01 | A/R Lever Pawl Screw | .25 |
| 11 | QH051-02 | Arm Lever Screw | .25 | 39 | QH027-01 | Gear Shaft Bushing | .50 |
| 12 | QH007-01 | Arm Lever | .50 | 40 | QH086-01 | Silent Cam | .40 |
| 13 | AQ108-04 | Line Slider Screw | .31 | 41 | QH012-01 | Drive Gear | .85 |
| 14 | GU077-09 | Cover Screw | .35 | 42 | QH104-01 | Oscillator Cam | 1.00 |
| 15 | QH087-01 | Bail Spring Cover | .45 | 43 | QH026-01 | Drive Gear Adj. Washer | .30 |
| 16 | QH022-01 | Bail Spring | .35 | 44 | QH027-01 | Gear Shaft Ball Bearing | .50 |
| 17 | QH006-01 | Rotor Nut | .50 | 45 | QH023-06 | Body Cover | 1.60 |
| 18 | QH065-01 | Rotor Washer | .25 | 46 | GU057-01 | Body Cover Screw | .15 |
| 19 | QH030-01 | Spool Adjustment Washer | .25 | 47 | QH318-01 | Handle Assembly | 2.90 |
| 20 | QH037-01 | Click Gear | .40 | | | | |
| 21 | QH009-06 | Rotor | 1.60 | | | | |
| 22 | QH019-01 | Kick Lever | .40 | | | | |
| 23 | QH024-01 | Kick Lever Cover | .45 | | | | |
| 24 | QH015-01 | Main Shaft | 1.15 | | | | |
| 25 | AQ028-02 | Pinion Ball Bearing | 6.28 | | | | |
| 26 | QH060-01 | Ratchet Gear | .80 | | | | |
| 27 | QH011-01 | Pinion Gear | 2.85 | | | | |
| 28 | QH025-01 | Oscillator Slider | .50 | | | | |

| | | | | | |
|-------------------------|------|---|-----------|---------------------|-----|
| MODEL INTRODUCED | 1998 | EFFECTIVE DATE OF PARTS LIST/DIAGRAM | Feb. 1998 | DISCONTINUED | N/A |
|-------------------------|------|---|-----------|---------------------|-----|

Prices subject to change without notice. Prices do not include postage and handling.

PLEASE ORDER BY PART NUMBER Zebco Division Brunswick Corporation, Box 270, Tulsa, OK 74101 USA 918-831-6965

