

QUANTUM

SR3B

WARNING!!!

These parts are not interchangeable with previous model

SPECIFICATIONS:

- Med. Light Freshwater
- 160 yds./48 lb. Line Capacity
- Rear Drag
- 4.1:1 Ratio
- 11.0 oz. Weight
- 1 Ball Bearing

FEATURES:

- Light Weight Graphite Construction
- Three-Way Silent (On/Off/Self-Centering) Anti-Reverse
- Right/Left Balanced Handle
- Internal Bail Trip
- Twist Reducing Ball Bearing Line Roller
- Pop-Off Spool
- Snapshot Trigger
- Color: Black

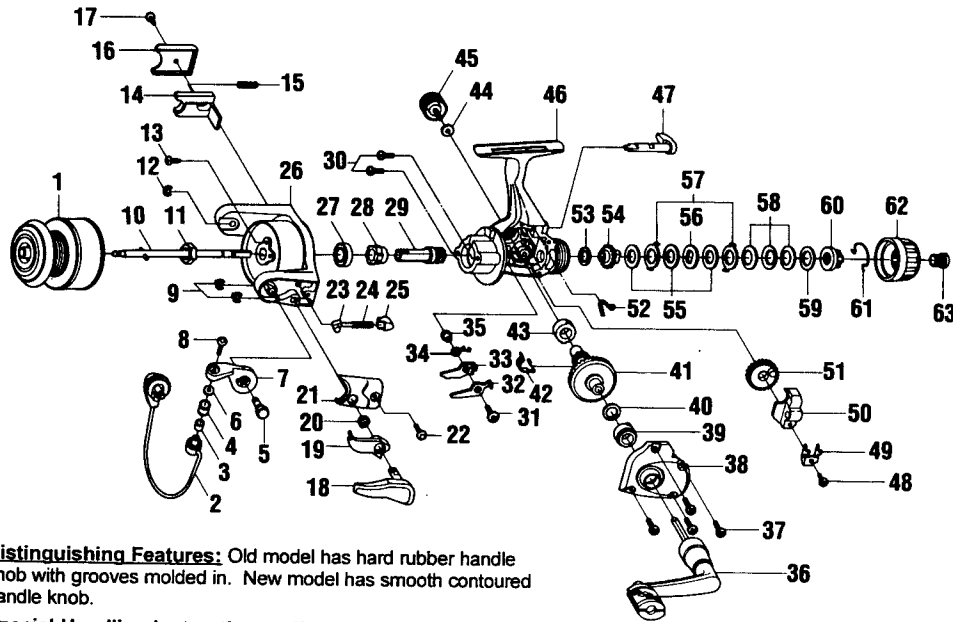

Distinguishing Features: Old model has hard rubber handle knob with grooves molded in. New model has smooth contoured handle knob.

Special Handling Instructions: If specific model version cannot be identified for parts order, send one of each part (for old and new model) and charge for one part.

Key No.	Part No.	Description	Price	Key No.	Part No.	Description	Price
1	JU321-55	Spool Assembly	6.00	33	JU074-01	Anti-Reverse Pawl "B"	1.01
2	JU347-52	Bail Assembly	6.31	34	JU061-01	Anti-Reverse Pawl Spring	1.06
3	MT016-01	Line Roller Bushing	.77	35	GU091-02	Anti-Reverse Pawl Post	.74
4	KH004-02	Line Roller	1.24	36	KU318-01	Handle Assembly	5.46
5	HU051-03	Arm Lever Pin	.59	37	JU057-04	Body Cover Screw	.64
6	GU105-07	Line Roller Washer	.15	38	KH323-14	Body Cover Assembly	2.42
7	KU007-02	Arm Lever	1.75	39	JU027-01	Gear Shaft Bushing	1.65
8	AQ108-04	Line Slider Screw	.31	40	GU105-13	Adjustment Washer	.66
9	KQ034-01	E-Clip	.15	41	JU012-02	Drive Gear	3.55
10	JU315-01	Main Shaft Assembly	1.89	42	JU086-01	Silent Cam	1.16
11	RU006-01	Rotor Nut	.93	43	JU027-01	Gear Shaft Bushing	1.65
12	KQ034-01	E-Clip	.15	44	GU105-01	Handle Screw Washer	.10
13	GU077-08	Rotor Nut Lock Screw	.15	45	XU073-01	Handle Screw	.64
14	JU019-01	Kick Lever	1.06	46	KH001-14	Body	4.17
15	KQ049-04	Kick Lever Spring	.32	47	KH090-01	Anti-Reverse Lever	1.53
16	JU046-01	Kick Lever Cover	.79	48	JU100-01	Oscillator Retainer Screw	.27
17	GU077-02	Kick Lever Cover Screw	.15	49	JU078-01	Oscillator Slide Retainer	.32
18	HU312-01	Trigger Assembly	3.72	50	JU025-01	Oscillator Slider	1.85
19	HU398-01	Trigger Link Assembly	1.75	51	JU053-01	Oscillator Gear	1.85
20	NL096-01	Trigger Spring	.84	52	GU089-01	Anti-Reverse Lever Spring	.54
21	JU087-61	Arm Lever Spring Cover	.90	53	GU105-32	Drag Friction Washer	.79
22	GU077-02	Arm Lever Cover Screw	.15	54	JU075-01	Drag Click Gear	1.33
23	NL031-01	Arm Lever Spring Pin	.27	55	GU105-33	Drag Washer "B"	.91
24	KQ049-02	Arm Lever Spring	.91	56	JU080-01	Drag Washer "D"	1.06
25	QL020-01	Arm Lever Spring Holder	.32	57	JU081-01	Drag Washer "A"	1.06
26	JU009-02	Rotor	3.45	58	JU043-01	Drag Spring	1.38
27	AQ028-06	Ball Bearing	6.47	59	GU105-19	Drag Washer	.99
28	JU060-01	Anti-Reverse Ratchet	2.49	60	JU066-01	Drag Nut	1.33
29	JU011-01	Pinion Gear	2.44	61	JU083-01	Drag Click Spring	1.97
30	JU077-01	Bearing Screw	.64	62	KU032-02	Drag Knob	1.60
31	GU077-16	Anti-Reverse Pawl Screw	.15	63	KH101-01	Drag Knob Screw	1.33
32	JU063-01	Anti-Reverse Pawl "A"	1.01				

MODEL INTRODUCED	August 1, 1998	EFFECTIVE DATE OF PARTS LIST/DIAGRAM	August 1, 1998	DISCONTINUED	N/A
-------------------------	----------------	---	----------------	---------------------	-----

Prices subject to change without notice. Prices do not include postage and handling.

PLEASE ORDER BY PART NUMBER Zebco Division Brunswick Corporation, Box 270, Tulsa, OK 74101 USA 918-831-6965

