

# QUANTUM<sup>®</sup> SR4B

**WARNING!!!**  
These parts are not interchangeable with previous model

**SPECIFICATIONS:**

Medium Freshwater  
180 yds./10 lb. Line Capacity  
Rear Drag  
4.1:1 Ratio  
12.0 oz. Weight  
1 Ball Bearing

**FEATURES:**

Light Weight Graphite Construction  
Three-Way Silent (On/Off/Self-Centering) Anti-Reverse  
Right/Left Balanced Handle  
Internal Bail Trip  
Twist Reducing Ball Bearing Line Roller  
Pop-Off Spool  
Snapshot Trigger  
Color: Black

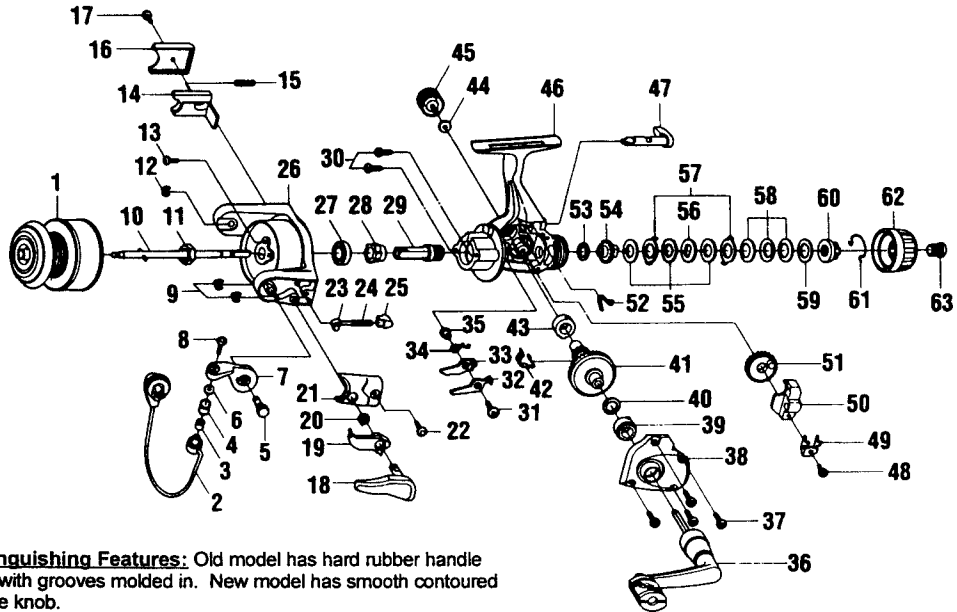

**Distinguishing Features:** Old model has hard rubber handle knob with grooves molded in. New model has smooth contoured handle knob.

**Special Handling Instructions:** If specific model version cannot be identified for parts order, send one of each part (for old and new model) and charge for one part.

Key No.	Part No.	Description	Price	Key No.	Part No.	Description	Price
1	JU321-56	Spool Assembly	6.00	33	JU074-01	Anti-Reverse Pawl "B"	1.01
2	KU347-52	Bail Assembly	6.31	34	JU061-01	Anti-Reverse Pawl Spring	1.06
3	MT016-01	Line Roller Bushing	.77	35	GU091-02	Anti-Reverse Pawl Post	.74
4	KH004-02	Line Roller	1.24	36	KU318-01	Handle Assembly	5.46
5	HU051-03	Arm Lever Pin	.59	37	JU057-04	Body Cover Screw	.64
6	GU105-07	Line Roller Washer	.15	38	LH323-13	Body Cover Assembly	2.42
7	KU007-02	Arm Lever	1.75	39	JU027-01	Gear Shaft Bushing	1.65
8	AQ108-04	Line Slider Screw	.31	40	GU105-13	Adjustment Washer	.66
9	KQ034-01	E-Clip	.15	41	JU012-02	Drive Gear	3.55
10	JU315-03	Main Shaft Assembly	2.07	42	JU086-01	Silent Cam	1.16
11	RU006-01	Rotor Nut	.93	43	JU027-01	Gear Shaft Bushing	1.65
12	KQ034-01	E-Clip	.15	44	GU105-01	Handle Screw Washer	.10
13	GU077-08	Rotor Nut Lock Screw	.15	45	XU073-01	Handle Screw	.64
14	KU019-01	Kick Lever	1.16	46	LH001-13	Body	4.17
15	KQ049-04	Kick Lever Spring	.32	47	KH090-01	Anti-Reverse Lever	1.53
16	KU046-01	Kick Lever Cover	.84	48	JU100-01	Oscillator Retainer Screw	.27
17	GU077-02	Kick Lever Cover Screw	.15	49	JU078-01	Oscillator Slide Retainer	.32
18	HU312-01	Trigger Assembly	3.72	50	KU025-01	Oscillator Slider	2.07
19	HU398-01	Trigger Link Assembly	1.75	51	KU053-01	Oscillator Gear	2.07
20	NL096-01	Trigger Spring	.84	52	GU089-01	Anti-Reverse Lever Spring	.54
21	KU087-61	Arm Lever Spring Cover	.90	53	GU105-32	Drag Friction Washer	.79
22	GU077-02	Arm Lever Cover Screw	.15	54	KU075-01	Drag Click Gear	1.48
23	NL031-01	Arm Lever Spring Pin	.27	55	GU105-33	Drag Washer "B"	.91
24	KQ049-02	Arm Lever Spring	.91	56	JU080-01	Drag Washer "D"	1.06
25	QL020-01	Arm Lever Spring Holder	.32	57	JU081-01	Drag Washer "A"	1.06
26	KJ009-02	Rotor	3.45	58	JU043-01	Drag Spring	1.38
27	AQ028-06	Ball Bearing	6.47	59	GU105-19	Drag Washer	.99
28	JU060-01	Anti-Reverse Ratchet	2.49	60	JU066-01	Drag Nut	1.33
29	JU011-01	Pinion Gear	2.44	61	JU083-01	Drag Click Spring	1.97
30	JU077-01	Bearing Scrw	.64	62	KU032-02	Drag Knob	1.60
31	GU077-16	Anti-Reverse Pawl Screw	.15	63	KH101-01	Drag Knob Screw	1.33
32	JU063-01	Anti-Reverse Pawl "A"	1.01				

<b>MODEL INTRODUCED</b>	August 1, 1998	<b>EFFECTIVE DATE OF PARTS LIST/DIAGRAM</b>	August 1, 1998	<b>DISCONTINUED</b>	N/A
-------------------------	----------------	---	----------------	---------------------	-----

Prices subject to change without notice. Prices do not include postage and handling.

**PLEASE ORDER BY PART NUMBER** Zebco Division Brunswick Corporation, Box 270, Tulsa, OK 74101 USA 918-831-6965

