

QUANTUM SS2D / SS3D / SS4D

SPECIFICATIONS :

Application:

- SS2D - Lt. FW
- SS3D - Med. FW
- SS4D - Hvy FW

5.2:1 Gear Ratio

Line Capacity:

- SS2D - 140 yds / 6 lb
- SS3D - 160 yds / 8 lb
- SS4D - 180 yds / 10 lb

Retrieve Rate (Inches Per Turn):

- SS2D - 24.5"
- SS3D - 30.2"
- SS4D - 34.1"

Weight:

- SS2D - 8.7 oz.
- SS3D - 11.1 oz.
- SS4D - 12.7 oz.

1 Ball Bearing

FEATURES :

- Rear Drag
- Tru-Balanced Rotor
- Standard Handle
- Oversized Twist Reducer Line Roller
- Selective On/Off (1 Stop-Self Center) A/R
- Aluminum Spool
- Geared (S-Curve) O/S System
- Color:

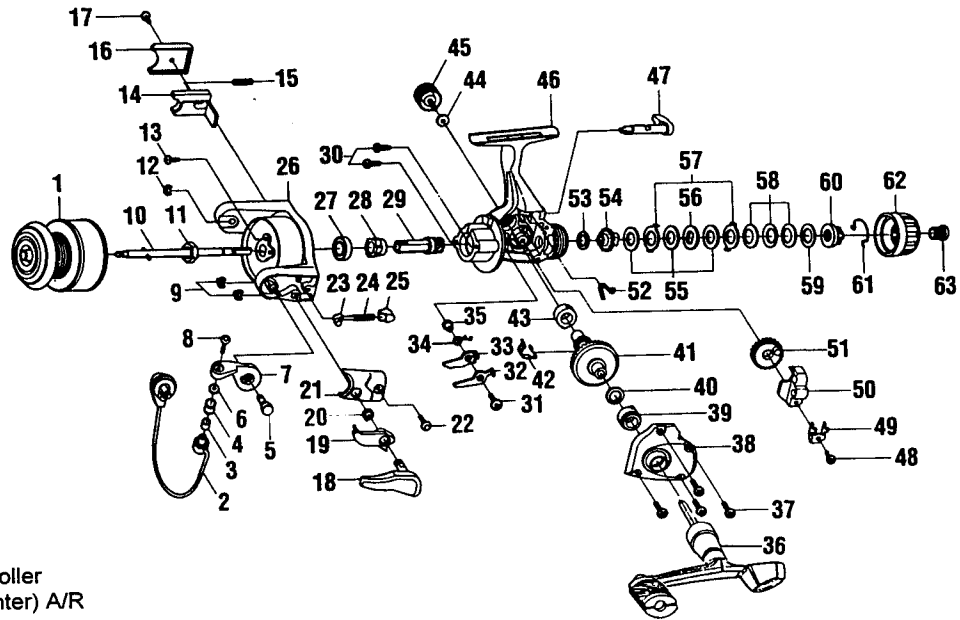

Key No.	SS2D	Part No. SS3D	SS4D	Description	Price	Key No.	SS2D	Part No. SS3D	SS4D	Description	Price
1	JH321-47	JH321-48	JH321-49	Spool Assy.		33	GU074-01	JU074-01	←	Anti-Rev. Pawl "B"	
2	HU347-62	JU347-62	KU347-62	Bail Assy.		34	GU061-01	JU061-01	←	A/R Pawl Spring	
3	MT016-01	←	←	Line Roller Bushing		35	GU091-01	GU091-02	←	Anti-Rev. Pawl Post	
4	KH004-02	←	←	Line Roller		36	HU318-03	KU318-03	←	Handle Assy.	
5	HU051-04	←	←	Arm Lever Pin		37	GU057-02	JU057-03	←	Body Cover Screw	
6	GU105-07	←	←	Line Roller Washer		38	JH323-17	KH323-18	LH323-16	Body Cover Assy	
7	KU007-01	←	←	Arm Lever		39	GU027-01	JU027-01	←	Gear Shaft Bushing	
8	AQ108-03	←	←	Line Slider Screw		40	GU105-08	GU105-13	←	Adjustment Washer	
9	KQ034-01	←	←	E-Clip		41	GU012-01	JU012-02	←	Drive Gear	
10	JU315-02	JU315-01	JU315-03	Main Shaft		42	GU086-01	JU086-01	←	Silent Cam	
11	GU006-01	RU006-01	RU006-01	Rotor Nut		43	GU027-01	←	←	Gear Shaft Bushing	
12	KQ034-01	←	←	E-Clip		44	GU105-01	←	←	Handle Cap Washer	
13	GU077-08	←	←	Rotor Nut Lck. Scrw.		45	XU073-03	←	←	Handle Cap Screw	
14	HU019-01	JU019-01	KU019-01	Kick Lever		46	JH001-17	KH001-18	LH001-16	Body Assy.	
15	KQ049-04	←	←	Kick Lever Spring		47	KH090-03	←	←	Anti-Reverse Lever	
16	HU046-06	JU046-05	KU046-04	Kick Lever Cover		48	JU100-01	←	←	Oscillator Retainer	
17	GU077-03	←	←	Kick Lvr Cvr Screw		49	HU078-01	JU078-01	←	O/S Slide Retainer	
18	HU312-02	←	←	Trigger		50	HU025-01	JU025-01	KU025-01	Oscillator Slider	
19	HU398-02	←	←	Trigger Link Assy.		51	HU053-01	JU053-01	KU053-01	Oscillator Gear	
20	NL096-01	←	←	Trigger Spring		52	GU089-01	←	←	Anti-Rev. Lvr Spring	
21	HU087-62	JU087-62	KU087-62	Arm Lvr Spring Cvr		53	GU105-34	GU105-32	←	Drag Friction Washer	
22	GU077-03	←	←	Cover Screw		54	HU075-01	JU075-01	KU075-01	Drag Click Gear	
23	KQ031-01	NL031-01	←	Arm Lever Spring Pin		55	GU105-35	GU105-33	←	Drag Washer "B"	
24	KQ049-05	KQ049-02	←	Arm Lever Spring		56	HU080-01	JU080-01	←	Drag Washer "D"	
25	QL020-01	←	←	Arm Lvr Spring Holder		57	HU081-01	JU081-01	←	Drag Washer "A"	
26	HU009-05	JU009-05	KJ009-05	Rotor		58	HU043-01	JU043-01	←	Drag Spring	
27	AQ028-01	AQ028-06	←	Ball Bearing		59	GU105-24	GU105-19	←	Drag Washer	
28	HU060-01	JU060-01	←	Anti-Rev. Ratchet		60	HU066-01	JU066-01	←	Drag Nut	
29	GU011-02	JU011-01	←	Pinion Gear		61	HU070-01	JU083-01	←	Drag Click Spring	
30	GU077-01	JU077-01	←	Bearing Screw		62	MU032-01	KU032-01	←	Drag Knob Assy.	
31	GU077-05	GU077-16	←	Anti-Rev. Pawl "A"		63	JH101-03	KH101-03	←	Drag Knob Screw	
32	GU063-01	JU063-01	←	Anti-Rev. Pawl "A"							

MODEL	EFFECTIVE DATE OF
INTRODUCED : 1998	PARTS LIST/DIAGRAM: Sept. '98
DISCONTINUED : N/A	

Prices subject to change without notice.
PLEASE ORDER BY PART NUMBER

Zebco, P.O. Box 270, Tulsa, Ok. 74101; 918-831-6965 Phone or 800-FIXREEL (349-7335) FAX
Prices do not include postage and handling.

