



ZS2

WARNING!!!

These parts are not interchangeable with new model

SPECIFICATIONS:

- Light Freshwater
- 140 yds/6 lb. Line Capacity
- Rear Drag
- 4.4:1 Ratio
- 7.9 oz. Weight

FEATURES:

- Three-Way Silent (On/Off/Self) Anti-Reverse
- Right/Left Interchangeable Handle
- Internal Bail Trip
- Rotating Line Roller
- Rugged Brass Pinion Gear

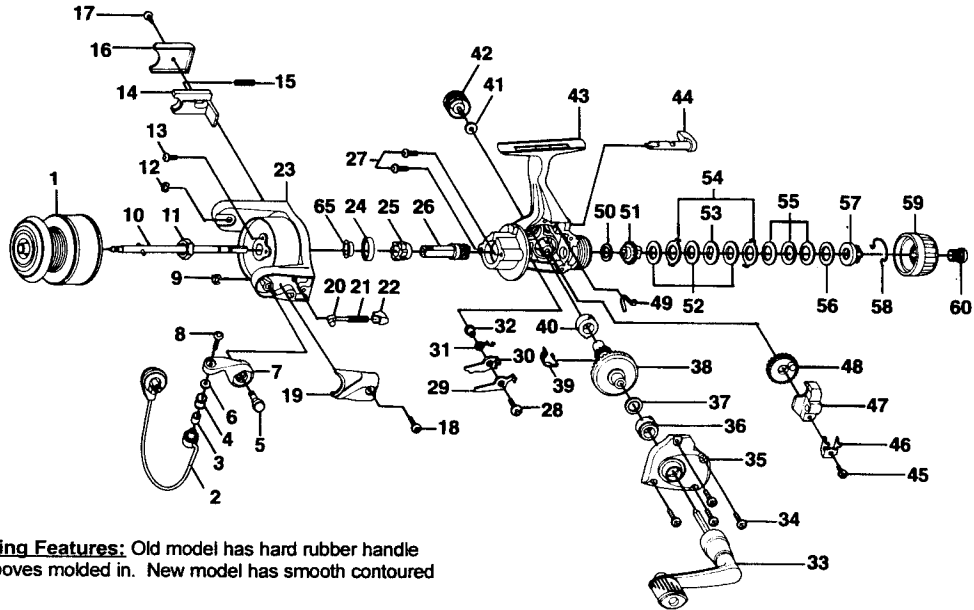

Distinguishing Features: Old model has hard rubber handle knob with grooves molded in. New model has smooth contoured handle knob.

Special Handling Instructions: If specific model version cannot be identified for parts order, send one of each part (for old and new model) and charge for one part.

Key No.	Part No.	Description	Price	Key No.	Part No.	Description	Price
1	JU321-41	Spool Assembly	4.45	32	GU091-01	Anti-Reverse Pawl Post	.26
2	GU347-06	Bail Assembly	4.38	33	GU318-44	Handle Assembly	2.25
3	MT016-02	Line Roller Bushing	.77	34	GU057-01	Body Cover Screw	.15
4	MT004-01	Line Roller	1.24	35	HU023-14	Body Cover	2.70
5	GU051-04	Arm Lever Pin	.57	36	GU027-01	Gear Shaft Bushing	.82
6	GU105-07	Line Roller Washer	.15	37	GU105-08	Adjustment Washer	.15
7	NU007-01	Arm Lever	.93	38	GU012-01	Drive Gear	2.88
8	KQ108-01	Line Slider Screw	.31	39	GU086-01	Silent Cam	.41
9	KQ034-01	E-Clip	.15	40	GU027-01	Gear Shaft Bushing	.82
10	JU315-02	Main Shaft Assembly	1.03	41	GU105-01	Handle Cap Washer	.10
11	GU006-01	Rotor Nut	.31	42	GU073-01	Handle Cap Screw	.62
12	KQ034-01	E-Clip	.15	43	HU001-14	Body	2.60
13	GU077-04	Rotor Nut Lock Screw	.15	44	GU090-01	Anti-Reverse Lever	1.49
14	HU019-01	Kick Lever	.52	45	JU100-01	Oscillator Retainer Screw	.26
15	KQ049-04	Kick Lever Spring	.31	46	HU078-01	Oscillator Slide Retainer	.26
16	HU046-01	Kick Lever Cover	.26	47	HU025-01	Oscillator Slider	1.03
17	GU077-02	Kick Lever Cover Screw	.15	48	HU053-01	Oscillator Gear	1.03
18	GU077-02	Arm Lever Cover Screw	.15	49	GU089-01	Anti-Reverse Lever Spring	.52
19	MU087-01	Arm Lever Spring Cover	.26	50	GU105-34	Drag Friction Washer	.79
20	NL031-01	Arm Lever Spring Pin	.26	51	HU075-01	Drag Click Gear	.62
21	KQ049-05	Arm Lever Spring	.31	52	GU105-35	Drag Washer "B"	.91
22	QL020-01	Arm Lever Spring Holder	.31	53	HU080-01	Drag Washer "D"	.52
23	HU009-15	Rotor	4.45	54	HU081-01	Drag Washer "A"	.52
24	GU028-01	Pinion Bushing	.70	55	HU043-01	Drag Spring	.67
25	HU060-01	Anti-Reverse Ratchet	2.06	56	GU105-24	Drag Washer	.91
26	GU011-02	Pinion Gear	2.01	57	HU066-01	Drag Nut	.62
27	GU077-01	Bearing Screw	.15	58	HU070-01	Drag Retainer Clip	1.13
28	GU077-05	Anti-Reverse Pawl Screw	.15	59	HU032-01	Drag Knob	.77
29	GU063-01	Anti-Reverse Pawl "A" (Cntr)	.46	60	HU101-01	Drag Knob Screw	.62
30	GU074-01	Anti-Reverse Pawl "B" (On)	.46	65	GU110-01	Pinion Collar	.45
31	GU061-01	Anti-Reverse Pawl Spring	.36				

MODEL INTRODUCED	1997	EFFECTIVE DATE OF PARTS LIST/DIAGRAM	Oct. 1996	DISCONTINUED	N/A
-------------------------	------	---	-----------	---------------------	-----

Prices subject to change without notice. Prices do not include postage and handling.

PLEASE ORDER BY PART NUMBER Zebco Division Brunswick Corporation, Box 270, Tulsa, OK 74101 USA 918-831-6965

