

STS3000

SPECIFICATIONS:

Medium/Light Freshwater
 Line Capacity: 160 yds. / 8 lb.
 Gear Ratio: 4.1:1
 Weight: 11.1 oz.
 2 Ball Bearings

FEATURES:

Rear Drag
 Three Way Selective Anti-Reverse
 Aluminum Long Stroke Spool
 Right/Left Hand Retrieve
 Balanced Handle and Rotor

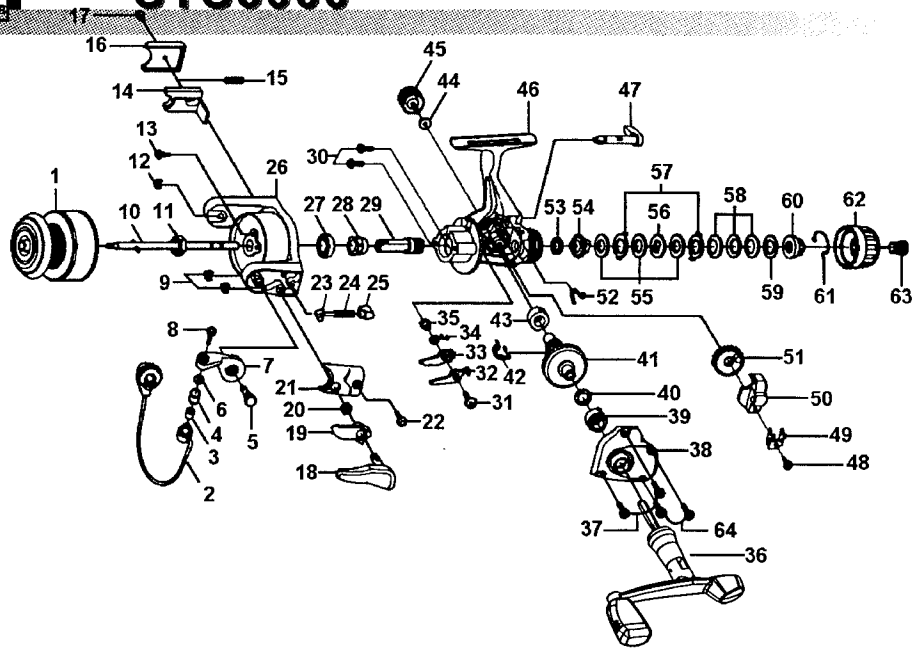

KEY PART NO.	NUMBER	DESCRIPTION	KEY PART NO.	NUMBER	DESCRIPTION
1	KH321-01	SPOOL ASSEMBLY	33	JU074-01	ANTI-REVERSE PAWL "B" (ON)
2	JU347-63	BAIL ASSEMBLY	34	JU061-01	ANTI-REVERSE PAWL SPRING
3	MT016-01	LINE ROLLER BUSHING	35	GU091-02	ANTI-REVERSE PAWL POST
4	KH004-02	LINE ROLLER	36	JH318-23	HANDLE ASSEMBLY
5	HU051-03	ARM LEVER PIN	37	JU057-03	BODY COVER SCREW
6	GU105-07	LINE ROLLER WASHER	38	KH323-20	BODY COVER ASSEMBLY
7	KU007-01	ARM LEVER	39	AQ028-02	GEAR SHAFT BEARING
8	AQ108-04	LINE SLIDER SCREW	40	GU105-13	ADJUSTMENT WASHER
9	KQ034-01	E-CLIP	41	JU012-02	DRIVE GEAR
10	JU315-01	MAIN SHAFT ASSEMBLY	42	JU086-01	SILENT CAM
11	RU006-01	ROTOR NUT	43	JU027-01	GEAR SHAFT BUSHING
12	KQ034-01	E-CLIP	44	GU105-01	HANDLE SCREW WASHER
13	GU077-04	ROTOR NUT LOCK SCREW	45	XU073-04	HANDLE SCREW
14	JU019-01	KICK LEVER	46	KH001-19	BODY
15	KQ049-06	KICK LEVER SPRING	47	KH090-03	ANTI-REVERSE LEVER
16	JU046-05	KICK LEVER COVER	48	JU100-01	OSCILLATOR RETAINER SCREW
17	GU077-02	KICK LEVER COVER SCREW	49	JU078-01	OSCILLATOR SLIDE RETAINER
18	HU312-03	TRIGGER ASSEMBLY	50	JU025-01	OSCILLATOR SLIDER
19	HU098-02	TRIGGER LINK	51	JU053-01	OSCILLATOR GEAR
20	NL096-01	TRIGGER SPRING	52	GU089-01	ANTI-REVERSE LEVER SPRING
21	JU087-62	ARM LEVER SPRING COVER	53	GU105-32	DRAG FRICTION WASHER 'A'
22	GU077-02	ARM LEVER COVER SCREW	54	JU075-01	DRAG CLICK GEAR
23	NL031-01	ARM LEVER SPRING SHAFT	55	GU105-33	DRAG DISC
24	KQ049-02	ARM LEVER SPRING	56	JU080-01	DRAG WASHER 'D'
25	QL020-01	ARM LEVER SPRING HOLDER	57	JU081-01	DRAG WASHER KEYED
26	JU009-10	ROTOR	58	JU043-01	DRAG SPRING
27	AQ028-06	BALL BEARING	59	GU105-19	DRAG WASHER
28	JU060-01	ANTI-REVERSE RATCHET	60	LH066-01	DRAG NUT
29	JU011-01	PINION GEAR	61	LH083-01	DRAG CLICK SPRING
30	JU077-01	BEARING SCREW	62	LH332-01	DRAG KNOB ASSEMBLY
31	GU077-16	ANTI-REVERSE PAWL SCREW	63	KH101-03	DRAG KNOB SCREW
32	JU063-01	ANTI-REVERSE PAWL "A" (CNTR)	64	GU057-02	BODY COVER SCREW

Please call for parts pricing and availability.

PLEASE ORDER BY PART NUMBER